

## 选型指南 Guide for Model Selection

- 我公司永磁起重器产品系列众多，针对性较强，请您按以下选型指南对照选型。
- We have many series for these permanent products; please choose the right type as per the guide.**
- 当被吸物为钢板时，所有系列均适用。但各个系列各有所长，**YX1**系列适用吊运小型板料，手动卸料；**YX2**系列吊运短而厚的钢板，自动卸料；**YX3**系列适用于吊运长而薄的钢板，手动卸料；**YX4**系列适用范围广，自动卸料，但禁止空载运行；**YX5**系列吊运重而厚的钢板，但要求提供电源。
- All series are suitable for steel plate, but each series has his advantage, Series YX1 is used for small size and manual discharging; Series YX2 is for short and thick size and; Series YX3 is for long and thin steel size and manual discharging; Series YX4 has wide application rage and auto discharging, but not allowed to be transported without load; Series YX5 is for thick and heavy size and need power supply.**
- 吊运单根圆形物料如圆钢、钢管等选用**YX1**系列，吊运多根圆形物料请选用**YX4**、**YX5**系列。
- Use Series YX1 for lifting and transporting single round material like round steel, steel tube, etc. Use Series YX4 and YX5 for lifting and transporting multi-pieces of round materials.**
- 要求自动卸料的请使用**YX2**、**YX4**、**YX5**系列。
- Use Series YX2, YX4 and YX5 for auto discharging.**
- 对于厚度小于**6mm**的薄钢板只能选用**YX1**、**YX4**、**YX5**系列。
- Use Series YX1, YX4 and YX5 for thin plate (thickness less than 6 mm).**
- 当采用多台联吊时，建议选用**YX3**、**YX4**、**YX5**系列，因为这几种系列能保证较好的同步性。
- Use Series YX3, YX4 and YX5 for multiple units, for they have good synchronism.**
- YX2**、**YX3**、**YX5**均有最小卸料尺寸的要求，选型及操作时注意被吸物是否满足要求。
- Series YX2, YX3 and YX5 have minimun dimension demand on material to be discharged. Therefore please take note of it.**
- YX5**系列能实现空中卸料。
- Series YX5 can discharge in the air.**
- 每种系列的永磁起重器均有起重能力的范围。
- Each series has it range of lifting capacity.**
- 若要求调整吸力、侧吊、吊运特殊物料诸如钢带卷、钢坯等情况复杂时宜与我公司技术部门探讨，根据您的特殊用途、特殊环境进行特殊设计，以便达到最佳效果。
- Your specific requirements like do some adjustment on attraction power, side hung or for some special materials including coiled steel, steel billet, etc., are supposed to let our technology department know at first. So that we can design it specially to reach the optimal effect**

## 型号说明 Model Designation

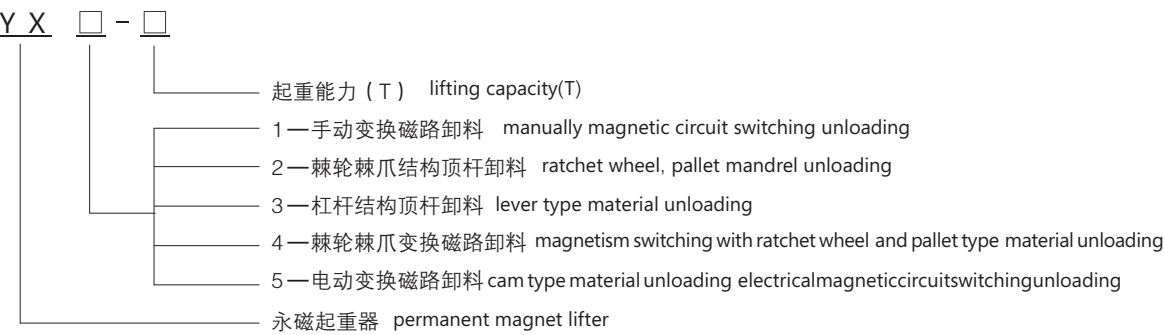

## YX1系列 Series YX1

### 概述 Brief

YX1系列永磁起重器是由强磁钕铁硼磁性材料组成的特殊磁路系统，它通过手柄的旋向，控制磁路开关。具有不需励磁电源，体积小，自重轻，吸持力大，操作方便，使用安全，磁力恒久不衰的特点。它广泛适用于工厂，码头，仓库，交通运输部门吊装搬运钢板、钢锭等导磁性物体。

Series YX1 (Permanent-magnet lifter) has special strong magnetic circuit made by Nd-Fe-B magnetic materials whose switch is controlled by turning handle. It has advantages of no using electricity, compact, light self-weight, huge attraction force, convenient and safe operation and permanent magnetic force and is used widely to lift and transport magnetic materials such as steel plates, steel ingot at factories, docks, warehouses and transportation.

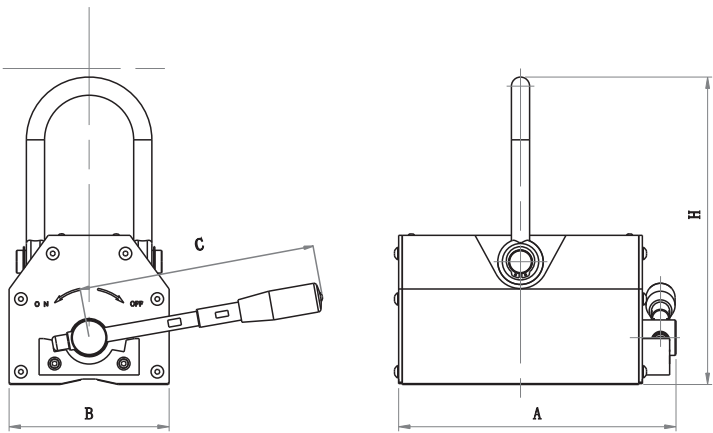

外形尺寸及安装示意图  
Overall Dimension & Installation Drawing



实物图  
Actual Picture

YX3系列 Series YX3

概述 Brief

YX3系列内部采用铁氧体磁性材料制作，它运用杠杆机构，人工可轻松抽动拉杆，完成吸、放料工作。具有不需励磁电源，操作方便，使用安全等特点。它广泛适用于工厂，码头，仓库，交通运输部门多台吊装搬运长而薄的钢板，杠杆式卸料机构能保证较好的同步性。特设气隙调整杆，可方便的调整磁力大小。但它在卸料状态下，工作底面仍带磁性。

Series YX3 which is made of ferrite adopts lever mechanism and can draw rod easily to absorb and discharge materials, featuring no electricity consumption, convenient and safe in operation. It is widely used for transporting long and thin steel plates in combined units at factory, dock, warehouse and transportation. Discharging mechanism equipped with lever has good synchronism. And magnetic force can be adjusted conveniently through air gas adjusting rod. Its working face still remain magnetis, during unloading process.

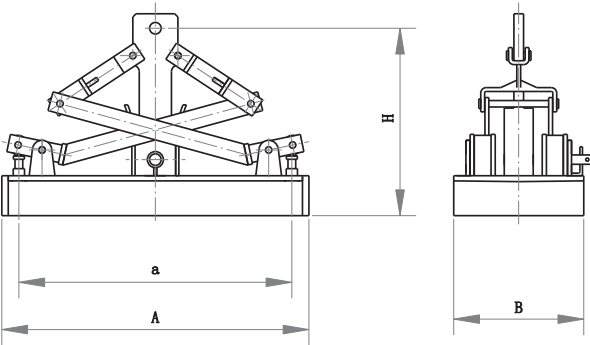

YX3系列外形尺寸图  
Overall Dimension Drawing



实物图  
Actual Picture

主要技术参数  
Main technical data

型 号 model	参 数 data	起重 能力 lifting capacity (kg)	最小卸 料能力 Min. discharging capacity (kg)	最小卸 料板厚 Min. thickness of discharging plate (mm)	最小吸料外形 长X宽 Min.dimension of attached material 长L X 宽W (mm)	外形尺寸 overall dimension (mm)				质量 mass (kg)
						A	a	B	H	
YX3-1		1000	100	5	824×256	824	586	256	570	240
YX3-2		2000	200	8	960×376	960	848	376	600	320
YX3-3		3000	360	12	960×406	960	848	406	680	420
YX3-5		5000	1200	16	1090×516	1088	848	516	548	650

YX4系列 Series YX4

概述 Brief

YX4系列是采用稀土高性能永磁材料精心设计而成，具有吸力大、体积小、高度节能、安装方便、安全可靠、使用寿命长、能自动完成卸料过程等特点，可广泛用于机械、化工、码头、船厂、钢结构厂等需要搬运低于100℃的导磁性钢坯、钢板、圆钢等场合。它能与行车起重机、汽车起重机等所有起重设备配套使用，既可单台使用，也可多台组合使用，是节约能源、减轻劳动强度、提高劳动生产率的理想吊具。



实物图 Actual Picture

Series YX4(Permanent-magnet lifter) which are made of the rare earth has advantages of powerful attraction force, compact, high energy-saving, convenient installation, reliable performance, long service life, and automatically discharging materials. It's widely been used for lifting and transporting magnetic materials less than 100℃ such as steel billet, steel plate, round steel and steel scraps in mechanical & chemical industry, docks, ship factories and steel factories. It is assistant equipment to all lifting device such as crane and auto lifter and can be put into operation with sigle unit or multiple units. It is an ideal lifter for saving energy, reducing labor tension and improving production rate.

工作原理 Woring principle

YX4系列由永磁铁和磁极组成若干单元磁路，每一个单元磁路的永磁铁可由传动机构带动在单元磁极内转动0~90°，整体形成开、闭磁路，达到吸、卸料的目的。

Series YX4 (Permanent-magnet lifter) is made of several magnetic circuit, each magnetic circuit can be rotated 0~90° inside each magnetic pole by actuating mechanism, to form open and close magnetic circuit as a whole for attracting or unloding materials.

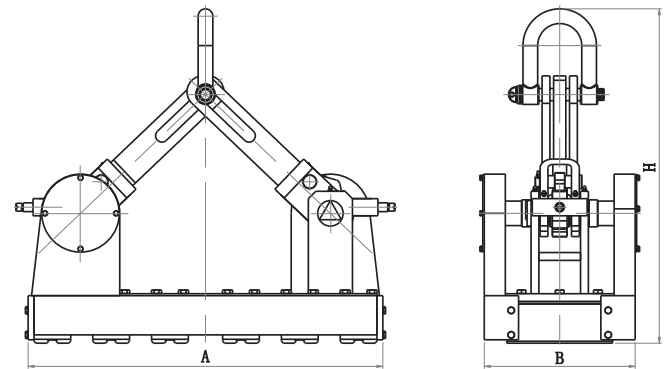

YX4系列外形尺寸图  
Overall Dimension Drawing

永磁起重器  
Permanent Magnet Lifter

特点 Features

1. 采用计算机模拟磁路设计，磁场分布合理，透磁深度大。  
Use computer to simulate magnetic circuit to get reasonable field distribution and deep penetration.
2. 在卸料状态下工作面不带磁。  
It has no magnetism during unloading process.
3. 不需励磁电源，不需冷却系统。  
No excitation power or cooling system is required.
4. 省电节能，故障率低。  
Energy-saving and low faults.
5. 操作简单，运行安全可靠。  
User-friendly operation; safe and reliable.

主要技术参数 Main technical data

型 号 model	额定起重能力 rated lifting capacity (kg)	圆柱形额定起重能力 rated lifting capacity of column type(kg)	最大拉脱力 max. pull force (kg)	外形尺寸 overall dimension (mm)				使用温度 working temperature (°C)	质量 mass (kg)
				A	B	C	H		
YX1-0.15	150	75	450	72	102	67	126	<80	6
YX1-0.2	200	100	600	82	112	77	135	<80	8
YX1-0.3	300	150	900	92	162	91	155	<80	10
YX1-0.5	500	250	1500	122	232	117	196	<80	22
YX1-0.8	800	400	2400	142	242	145	215	<80	28
YX1-1	1000	500	3000	176	258	163	285	<80	50
YX1-2	2000	1000	6000	234	378	212	426	<80	125
YX1-3	3000	1500	9000	286	458	261	521	<80	220

YX2系列 Series YX2

概述 Brief

YX2系列内部采用铁氧体磁性材料制作，它利用棘轮棘爪机构，通过行车的起升一起控制顶杆，自动完成吸、放料工作。具有不需励磁电源，操作方便，使用安全等特点。它广泛适用于工厂，码头，仓库，交通运输部门吊装搬运短而厚的钢板。特设气隙调整杆，可方便的调整磁力大小。但它在卸料状态下，工作底面仍带磁性。

Series YX2 is made of ferrite adopting ratchet wheel and pallet mechanism together with the raise of traveling crane to control the mandril and automatically absorb and unload the materials, featuring no electricity consumption, convenient and safe in operation. It is widely used for lifting and transporting short and thick plates at factory, dock, warehouse and transportation department. The air gas adjusting rod is equipped in particular which can adjust the magnetic force conveniently. Its working face still remain magnetism, during unloading process.

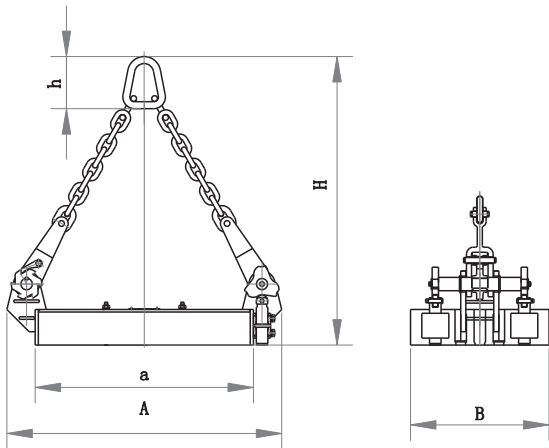

YX2系列外形尺寸图  
Overall Dimension Drawing



实物图  
Actual Picture

主要技术参数  
Main technical data

参 数 data  型 号 model	起重能力 lifting capacity ( kg )	最小卸料能力 Min. discharging capacity ( kg )	最小卸料板厚 Min. thickness of discharging plate ( mm )	最小吸料外形长X宽 Min.dimension of attached material 长L X 宽W (mm)	外形尺寸 overall dimension (mm)					质量 mass (kg)
					A	a	B	H	h	
YX2-0.2	200	20	3	440×185	440	350	185	525	112	50
YX2-0.5	500	50	5	560×275	560	470	275	645	112	80
YX2-1	1000	100	8	720×355	720	540	355	760	165	140
YX2-2	2000	200	10	870×436	870	690	436	905	165	140
YX2-3	3000	500	14	1100×410	1100	950	410	1090	180	410
YX2-5	5000	1500	20	1270×565	1270	1010	565	1130	220	640

电磁铁常用连接方式  
Magnet Connection Drawing

主要技术参数 Main technical data

型 号 model	参 数 data	额定起重能力 rated lifting capacity (kg)	最大拉脱力 Max. pull force (kg)	外形尺寸 overall dimension (mm)			质量 mass (kg)
				A	B	H	
YX4-1		1000	3500	550	350	518	130
YX4-2		2000	7000	625	460	672	250
YX4-3		3000	10500	690	470	806	386
YX4-5		5000	17500	970	580	1020	575
YX4-10		10000	35000	1440	800	1440	1197
YX4-20		20000	70000	1640	800	1560	2110

YX5系列 Series YX5

概述 Brief

YX5系列是采用稀土高性能永磁材料精心设计而成，它通过电动执行机构完成磁路的转换达到快速卸料的目的，因为大吨位的起重器要克服其内部的磁吸合力进行卸料采用人工是不实际的。可广泛用于机械、化工、码头、船厂、钢构厂等需要搬运低于100℃的导磁性钢坯、钢板、圆钢等场合。

Series YX5 which are made of the rare earth can fulfill the aim of discharging quickly through the shift of circuit controlled by motor, because for some large size lifter, it's no way to overcome its inside pick-up force by manual. It is widely used for transporting magnet-conductive steel caster, steel plates, round steels and scrap steels with a temperature under 100℃ in the machinery industry, chemical industry, dock, ship factory, steel structure factory and etc.,

主要技术参数 Main technical data

型号 model	外形尺寸 overall dimension(mm)				自重 self-weight (kg)	额定起重 rated lifting capacity (kg)
	长 L	宽 W	磁体高 magnet height	总高 total height		
YX5-20	1640	800	260	1300	2210	20000
YX5-30	1950	1060	310	1600	3810	30000
YX5-40	2410	1060	350	1900	4710	40000
YX5-50	2410	1220	350	1900	5470	50000

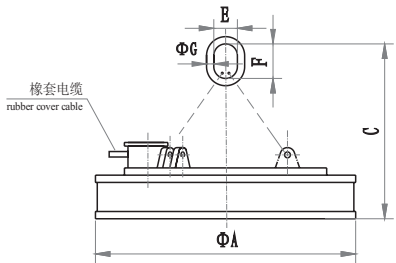

单挂点A型：单挂点与行车主钩或挂梁联接  
Single Suspending Point Mode A: the single suspending point is jointed with crane hook or suspension beam

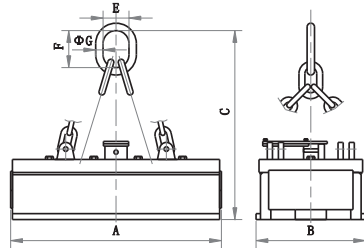

单挂点A I 型：单挂点与行车主钩或挂梁联接  
Single Suspending Point Mode AI: the single suspending point is jointed with crane hook or suspension beam

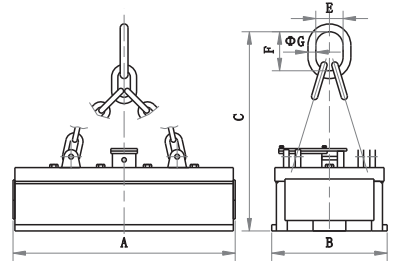

单挂点A II 型：单挂点与行车主钩或挂梁联接  
Single Suspending Point Mode AII: the single suspending point is jointed with crane hook or suspension beam

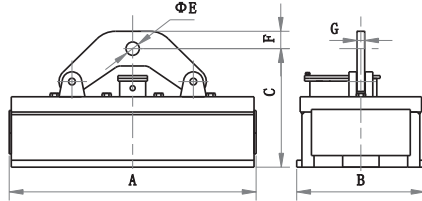

单挂点B型：吊攀与行车或挂梁联接  
Single Suspending Point Mode B: the single lifting hook is jointed with crane or suspension beam.

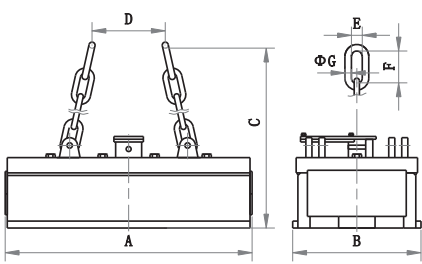

双挂点C I 型：双挂点与行车主钩或挂梁联接  
Double Suspending Points Mode CI: the double suspending points are jointed with crane hook or suspension beam.

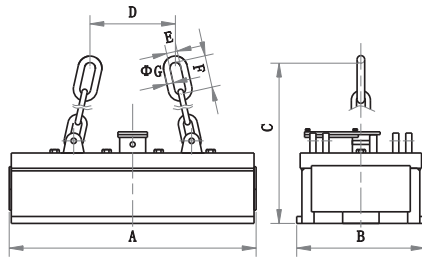

双挂点C II 型：双挂点与行车主钩或挂梁联接  
Double Suspending Points Mode CII: the double suspending points are jointed with crane hook or suspension beam.

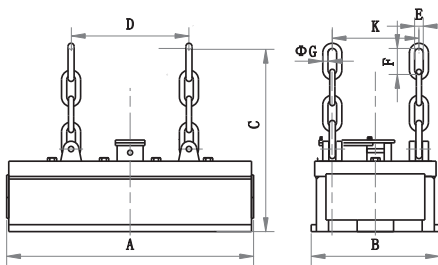

四挂点D I 型：四挂点与行车主钩或挂梁联接  
Four Suspending Points Mode DI: the four suspending points are jointed with crane hook or suspension beam.

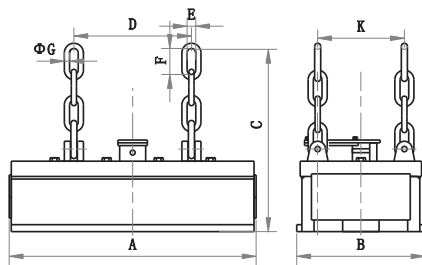

四挂点D II 型：四挂点与行车主钩或挂梁联接  
Four Suspending Points Mode DII: the four suspending points are jointed with crane hook or suspension beam.