

Contents 目录

企业简介	02
COMPANY PROFILE	
选型指南	04
GUIDE FOR MODEL SELECTION	
永磁除铁器	06
PERMANENT MAGNETIC SEPARATOR	
RCYB系列悬挂式永磁除铁器	08
Hanging Type Permanent-magnetic Separator Series RCYB	
RCYD系列带式永磁除铁器	09
belt Type Permanent-magnetic Separator Series RCYD	
RCYD-K系列铠装带式永磁除铁器	10
Armoured Belt Type Permanent-magnetic Separator Series RCYD-K	
RCYD-Q系列轻型带式永磁除铁器	12
Belt Type Light Permanent-magnetic Separator Series RCYD-Q	
RCYP系列手动永磁除铁器	14
Manual Permanent-magnetic Separator Series RCYP	
RCYP II 系列迷你型带式永磁除铁器	15
Belt Type Mini Permanent-magnetic Separator Series RCYPII	
YB板式永磁除铁器	16
Plate Type Permanent-magnetic Separator Series YB	
RCYX系列旋转盘式除铁器	17
Rotary Disk Type Separator Series RCYX	
RCYG管道永磁除铁器	18
Pipe Type Permanent-magnetic Separator Series RCYG	
永磁轮	20
PERMANET-MAGENETIC WHEEL	
YL1永磁轮（全磁）	20
YL1 Permanent-magnetic Wheel (full Magnetic Power)	
YG2永磁轮（半磁）	22
YG2 Permanent-magnetic Wheel (half Magneitc Power)	
电磁除铁器	24
ELECTROMAGNETIC SEPARATOR	
RCDA系列风冷式电磁除铁器	26
Fan Cooling Electromagnetic Separator Series RCDA	
RCDB系列自冷悬挂式电磁除铁器	27
Natural Cooling Hanging Type Electromagnetic Separator Series RCDB	
RCDE系列油冷式电磁除铁器	28
Oil Cooling Electromagnetic Separator Series RCDE	
RCDC系列风冷带式电磁除铁器	29
Fan Cooling Belt Type Electromagnetic Separator Series RCDC	
RCDD系列自冷带式电磁除铁器	30
Natural Cooling Belt Type Electromagnetic Separator Series RCDD	
RCDD-□-10系列自冷带式节能型电磁除铁器	31
Natural Cooling Belt Type Energy-economized Elelctromagnet Series RCDD-□-10	

RCDF系列油冷自卸式电磁除铁器	32
Oil Cooling Type Auto Discharging Electromagnetic Separator Series RCDF	
RCDP系列矿石自动回收式电磁除铁器	32
Auto Ore-recovery Type Electromagnetic Separator Series RCDP	
RCDPS系列矿石回收式带式电磁除铁器	34
Ore-recovery Belt Type Electromagnetic Separator Series RCDPS	
CF(L)系列电磁除铁器	36
Electromagnetic Separator Series CF(L)	
电磁轮	37
ELECTROMAGNETIC WHEEL	
ML1电磁轮（全磁）	37
ML1 Electromagnetic Wheel (full Magnetic Power)	
MG2电磁轮（半磁）	38
MG2 Electromagnetic Wheel (half Magnetic Power)	
G系列强磁除铁器	40
STRONG MAGNETIC SEPARATOR SERIES G	
RCYD-G系列带式强磁永磁除铁器	41
Belt Type Super-strong Permanent-magnetic Separator Series RCYD-G	
RCDA-G系列风冷式强磁电磁除铁器	43
Fan Cooling Type Super-strong Electromagnetic Separator Series RCDA-G	
RCDE-G系列油冷式强磁电磁除铁器	44
Oil Cooling Type Super-strong Electromagnetic Separator Series RCDE-G	
RCDB-G系列自冷盘式强磁电磁除铁器	45
Nature Cooling Disk Type Strong Electromagnetic Separator Series RCDB-G	
RCDC-G系列风冷带式强磁电磁除铁器	47
Fan Cooling Belt Type Strong Electromagnetic Separator Series RCDC-G	
RCDF-G系列油冷带式强磁电磁除铁器	48
Oil Cooling Belt Type Strong Electromagnetic Separator Series RCDF-G	
RCDD-G系列自冷带式强磁电磁除铁器	49
Natural Cooling Belt Type Strong Electromagnetic Separator Series RCDD-G	

控制柜	50
CONTROL CABINET	
SSTM(Q)系列整流控制柜	50
Commutating Control Cabinet Series SSTM(Q)	
SSTM(Q)2系列整流控制柜	53
Commutating Control Cabinet Series SSTM(Q)2	
SSTQO系列整流控制柜	54
Commutating Control Cabinet Series SSTQO	
SSTQT系列整流控制柜	56
Commutating Control Cabinet Series SSTQT	
GJK磁性金属捡除装置（矿石自动回收式）程控柜	57
Program Control Cabinet For Ore Auto Recovery Type Metal Detector Series GJK	
永磁系列控制箱（柜）	60
Control Box (cabinet) For Permanent-magnetic Series	
JTC2系列金属探测器	61
Metal Detector Series JTC2	
除铁器附件	63
ACCESSORIES FOR SEPARATOR	
除铁器电缆选型	63
Cable Model Selection For Separator	
除铁器安装	64
How To Mount The Separator	
除铁器吊挂装置	65
Hanging Device Of Separator	
除铁器行走装置	67
Walking Device Of Separator	
TWG系列非磁性平托辊	69
Non-magnetic Flat Roll Series TWG	
磁选机	70
MAGNETIC SEPARATOR	
CTG干式永磁筒式磁选机	70
Drum-type Dry Permanent-magnetic Separator Series CTG	
YCP系列永磁盘式磁选机	72
Disk Type Permanent-magnetic Separator Series YCP	
超强磁永磁轮式磁选机	73
Super-strong Permanent-magnetic Wheel Type Magnetic Separator	
CTB(N、S)永磁湿式筒式磁选机	74
Drum Type Wet Permanent-magnetic Separator Series CTB(N;S)	
其他磁分离产品	76
OTHER MAGNETIC SEPARATOR PRODUCT	
多功能电磁分离器	76
Multi-function Electromagnetic Separator	
MCF系列振动式电磁分离器	77
Vibration Electromagnetic Separator Series MCF	
SBT系列脱磁器	78
Demagnetizer Series SBT	

概述
General

RCY类悬挂式永磁除铁器是以永磁材料代替电磁线圈产生强大吸引力的高效、环保、节能型除铁设备。其本体采用高剩磁、高矫顽力、高磁能积的稀土永磁材料作为磁源，磁性能稳定持久，温度稳定性高。磁钢选用国内知名磁性材料企业（国家免检）的产品，其原料纯度高，制作工艺先进，确保磁性能不受环境温度及机械振动等因素影响。磁性材料表面电镀（钹铁硼易与空气发生氧化反应，一旦生锈，磁性能下降，使用寿命缩短），并用特制夹具专人装配，将差异性减到最小，在装配过程中进行严格的防腐处理。该系列产品可与各种类型皮带输送机、振动输送机、下料管道等输送设备配套使用。能除去混杂在非磁性物料中重量为0.1~50kg的铁磁性物质，保证下道工序设备（研磨机、破碎机等）正常安全运行。该产品已广泛应用于水泥、火力发电、矿山、陶瓷、非金属矿、冶金、化工、玻璃、造纸、建材、制糖、制药、食品等行业。可在各种恶劣环境中长期无故障运行。

Suspension type permanent-magnetic separator series RCY is high-effective, environment-protective and energy-saving type separator equipment using permanent magnetic materials instead of electromagnetic coils, which produces strong magnetic field attraction. The separator body adopts rare earth permanent magnetic materials featuring high remanence, high coercivity and high magnetic energy as magnetic source. The magnetic property is persistent with high temperature stability. The magnetic steel is chosen from the national famous magnetic material enterprise (national inspection-exempted product) with high purity material and advanced manufacturing process to ensure the magnetic property will not affected by ambient temperature and mechanical vibration. The magnetic material is electroplated on the surface, and assembled with particular clamp by special man, to minimize the difference and make strict anticorrosion treatment. This series links up with transportation equipments such as all types of belt conveyers, vibration conveyers and charging pipelines to form a complete set to remove the iron magnetic materials under weight of 0.1~0.5kg mixed among the non-magnetic materials to ensure normal & safe operation of the next-step equipment (such as muller, crusher, etc.). This series of products are widely applied for cement industry, power industry, ore industry, ceramic industry, non-metallic ore industry, metal industry, chemical industry, glass industry, paper-making industry, building industry, sugar refining industry, pharmaceuticals industry, food industry and so on. This product series can run under adverse environments without failure for a long time.

特点
Features

1. 采用计算机模拟磁路设计，磁场分布合理，透磁深度大。

2. 除铁器本体比电磁除铁器简化，不需励磁电源，不需冷却系统。

3. 无冷、热态差异，节约钢材，自重轻。

4. 省电节能，故障率低。

5. 操作简单，运行安全可靠。

6. 各项技术指标均符合JB/T 8711-1998标准。

1. The series adopts computer simulation magnetic circuit design, with reasonable distribution of magnetic field and a deep penetration.

2. The body is simpler than that of electromagnetic separator, no excitation power nor cooling system required.

3. No difference between cold state and hot state; saving steel and light self-weight.

4. Power-saving and little fault.

5. Simple operation and reliable performance.

6. All technological data accord with JB/T 8711-1998.

型号说明
Model Designation

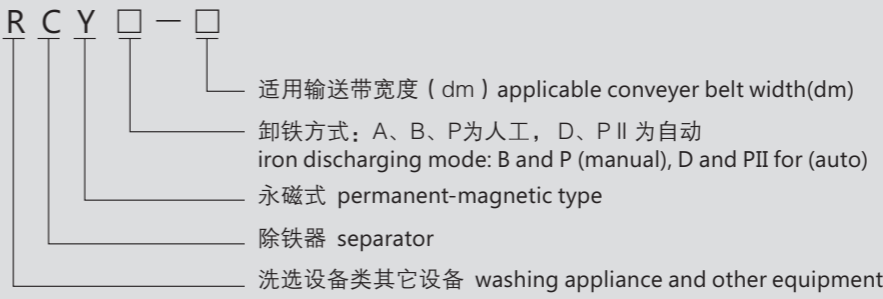

永磁除铁器
Permanent Magnetic Separator

RCYB系列悬挂式永磁除铁器
Hanging Type Permanent-magnetic separator Series RCYB

RCYB系列悬挂式永磁除铁器内部采用高矫顽力、高剩磁的“钕铁硼”材料组成磁系，完全淘汰采用铁氧体磁性材料制作，具有免维护、磁力强、寿命长、安装简单、重量轻、使用方便、运行可靠等优点，适用于皮带机、振动输送机、电磁振动给料机、下料溜槽上的非磁性物料中除铁。可清除0.1~35kg的铁磁性物质，内部永磁磁系使用寿命10年以上。该产品各项技术指标均符合JB/T 8711-1998标准。

当除铁器底部吸附的铁磁物较多时，人工用非磁性刮板或戴手套摘除，适用于连续工作，含铁较少的场合。

Series RCYB is made of NdFeB, a high-remanence & coercivity material, which takes the place of ferrite totally, and has many advantages like maintenance-free, strong magnetic force, long life, simple installation, light weight, user-friendly operation and reliable performance and is suitable for removing non-magnetic material on the belt conveyer, vibration conveyer, electric-vibrating feeder and feeder groove. It can remove 0.1~35kg iron materials with more than 10 years service time of inner permanent magnet. All technical data accord with standard of JB/T 8711-1998.

When lots of iron materials are attracted onto the bottom of separator, use non-magnetic scraper or gloves to remove them manually. It is suitable for continuous working and low iron-content situation.

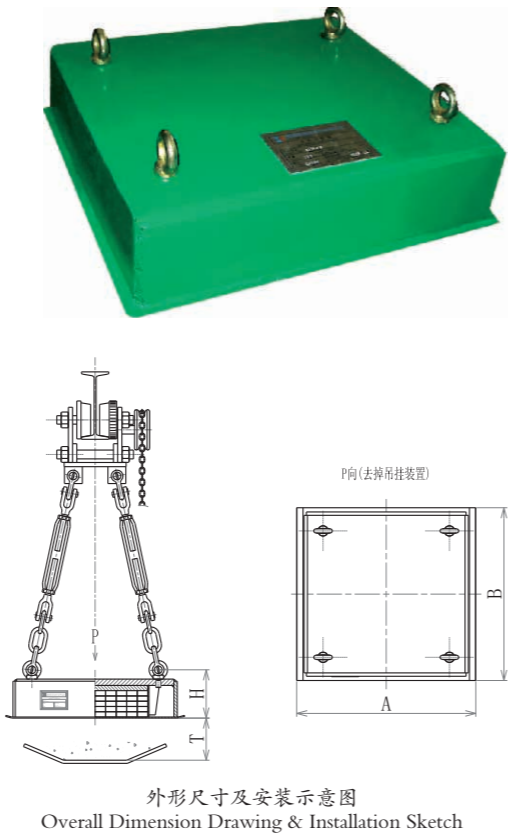

主要技术参数 Main technical data

型 号 model	适应带宽 applicable belt width (mm)	悬挂高度 hanging height (T < mm)	磁场强度 magnetic induction (≥mT)	适应带速 applicable belt speed (≤m/s)	物料厚度 material thickness (≤mm)	外形尺寸 overall dimension (mm)			质量 mass (kg)
						A	B	H	
RCYB-3	300	75	57	4.5	50	350	300	250	65
RCYB-4	400	100	60		70	450	350	275	115
RCYB-4-1	400	75	60		30	400	260	220	75
RCYB-5	500	150	60		90	550	450	305	206
RCYB-5-1	500	100	60		50	500	310	230	165
RCYB-6	650	200	65		150	735	650	312	450
RCYB-6-1	650	130	65		100	650	400	236	210
RCYB-8	800	250	68		200	985	850	315	680

RCYB-8-1	800	200	68	4.5	150	800	600	270	420
RCYB-10	1000	300	68		250	1080	960	386	1180
RCYB-12	1200	350	68		300	1280	1120	400	1660
RCYB-14	1400	400	68		350	1450	1350	420	2350

注：RCYB-□-1型为物料厚度较薄的场合特殊设计。
Note: Series RCYB-□-1 is designed specially for handling thin materials.



RCYD系列带式永磁除铁器
Belt Type Permanent-magnetic Separator Series RCYD

RCYD系列带式永磁除铁器是由高性能永磁磁芯、弃铁皮带、减速电机、台架、滚筒（无缝管加工成腰形防皮带跑偏）等部分组成，与各种输送机配套使用。用于从非磁性物料中自动清除0.1~35kg重的铁磁性物质。其内部磁路采用计算机模拟设计、完善的双磁极结构，保障整机在恶劣环境中无故障长期运行。既可用于原料品位的提高与净化，同时也能用于回收磁性物质，该系列产品广泛应用于电力、冶金、铸造、矿山、造纸、建材、食品、水泥、选煤、化工等行业。拥有防爆型。

Series RCYD is made of high-performance permanent-magnetic core, iron discharging belt, reducer motor, stand, roll (a waist shape seamless pipe designed to avoid running aside of the belt) and etc., which can be combined with conveyers to remove 0.1~35kg iron from non-magnetic materials. The inner magnetic circuit adopts computer simulation design and perfect double magnetic pole structure, which ensures a performance of long time running and no chance of getting fault even in harsh working conditions. Series RCYD can be used for improving and purifying material quality as well as recovering magnetic material and have been widely applied in power industry, metallurgical industry, casting industry, mining industry, paper-making industry, building material industry, food industry, cement industry, coal-washing industry, chemical industry and so on. We also have an anti-explosion type.

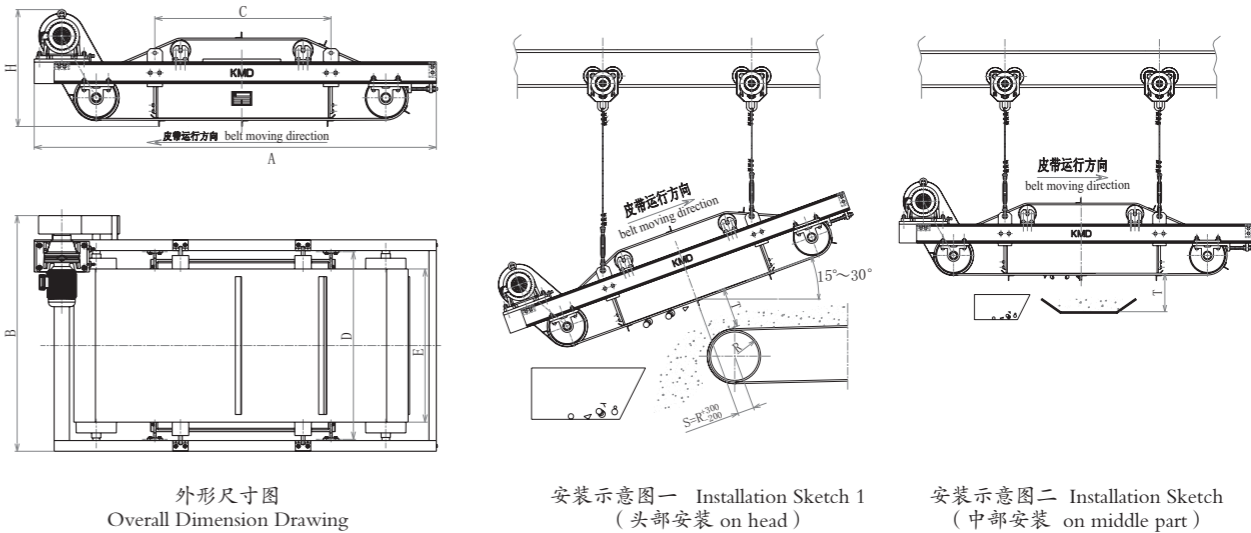

主要技术参数 Main technical data

型 号 model	适用 带宽 applicable belt width E (mm)	悬挂 高度 hanging height T (mm)	磁场 强度 magnetic induction (≥mT)	物料 厚度 material thickness (≤mm)	适应 带速 applicable belt speed (≤m/s)	驱动 功率 driving power (kW)	外形尺寸 overall dimension (mm)			悬挂尺寸 hanging size (mm)		质量 mass (kg)
							A	B	H	C	D	
RCYD-4	400	100	70	70	4.5	1.5	1780	800	705	570	620	640
RCYD-5	500	150		100		1.5	1900	1008	730	646	704	750
RCYD-6	650	200		150		2.2	2010	1145	730	770	874	1210
RCYD-8	800	250		200		3.0	2750	1360	740	1100	1110	1377
RCYD-10	1000	300	71	250		3.0	2900	1600	815	1400	1380	1870
RCYD-12	1200	350		300		4.0	3200	1733	835	1500	1535	2750
RCYD-14	1400	400		350		4.0	3300	1890	900	1520	1675	3350
RCYD-16	1600	450		400		5.5	3350	2160	915	1980	1850	4300
RCYD-18	1800	500	72	450		7.5	3580	2450	1020	2150	2120	6320
RCYD-20	2000	550		500		7.5	4200	2700	1020	2180	2410	9860
RCYD-22	2200	600		550		11	4600	2910	1050	2410	2630	12200

注：手动卸料皮带式永磁除铁器是在本系列除铁器去掉驱动电机、链轮等改装而成的，本样本中未单独列出，可参照RCYD系列选型。
Note: Manual discharging belt type permanent-magnetic separator is a reformed one (without drive motor, chain wheel and etc.) which does not list in the sample separately. Please refer to series RCYD.

RCYD–K系列铠装带式永磁除铁器
Armoured Belt Type Permanent-magnetic Separator Series RCYD-K

主要用途 Application

专门用于冶金渣选铁、直接还原铁厂选铁、焖渣车间选铁、铸造车间选铁。由于以上场合环境温度高、铁件大且不规则，一般带式除铁器根本不能适应。

This series are specially made for metallurgical slag, iron plant, slag plant and casting plant. As in which the ambient temperature is usually high and iron pieces are big and irregular, the normal belt separators are not suitable at all.

注：带式电磁系列亦有铠装式，未单独列出。
Note: We also have armoured belt electromagnet, which does not list separately.

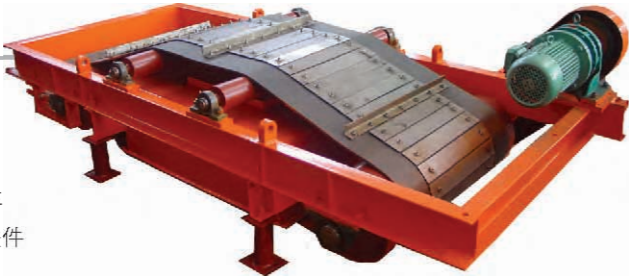

技术特点 Features

- ☆独特设计铠装式皮带，能有效防止尖锐铁磁性杂物对皮带的损害，运行经济。
- ☆额定高度处磁场强度高、梯度大、吸力特强。
- ☆无需电励磁，省电节能，自动卸铁，运行方便。
- ☆稀土钕铁硼永磁材料作为磁源，自重轻，磁性能稳定可靠。
- ☆腰鼓形滚筒防跑偏，全密封轴承座，重型托辊，适应恶劣环境下工作。
- ☆结构紧凑合理，维修保养方便，皮带加厚，可长期无故障安全运行。
- ☆规格齐全，有符合国标的普通型和高于国标的超强型，并有防爆型。

- ☆Armoured belt type has unique design, which can effectively avoid belt damaging caused by acuate materials and the operation cost is economical.
- ☆It has strong magnetic field, great gradient and strong attraction force at rated altitude.
- ☆No excitation power required, energy-saving, automatic iron discharging and easy operation.
- ☆Adopt Nd-Fe-B as permanent magnetic source. Light self-weight and reliable performance.
- ☆Waist shape roll in case of running aside of the belt; full-sealed bearing base and heavy supporting roll and can be put into operation in harsh working conditions.
- ☆Compact and reasonable structure and easy maintenance, thickening belt, and can be used for a long time without failure.
- ☆Complete specifications: normal type (accord with the international standard), superstrong type (beyond the international standard), as well as an explosion-proof type.

RCYD–K普通系列 Series RCYD-K

型 号 model	适用 带宽 applicable belt width (mm)	悬挂 高度 hanging height < mm	磁场 强度 magnetic induction (≥mT)	吸铁 能力 iron ttracting capacity (kg)	适应 带速 applicable belt speed ≤m/s	驱动 功率 driving power (kW)	外形尺寸overall dimension (mm)			悬挂尺寸 hanging size (mm)		质量 mass (kg)		
							A	B	C	D	E			
RCYD-K50	500	150	71	0.1-36	4.5	2.2	1900	1008	731	646	704	760		
RCYD-K65	650	200				3.0	2010	1145	731	770	874	1260		
RCYD-K80	800	250				3.0	2750	1360	740	1100	1110	1410		
RCYD-K100	1000	300	75			4.0	2900	1600	815	1400	1380	2180		
RCYD-K120	1200	350				5.5	3200	1733	835	1500	1535	3420		
RCYD-K140	1400	400				5.5	3300	1890	900	1520	1675	4570		

RCYD-K超强系列 Super-strong Series RCYD-K

型 号 model	适用 带宽 applicable belt width E (mm)	悬挂 高度 hanging height (< mm)	磁场 强度 magnetic induction (≥ mT)	吸铁 能力 iron attracting capacity (kg)	适应 带速 applicable belt width (≤ m/s)	驱动 功率 driving power (kW)	外形尺寸 overall dimension (mm)			悬挂尺寸 hanging size (mm)		质量 mass (kg)
							A	B	C	D	E	
RCYD-K65	G1	650	200	90		2.2	2160	1075	731	1200	890	1340
	G2					2.2	2160	1075	731	1200	890	1450
	G3					2.2	2310	1075	731	1300	890	1785
RCYD-K80	G1	800	250	90		3.0	2350	1280	755	1300	1090	1950
	G2					3.0	2350	1280	755	1300	1090	2210
	G3					4.0	2520	1280	755	1400	1090	2855
RCYD-K100	G1	1000	300	90		4.0	2660	1540	950	1400	1335	2380
	G2					4.0	2660	1540	950	1400	1335	2735
	G3					5.5	2760	1540	950	1400	1335	3720
RCYD-K120	G1	1200	350	90		5.5	2900	1730	980	1600	1515	3290
	G2					5.5	2900	1730	980	1600	1515	4140
	G3					5.5	2900	1730	980	1600	1515	5190
RCYD-K140	G1	1400	400	90		5.5	3225	1980	1180	1900	1750	4845
	G2					5.5	3225	1980	1180	1900	1750	5665
	G3					7.5	3340	1980	1180	1900	1750	7495

专家建议：超大块铁件可先用起重电磁铁吸出，以减轻除铁器工作负荷。
Expert's advice: huge iron pieces can be attracted and removed firstly by lifting electromagnet to release the work load of the separator.

RCYD-Q系列轻型带式永磁除铁器
Belt Type Light Permanent-magnetic Separator Series RCYD-Q

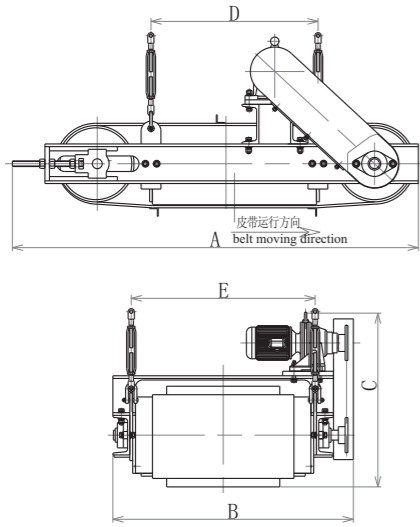

外形尺寸图 Overall Dimension Drawing

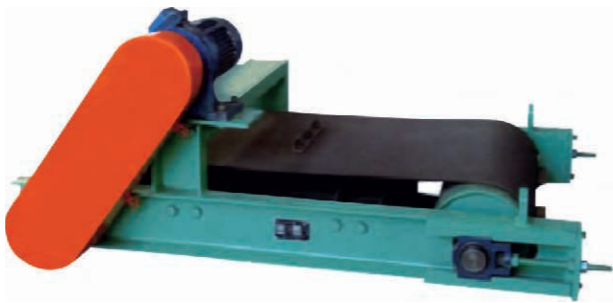

技术特点 Features

- 外形尺寸小，长度、高度分别为RCYD型的70%和86%；
- 噪音低，并能连续吸铁、除铁。
- 重量轻，平均重量不到RCYD型重量的75%。
- 结构紧凑，取消了托辊，构件少，便于吊装，便于维修管理，经济实用。

- Overall dimension are small-size, with about 70% length and 86% height of series RCYD.
- Low noise and can attract and remove iron continuously.
- Light weight. Average weight is usually less than 75% of that of series RCYD.
- Economic products for the compact structure; fewer components; abandoned flat roll; easy to be hoisted and repaired;

适用范围 Application

适用于含铁较少、物料较薄的场合。其中B=650mm（含）以下吸铁能力为0.1～10kg，B=650mm以上吸铁能力0.1～15kg。广泛应用于环保、木业、粮食、铸造、化工、建材、矿山、轻工等行业。

This series is suitable for thin materials and low iron content situation. Among which B≤650mm is for attracting 0.1 to 10 kg material, and B>650mm is for 0.1 to 15 kg. The products are widely applied in environment protection, wood, food, casting , chemical industry, building material, mining, light industry and so on.

主要技术参数 Main technical data

型 号 model	适用 带宽 applicable belt width (mm)	悬挂 高度 hanging height (< mm)	磁场 强度 magnetic induction (≥ mT)	物料 厚度 material thickness (≤ mm)	适应 带速 applicable belt speed (≤ m/s)	驱动 功率 driving power (kW)	外形尺寸 overall dimension (mm)			悬挂尺寸 hanging size (mm)		质量 mass (kg)
							A	B	C	D	E	
RCYD-Q40	400	100	55	70	2.5	1.5	1270	840	510	1020	580	376
RCYD-Q50	500	150	57	90	2.5	1.5	1340	1006	615	1100	674	420
RCYD-Q65	650	200	60	150	2.5	2.2	1550	1150	713	1340	820	660
RCYD-Q80	800	250	65	200	3.15	2.2	1715	1385	733	1480	1022	840
RCYD-Q100	1000	300	65	250	4.0	3	1890	1535	733	1540	1120	1410
RCYD-Q120	1200	350	65	300	4.5	4	2100	1710	765	1780	1340	1710

注：若安装空间中高度特别狭小，我公司可提供采用锥齿蜗轮蜗杆传动的减速电机，保证除铁器总高尺寸小于560mm（大型号强磁系列除外）。

Note: We advice to use reducer motor with spiroid drive for limited installation space to ensure the total height of the separator is less than 560 mm (some strong magnetic series are excluded).

永磁除铁器
Permanent Magnetic Separator

RCYP系列手动永磁除铁器
Manual Permanent-magnetic Separator Series RCYP

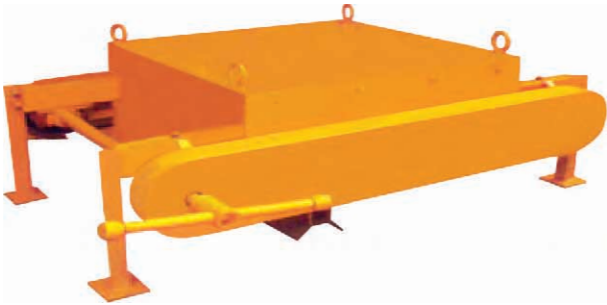

RCYP系列手动永磁除铁器是由高性能永磁磁芯、卸铁链条、卸铁摇杆及链条护罩等共同组成的手动清铁除铁器，与各式输送机配套使用。用于从非磁性物料中自动清除铁磁性杂质。当磁铁底部吸附的铁磁性杂物累积到一定程度时，人工摇动手柄驱动刮板，清除废铁。该系列产品与带式自卸除铁器相比具有重量轻、物美价廉、经济实用等特

Series RCYP is manual separator composed of high-performance core, discharging iron chain & rocker and chain cover. This series can be combined with conveyers to remove the iron automatically. When the iron material at the bottom of the magnet is accumulated to some extent, the worker should drive scraper manually to remove scrap. Compared with self-discharging belt separator, this series is superior in weight and price, etc., and thus suitable for low iron content and iron weight less than 25 kg.

本系列除铁器中部安装时可采用悬挂式安装（见左下图），亦可用四个支撑脚固定安装（订货时注明）。
This series can be mounted by hanging (see the following figure) or by four supporting feets (when placing an order, please tell us your option).

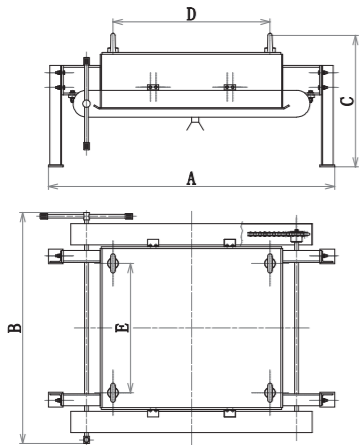

外形尺寸图
Overall Dimenison Drawing

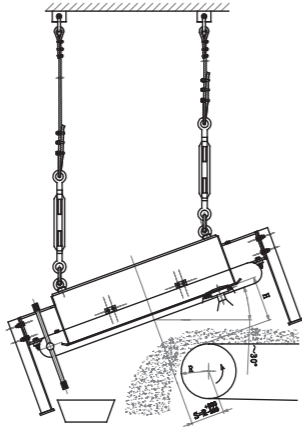

安装示意图一 Installation Sketch 1
(头部安装on head)

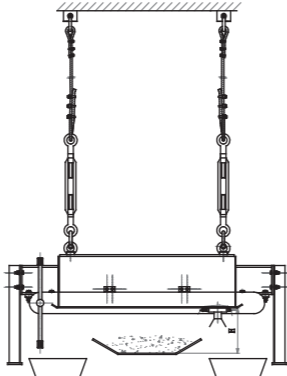

安装示意图二 Installation Sketch 2
(中部安装on middle part)

主要技术参数 Main technical data

型 号 model	适用带宽 applicable belt width (mm)	悬挂高度 hanging height H (mm)	磁场强度 magnetic induction (≥mT)	物料厚度 material thickness (≤mm)	适应带速 applicable belt speed (≤m/s)	外形尺寸 overall dimension (mm)			悬挂尺寸 hanging size (mm)		质量 mass (kg)
						A	B	C	D	E	
RCYP-4	400	100	65	70	2.5	1100	910	500	470	340	245
RCYP-5	500	150	65	100	2.5	1200	1020	550	570	440	580
RCYP-6	650	200	65	150	2.5	1380	1170	550	715	550	820
RCYP-8	800	250	68	200	2.5	1630	1300	560	915	750	1500
RCYP-10	1000	300	68	250	2.5	1765	1500	560	1060	900	2300
RCYP-12	1200	350	68	300	2.5	1970	1750	580	1250	1140	3300
RCYP-14	1400	400	71	350	4.5	2180	1950	620	1450	1350	3800
RCYP-16	1600	450	71	400	4.5	2320	2140	650	1700	1550	4200

RCYP II 系列迷你型带式永磁除铁器
Belt Type Mini Permanent-magnetic Separator Series RCYPII

RCYP II 系列迷你型带式永磁除铁器是由高性能永磁磁芯、弃铁皮带、减速电机、台架、滚筒等部分组成，与各种输送机配套使用。用于从非磁性物料中自动清除铁磁性物质。与RCYD系列带式永磁除铁器相比，其台架缩短，适于安装空间受限制（主要是长度方向）的场合。拥有防爆型。

Series RCYPII is composed of high-performance core, iron discharging belt, reducer motor, stand, roll and other parts, which can be combined with conveyers to remove iron material automatically. Compared with series RCYD, its stands are shorter and thus more suitable for limited space (especially in length). We also have an anti-explosion type.

安装方式请参考RCYD系列带式永磁除铁器。
For installation mode, please refer to that of belt type permanent-magnetic separator series RCYD.

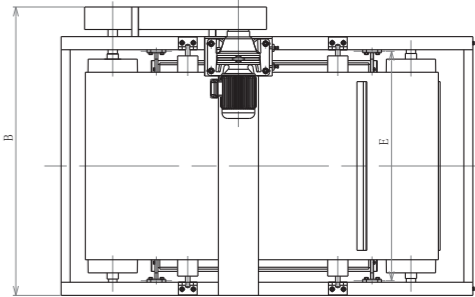
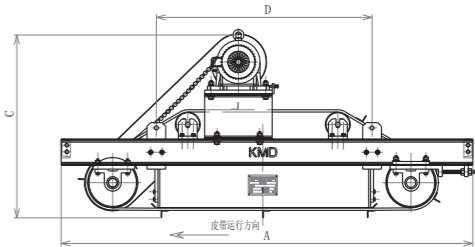

外形尺寸图
Overall Dimenison Drawing

永磁除铁器
Permanent Magnetic Separator

主要技术参数 Main technical data

型 号 model	适用 带宽 applicable belt width (mm)	悬挂 高度 hanging height (< mm)	磁场 强度 magnetic induction (≥mT)	物料 厚度 material thickness (≤mm)	适应 带速 applicable belt speed (≤m/s)	外形尺寸 overall dimension (mm)			悬挂尺寸 hanging size (mm)		质量 mass (kg)
						A	B	C	D	E	
RCYP II -4	400	100	65	70	3.0	1340	714	810	550	630	560
RCYP II -5	500	150		100		1550	936	850	620	755	780
RCYP II -6	650	200	70	150	4.5	1750	1075	895	770	835	1020
RCYP II -8	800	250		200		1940	1280	935	900	1088	1320
RCYP II -10	1000	300		250		2170	1530	1050	1100	1375	2080
RCYP II -12	1200	350		300		2450	1740	1140	1320	1550	2930
RCYP II -14	1400	400	71	350		2680	1920	1140	1550	1740	3820
RCYP II -16	1600	450		400		2850	2140	1215	1780	1910	5180
RCYP II -18	1800	500		450		3380	2420	1290	2010	2100	7030

YB板式永磁除铁器
Plate Type Permanent-magnetic
Separator Series YB



主要用途 Application

主要用于除去松散、密度轻的非磁性物料中的弃铁，适用于化工，陶瓷、蔗糖、粉体工程、玻璃、食品、烟草等行业。

This series which is mainly used for removing steel scraps from loose, low-density non-magnetic materials are suitable for chemical industry, ceramic industry, sugar industry, powder industry, glass industry, food industry, tobacco industry and so on.

工作原理 Working Principle

一般将其倾斜放置，物料从料槽或皮带输送机、振动给料机下落到工作面上，非磁性物料由于重力作用沿斜坡下落，而铁磁性物料由于磁力作用被吸附在工作面上。待铁磁物料达一定程度后，人工清除。

Tilt it and let the material slip down from the groove, belt conveyor, or vibration feeder. Non-magnetic material will drop down under gravity, while the magnetic material is attracted onto the working face. Remove the magnetic material manually when it's accumulated to some extent.

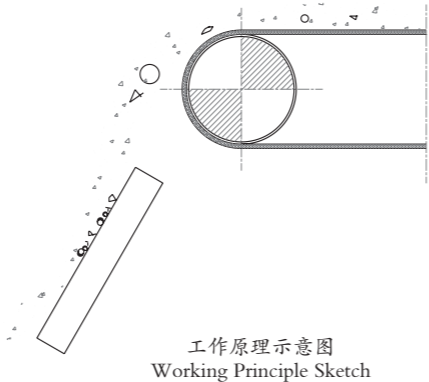

工作原理示意图
Working Principle Sketch

技术特点 Features

1. 采用稀土永磁体强磁、体积小、重量轻、节能无能耗，安装方便。
2. 外包抛光不锈钢，无二次污染、无锈蚀，美观卫生，经久耐用。
3. 表面磁场强度大，磁场梯度大、磁力强，除净率高。

1. Adopt rare earth permanent magnet, compact structure, light, no energy consumption, and simple installation.
2. Coated with polishing stainless steel, without secondary pollution and corrosion, beautiful, clean and durable.
3. Strong magnetic field, great magnetic field gradient, strong magnetic force and efficient removing rate.

主要技术参数 Main technical data

型号model 参数项目items	YB-30	YB-40	YB-50	YB-65	YB-80	YB-100
长 length (mm)	400	640	800	960	1130	1450
宽 width (mm)	300	420	530	670	800	1000
厚 thickness (mm)	46	46	46	56	56	76
重量 weight (kg)	42	98	147	310	420	890
适用带宽 (mm) applicable belt width	300	400	500	650	800	1000

RCYX系列旋转盘式除铁器
Rotary Disk Type Separator Series RCYX

为我公司专利产品。现有的自卸式除铁器大都是带式除铁器或为程控式盘式除铁器，其中带式结构复杂且皮带容易被吸附上来的矿渣、废料中的尖锐铁器划伤，导致皮带更换频繁，盘式电磁除铁器控制复杂。本系列除铁器最大优点就是被吸铁件与除铁器本体不接触。

其工作原理：由永磁磁系或电磁铁产生强大磁场，磁系下方设置一与除铁器中心偏移量不大的旋转盘（与除铁器底部不接触），其直径为除铁器外形的一倍，当有铁磁性物料经过旋转盘下方时，由于除铁器的磁场吸引，会被吸附到旋转盘上，随着旋转盘的转动，被吸物被移到皮带区域外部，此时除铁器对铁件的吸力降低，铁磁性物料在离心力和重力的作用下，被甩到集铁斗中。

This is our patented product. The existing self-discharging separators are mostly belt type or program controlled disk type. Among which the structure of the belt type separator are complex and get scratched easily by acuate scrap, resulting in a frequent belt replacing. And it is more complicated to control the disk type. The best advantage of this series is the material to be attracted has no need to touch the separator body.

Working principle: there is a strong magnetic field produced by permanent magnet system or electromagnet. A rotary disc is mounted without touching the bottom of the separator under the magnet system and its diameter is about twice as big as that of separator. When magnetic material passing through and being attracted, it would soon be moved out of the belt where the attract force gets weak and go on being moved to collecting bucket under the function of centrifugal force and gravity.

永磁除铁器

Permanent Magnetic Separator

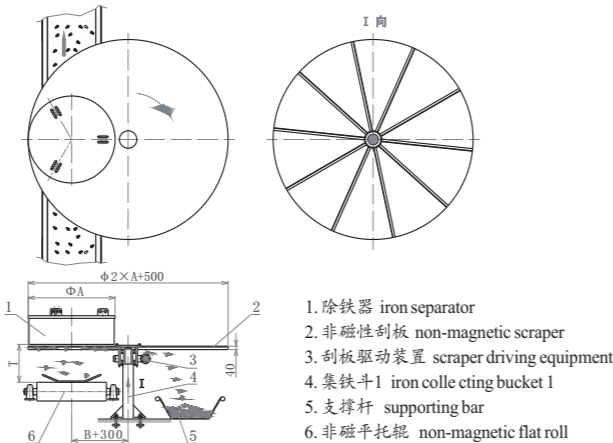

主要技术参数 Main technical data

型 号 model	适用带宽 applicable belt width (mm)	悬挂高度 hanging height < mm	磁场强度 magnetic induction (≥mT)	物料厚度 material thickness (≤mm)	适应带速 applicable belt speed (≤m/s)	备注 remark
RCYX-4	400	100	70	70	3.0	除铁器本体可选用RCDA、RCDB、RCDE、RCYB等不能自动卸料的系列。按输送皮带宽度及悬挂高度选用相对应的型号产品。
RCYX-5	500	150	70	100	3.0	
RCYX-6	650	200	70	150	3.0	
RCYX-8	800	250	70	200	4.5	
RCYX-10	1000	300	70	250	4.5	
RCYX-12	1200	350	70	300	4.5	
RCYX-14	1400	400	71	350	4.5	Un-automatic Series RCDA, RCDB, RCDE, RCYB are optional as separator body. Choose the right model as per belt width and hanging height.
RCYX-16	1600	450	72	400	4.5	
RCYX-18	1800	500	72	450	4.5	

注：1. 由于旋转盘直径为皮带宽度的2倍左右，选用本系列请先确定是否有足够的安装空间。

2. 本系列除铁器亦可采用G1、G2、G3超强磁场值。

Note: 1. Due to the diameter of rotary disc is twice as big as that of belt width, please ensure an enough installation space.

2. Super-strong magnetic field G1, G2 and G3 is adoptable for this series separator.

RCYG管道永磁除铁器
Pipe Type Permanent-magnetic
Separator Series RCYG

RCYG系列管道永磁除铁器包括无磁管道和永磁铁两部分，专用于对管道内非磁性物料的除铁，永磁除铁器内部采用高性能稀土强磁材料组成复合磁系。具有体积小、磁力大、重量轻、除铁干净、方便、无能耗、使用寿命长等特点。适合没有输送皮带，只能提供下料溜槽的场合。当散状物料经过管道式永磁除铁器时，铁杂物被高场强的永磁铁所吸附，清除铁杂质时，打开管道专用门将杂质去除。该设备适用于含铁量较少的场合。主要应用于水泥、化工、煤炭、塑料、耐火材料、建材、制药等行业的下料管道中清除杂物。安装在各种输送机或提升机的进料口或出料口处，上下接口可根据用户要求定制。（本产品适用于除高温外的各种工况条件下）



圆形管道实物图
Picture (Round Pipe)

Series RCYG which consists of non-magnetic pipe and permanent magnet are specially made for removing iron inside the pipes from non-magnetic materials. The separator adopts high-performance rare earth material featuring compact structure, strong magnetic force, light, efficient removing rate, simple operation, no energy consumption, and long life is suitable for the occasion of no conveyer available but just a chute. When the loose material passes through the pipe, steel scraps are attached and can be removed manually through a special window of the pipe. This series which is usually used for low iron content situation are mainly applied in cement industry, chemical industry, coal industry, plastic industry, refractory industry, building industry, pharmaceutics industry and so on. It is mounted at the inlet or outlet of equipment and entrance dimension can be made specially to meet different requirement. (This series is used at normal working tempt.)



方形管道实物图
Picture (Square Pipe)

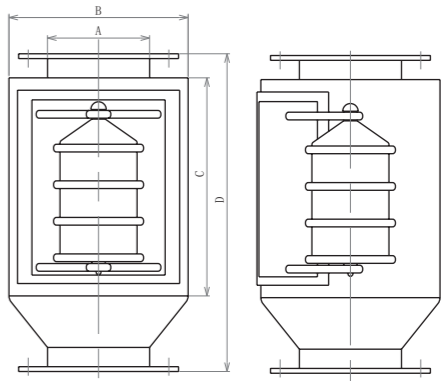

RCYG2系列外形尺寸图
Overall Dimension Drawing of Series RCYG2

RCYG2系列（圆形管道）Series RCYG2 (Round Pipe)

主要技术参数 Main technical data

型 号 model	外形尺寸 overall dimension (mm)				处理量 handling capacity (m³ / h)	重量 mass (kg)
	Φ A	Φ B	C	D		
RCYG2-1	114	165	250	400	1	7
RCYG2-2	140	200	320	470	2	13
RCYG2-3	168	230	400	610	5	24
RCYG2-4	219	280	500	710	9	33
RCYG2-5	273	345	530	740	13	50
RCYG2-6	325	390	610	870	18	60
RCYG2-7	351	435	680	940	22	95
RCYG2-8	426	495	760	1020	29	120

YL1永磁轮（全磁）
YL1 Permanent-magnetic
Wheel (Full Magnetic)



YL1系列永磁轮亦称磁滑轮或干式大块磁选机。其内部采用高性能硬磁材料组成复合磁系，具有磁场强度高、深度大、结构简单、使用方便、不需维修、不消耗电力，常年使用不退磁等特点。广泛用于水泥、磁选、矿山、钢铁、化工、耐火材料、垃圾处理等行业的选铁。与DT-75型、AD-80型通用固定式皮带输送机配套使用代替主动轮，也可与专用皮带输送机配套。

Series YL1, are also called magnetic pulley or dry type large separator, adopts high-performance hard material featuring high magnetic induction, simple structure, convenient, maintenance-exempt, no energy consumption, no demagnetization and are widely applied in cement industry, magnetic separation industry, ore industry, steel industry, chemical industry, refractory industry, rubbish treatment industry and etc. It can be used as driving wheel when combined with DT-75 or AD-80 general fixed type belt conveyer, and also can match special belt conveyer.

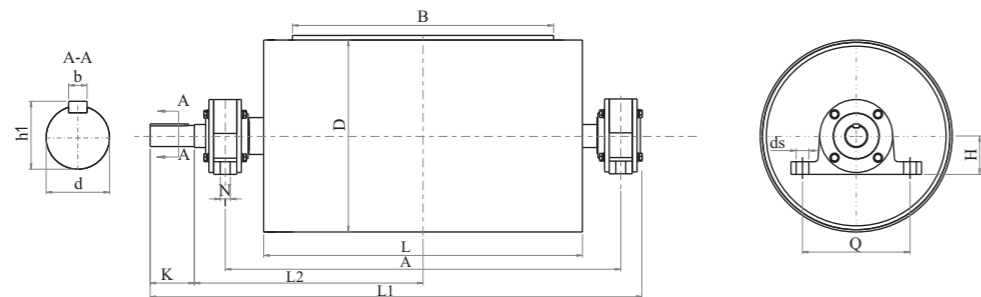

外形尺寸图 Overall Dimension Drawing

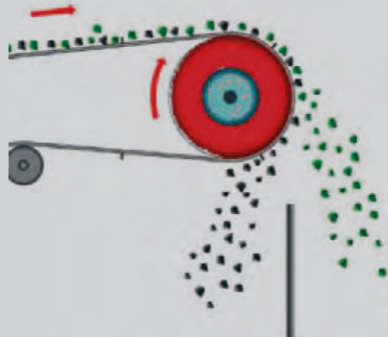

安装方式
Installatin Mode

主要技术参数 Main Technical Data

型号 model (G1/G2/G3)	筒径 drum diameter D(mm)	适用带宽 applicable belt width B(mm)	筒体表磁 surface magnetic induction (GS)	适应带速 applicable belt speed (≤m/s)	处理量 handling capacity (≤t/h)	外形尺寸 overall dimension(mm)												质量 mass (kg)
						A	L	L1	L2	K	N	Q	H	h1	d	b	ds	
YL1-3230	315	300	1300	2.5	15	680	450	900	365	90	-	212	75	43	40	12	M16	130
YL1-3240	315	400	1300	2.5	16	720	500	960	390	100	-	236	80	48.5	45	14	M16	180
YL1-3250	315	500	1300	2.5	20	850	600	1114	425	140	-	350	120	74.5	70	20	M20	230
YL1-4050	400	500	1450	2.5	30	850	600	1114	425	140	-	350	120	74.5	70	20	M20	290
YL1-5050	500	500	1600	2.5	30	850	600	1114	495	140	-	350	120	74.5	70	20	M20	420
YL1-4065	400	650	1400	2.5	40	1000	750	1264	570	140	-	350	120	74.5	70	20	M20	390
YL1-5065	500	650	1600	2.5	45	1000	750	1264	570	140	-	350	120	74.5	70	20	M20	550
YL1-6365	630	650	1800	2.5	55	1000	750	1264	570	140	-	350	120	74.5	70	20	M20	770
YL1-5080	500	800	1550	2.5	65	1300	950	1624	740	170	-	380	135	95	90	25	M24	710
YL1-6380	630	800	1800	2.5	80	1300	950	1624	740	170	-	380	135	95	90	25	M24	1200
YL1-8080	800	800	1800	2.5	100	1300	950	1624	740	170	-	380	135	95	90	25	M24	1850
YL1-63100	630	1000	1800	4.0	120	1500	1150	1824	880	170	-	380	135	95	90	25	M24	1560
YL1-80100	800	1000	1800	4.0	140	1500	1150	1869	840	210	-	440	155	116	110	28	M24	2300
YL1-100100	100	1000	1800	4.0	160	1500	1150	1869	840	210	-	440	155	116	110	28	M24	2900
YL1-63120	630	1200	1800	4.0	140	1750	1400	2192	1015	210	-	440	155	116	110	28	M24	1950
YL1-80120	800	1200	1800	4.0	160	1750	1400	2192	1015	210	-	440	155	116	110	28	M24	2750
YL1-100120	100	1200	1800	4.5	180	1750	1400	2192	1015	210	-	440	155	116	110	28	M24	3450
YL1-80140	800	1400	1800	4.0	190	2050	1600	2475	1125	250	-	480	170	137	130	32	M30	3300
YL1-100140	1000	1400	1800	4.5	220	2050	1600	2475	1125	250	-	480	170	137	130	32	M30	4100
YL1-125160	1250	1600	1800	4.5	260	2450	1850	2900	1320	255	105	520	200	158	150	36	M30	5600
备注 remark	筒表磁场强度另有G1=2500Gs、G2=3000Gs、G3=3500Gs产品，如果您有特殊要求，我们将按您的要求设计。G1-G3系列产品重量比表格中重量轻40%-30%。 The drum surface magnetic induction is also provided with G1=2500Gs,G2=3000Gs and G3=3500Gs. If you have special requirements, please let us know and we will design it specially to meet your demand. The weight of series G1 to G3 products is 40% ~30% lighter than the value listed in the table.																	

YG2永磁辊（半磁）
YG2 Permanent-magnetic Wheel
(Half Magneitc Power)



YG2系列半磁永磁辊多用于对粉状、颗粒状、小块状物料的净化处理及钢渣和矿石的磁选处理、或对铁质的回收利用，对防止破碎机、研磨机、压榨机的破坏和磨损起着可靠的保护作用。它安装方便、吸力强、无能耗、连续工作、操作简单。根据TD-75型带式输送机标准设计，能满足广大用户对高场强、大深度除铁的使用要求。广泛应用于冶金、磁选、磨料磨具、金刚砂、非金属矿、耐火材料、矿山、食品、化工、玻璃、建材等行业。

Series YG2 which are usually suitable for purification treatment on powdery, grainy and small material, or iron recovery can protect crusher, muller and mill from damage or wear, featuring simple installation, strong attraction force, no energy consumption, continuous work and simple operation. This series which is designed as per the standard of series TD-75 can satisfy customer's need of high magnetic induction and deep removing and now are widely applied in metallurgy industry, abrasive industry, corundum industry, nonmetal ore industry, refractory industry, mine industry, food industry, building material industry and etc.

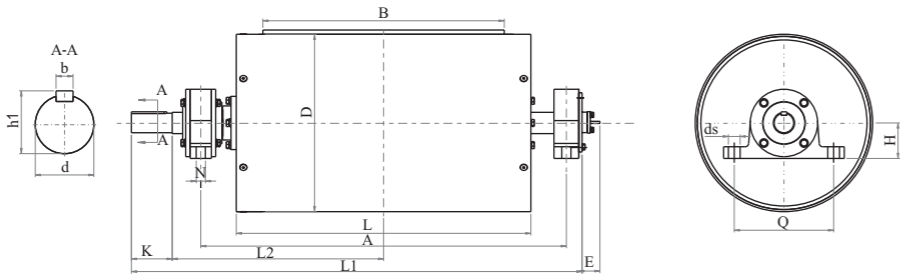

外形尺寸图 Overall Drawing

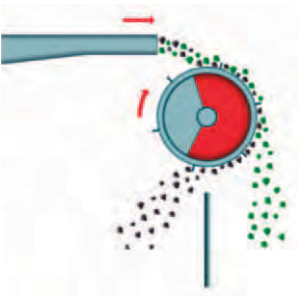

安装方式一 Installation Mode I

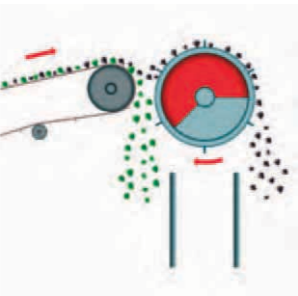

安装方式二 Installation Mode II

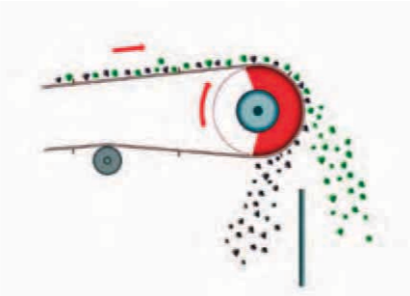

安装方式三 Installation Mode III

主要技术参数 Main Technical Data

型号 model (G1/G2/G3)	筒径 drum diameter D(mm)	适用带宽 applicable belt width B(mm)	筒长 drum length L(mm)	筒体表面 磁场强度 surface magnetic induction (GS)	选别粒度 separation granularity (≤mm)	处理量 handling capacity (≤t/h)	转速 rotate speed (r/min)	外形尺寸 overall dimension(mm)												质量 mass (kg)
								A	L1	L2	K	N	Q	H	h1	d	b	ds	E	
YG2-3240	315	400	500	1200	40	10	20 ~ 30	720	960	390	100	-	236	80	48.5	45	14	M16	50	260
YG2-3250	315	500	600	1200	40	16		850	1114	425	140	-	350	120	74.5	70	20	M20	50	355
YG2-4050	400	500	600	1350	40	20		850	1114	425	140	-	350	120	74.5	70	20	M20	50	450
YG2-5050	500	500	600	1500	40	30		850	1114	495	140	-	350	120	74.5	70	20	M20	50	570
YG2-3265	315	650	750	1200	40	20		1000	1264	570	140	-	350	120	74.5	70	20	M20	50	460
YG2-4065	400	650	750	1350	50	30		1000	1264	570	140	-	350	120	74.5	70	20	M20	50	590
YG2-5065	500	650	750	1500	50	40		1000	1264	570	140	-	350	120	74.5	70	20	M20	50	750
YG2-6365	630	650	750	1700	60	45		1000	1264	570	140	-	350	120	74.5	70	20	M20	50	980
YG2-4080	400	800	950	1350	50	45		1300	1624	740	170	-	380	135	95	90	25	M24	70	720
YG2-5080	500	800	950	1350	50	55		1300	1624	740	170	-	380	135	95	90	25	M24	70	890
YG2-6380	630	800	950	1500	60	65		1300	1624	740	170	-	380	135	95	90	25	M24	70	1150
YG2-8080	800	800	950	1700	80	80		1300	1624	740	170	-	380	135	95	90	25	M24	70	1650
YG2-63100	630	1000	1150	1800	80	100		1500	1824	880	170	-	380	135	95	90	25	M24	70	1350
YG2-80100	800	1000	1150	1800	80	120		1500	1869	840	210	-	440	155	116	110	28	M24	70	1950
YG2-100100	1000	1000	1150	1800	80	140		1500	1869	840	210	-	440	155	116	110	28	M24	70	2340
YG2-63120	630	1200	1400	1800	80	140		1750	2192	1015	210	-	440	155	116	110	28	M24	70	1750
YG2-80120	800	1200	1400	1800	80	160		1750	2192	1015	210	-	440	155	116	110	28	M24	70	2460
YG2-100120	100	1200	1400	1800	80	180		1750	2192	1015	210	-	440	155	116	110	28	M24	70	2520
YG2-80140	800	1400	1600	1800	80	190		2050	2475	1125	250	-	480	170	137	130	32	M30	80	2700
YG2-100140	1000	1400	1600	1800	80	220		2050	2475	1125	250	-	480	170	137	130	32	M30	80	3400
YG2-125140	1250	1400	1600	1800	80	250		2100	2489	1125	250	105	520	200	158	150	36	M30	80	4380
备 注 remark	筒表磁场强度另有G1=2500Gs、G2=3000Gs、G3=3500Gs产品，如您有特殊的要求，请提出，我们按您的要求设计。 G1-G3系列产品重量比表格中重量轻40%~30% The drum surface magnetic induction is also provided with G1=2500Gs,G2=3000Gs and G3=3500Gs. If you have special requirements, please let us know and we will design it specially to meet your demand. The weight of series G1 to G3 products is 40% ~30% lighter than the value listed in the table.																			

概述
General

RCD类系列电磁除铁器产品充分吸收德国、法国、日本等同类产品先进技术，居国内同类产品之领先地位，到目前已有二十多年的生产经验。可与皮带输送机、振动输送机、电磁振动给料机等各种输送机配套使用，它能从散状非磁性物料中清除块状为0.1–35kg的铁磁性物质，对提高物料品位、回收杂铁、保护各道工序设备起到了重要的作用。广泛应用于水泥、火力发电、冶金、矿山、陶瓷、化工、玻璃、造纸、建材、食品、烟草、煤炭等行业。可在各种恶劣环境中长期无故障运行。

Series RCD which has borrowed the relevant advanced technology from German, France, Japan and so on are lined in the leading products in China and has a rich experience of over 20 years so far. It can be combined with conveyers such as belt conveyer, vibration conveyer and electromagnetic vibration feeder and remove 0.1~35 kg materials, which plays an important role in improving the quality of material, recovery, and equipment protecting and can be put into operation in harsh working conditions with no fault occurs even after a rather long time running. This series is now widely applied in cement industry, thermal power industry, metallurgy industry, mine industry, ceramic industry, medical industry, glass industry, paper-making industry, building material industry, food industry, tobacco industry and ore industry, etc.

特点
Features

- 1. 经计算机优化设计，结构合理、能耗低、性能稳定可靠。
- 2. 磁场分布科学、合理、透磁深度大，吸力强。
- 3. 励磁线圈经特殊工艺处理，提高了线圈的电气和机械性能，温升低，绝缘、耐热性能好。
- 4. 安装、维护简便，使用寿命长。
- 5. 其各项技术指标均符合JB/T 7689–2004标准要求

- 1. Optimized design by computer, so the structure is reasonable, energy consumption is low, and the performance is stable.
- 2. Distribution of magnetic field is scientific and reasonable with a deep penetration and a strong attraction force
- 3. The excitation coils have gone through some special technical treatment, which improves the electrical and mechanical performance like low rise in temperature, insulated and good heat-resisting.
- 4. Installation is easy, maintenance is simple and service life is long.
- 5. Each technical data meets the standard JB/T 7689-2004.

型号说明
Model Designation



电磁除铁器
Electromagnetic Separator

RCDA系列风冷式电磁除铁器
Fan Cooling Electromagnetic Separator
Series RCDA

RCDA系列风冷式电磁除铁器内部采用空调风机强迫风冷、具有操作简单、使用方便等特点，适用环境条件较好的场合，用于破碎机前及输送机胶带上的任何物料除铁，对辊压机、破碎机、立磨等机械设备起着可靠的保护作用。

Series RCDA uses air-conditioner inside the separator to cool down the heat, featuring easy operation, user-friendly and so on and are suitable for working in good working conditions. They remove iron from materials at the front of the crusher or on the conveyer belt and can protect mechanical equipments like roll, crusher and muller.

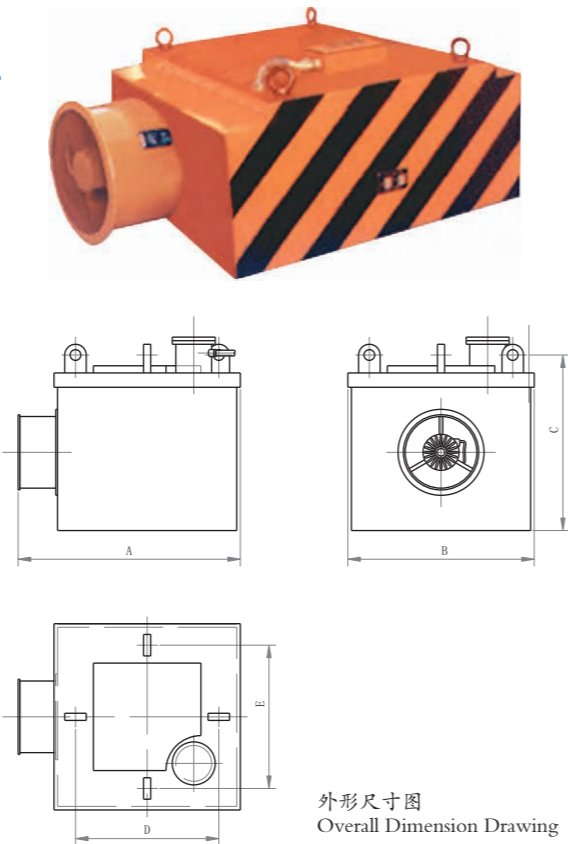

主要技术参数 Main Technical Data

型 号 model	适用带宽 applicable belt width E (mm)	悬挂高度 hanging height (< mm)	磁场强度 magnetic induction (≥mT)	物料厚度 material thickness (≤mm)	励磁功率 excitation power (≤kW)	风机功率 fan power (≤kW)	适应带速 applicable belt speed (≤m/s)	外形尺寸 overall dimension (mm)			悬挂尺寸 hanging size (mm)		质量 mass (kg)
								A	B	C	D	E	
RCDA-4	400	100	57	70	0.6	0.15	2.5	610	400	410	240	240	360
RCDA-5	500	150	65	100	1	0.15	2.5	710	500	480	340	340	440
RCDA-6	650	200	65	150	2	0.37	2.5	990	710	540	500	500	760
RCDA-8	800	250	68	200	4	0.37	2.5	1060	810	580	700	650	985
RCDA-10	1000	300	68	250	6	0.45	2.5	1460	1100	610	810	740	1330
RCDA-12	1200	350	68	300	9	0.45	2.5	1600	1300	670	1100	1040	1970
RCDA-14	1400	400	71	350	12	0.8	2.5	1910	1460	790	1300	1240	2860
RCDA-16	1600	450	71	400	15	0.8	2.5	2010	1660	845	1400	1360	3790
RCDA-18	1800	500	71	450	18	1.3	4.0	2360	1880	1060	1660	1600	4510
RCDA-20	2000	550	71	500	23	1.3	4.0	2560	2080	1240	1780	1700	6940
RCDA-22	2200	600	71	550	28	1.5	4.0	2840	2350	1580	2080	2000	8120

RCDB系列自冷悬挂式电磁除铁器
Natural Cooling Hanging Type
Electromagnetic Separator Series RCDB

RCDB系列自冷悬挂式电磁除铁器（亦称PDC盘式电磁除铁器）是一种用于清除粉状或块状非磁性物料中杂铁的除铁装置。

1. 磁路采用计算机模拟设计，透磁深度大，磁力强，磁场梯度高保证在工作距离内有最大吸力。
2. 外壳采用全密封钢板焊接，并严格进行气密性试验。同时线圈与外壳采用真空灌环氧树脂胶固定，在极其恶劣的环境中仍能可靠运行。
3. 采用自然冷却方式，无其他额外传热、导热设备的控制，减少了故障点。
4. 其主要性能指标均符合《JB/T7689-2004》标准要求，部分指标超过国家标准。该产品可除去混杂在非磁性物料中0.1-35kg的铁磁性物质，除铁率在95%以上。



Series RCDB, also named PDC disc type electromagnetic spearator, is used for removing iron from powdery or lumpy nonmagnetic material.

1. Magnetic circuit adopts computer simulation design, so it has a deep penetration strong magnetic force and high field gradient and can provide max attracting force.
2. The shell is welded by sealed steel plate and has gone through a strict test of air-proof. Meanwhile, a vacuum filling epoxy resin has been added between coil and shell to enable the equipment work well even in harsh working conditions.
3. Natural cooling mode is adopted which causes a less risk of fault occur
4. All tech data meet the standard JB/T7689-2004 and some are even beyond the national standard. The product can remove 0.1~35 kg materials from non-magnetic materials and the removing rate can up to 95% or more.

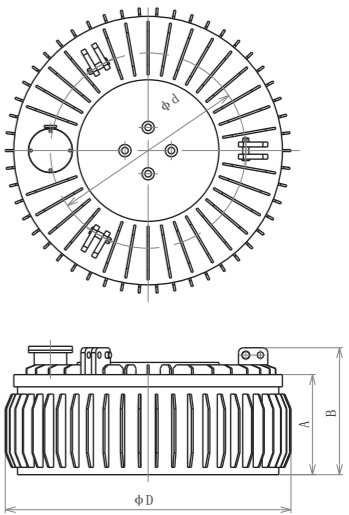

外形尺寸图 Overall Dimension Drawing

- 注：1. 可采用两台除铁器交替运行，断续励磁，基本上保持冷态工作，其吸力大而稳定。控制线路灵活，采用PLC编程控制，定时定点自动卸铁，并配有声光报警装置。
2. 可按用户要求，设置线圈测温装置；可选配称重装置，超过限定重量优先卸铁，并声光报警。

Note: 1. We advice you to use alternate separators and excitant them intermittently, so they can remain a cold-state working situation and thus have a strong and stable attraction force. The control circuit that adopts PLC program control is flexible and can not only discharge iron regularly but also has sound & light alarm.

2. Measuring equipment of coil temperature can be supplied to meet customers' requirement. So does weighing equipment, which can discharge over-weight iron first and give out alarm at the same time.

电磁除铁器
Electromagnetic Separator

主要技术参数 Main Technical Data

型 号 model	适用带宽 applicable belt width E (mm)	悬挂高度 hanging height (< mm)	磁场强度 magnetic induction (≥ mT)	物料厚度 material thickness (≤ mm)	励磁功率 excitation power (≤ kW)	适应带速 applicable belt speed (≤ m/s)	外形尺寸 overall dimension (mm)				质量 mass (kg)
							D	A	B	d	
RCDB-3	300	75	57	50	0.5	2.5	400	210	255	280	220
RCDB-4	400	100	57	70	1.3	2.5	500	240	280	400	280
RCDB-5	500	150	65	100	1.89	2.5	640	280	330	450	320
RCDB-6	650	200	65	150	2.84	2.5	760	280	330	600	720
RCDB-8	800	250	68	200	3.89	2.5	950	310	365	780	960
RCDB-10	1000	300	68	250	6.2	2.5	1200	318	370	900	1490
RCDB-12	1200	350	68	300	8.2	2.5	1350	320	372	1000	2340
RCDB-14	1400	400	71	350	11.6	2.5	1650	405	485	1400	3420
RCDB-16	1600	450	71	400	14.5	2.5	1800	460	540	1600	4900
RCDB-18	1800	500	71	450	17.9	4.0	2100	530	610	1750	6290
RCDB-20	2000	550	71	500	27	4.0	2400	605	685	2100	8700
RCDB-22	2200	600	71	550	31	4.0	2700	760	850	2400	10500

RCDE系列油冷式电磁除铁器
Oil Cooling Type Electromagnetic
Separator Series RCDE

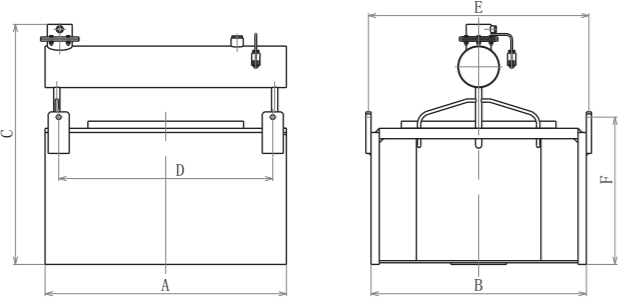

外形尺寸图 Overall Dimension Drawing

RCDE系列油冷式电磁除铁器，内部采用九十年代国际变压器先进技术，变压器油循环冷却，全密封结构，具有磁力大、防尘、防雨、耐腐蚀、连续工作使用寿命长等特点，对辊压机、破碎机等机械设备起着可靠的保护作用。

其主要性能指标均达到或高于JB/T7689-2004标准要求，该产品可除去混杂在非磁性物料中0.1-35kg的铁磁性物质。

Series RCDE borrowed advanced international technology of 1990s on transformer, which adopts oil cooling and fully sealed structure, featuring strong magnetic force, dust-proof, rain-proof, corrosion resistance, long service life on continuous duty, etc., It can protect mechanical equipments well like mill, crusher.

Every tech data has reached or exceeded the standard JB/T7689-2004.This series can remove 0.1~35 kg materials.



主要技术参数 Main Technical Data

型 号 model	适用带宽 applicable belt width (mm)	悬挂高度 hanging height h(mm)	磁场强度 magnetic induction (≥ mT)	物料厚度 material thickness (≤ mm)	励磁功率 excitation power (≤ kW)	适应带速 applicable belt speed (≤ m/s)	外形尺寸 overall dimension (mm)			悬挂尺寸 hanging size (mm)		质量 mass (kg)
							A	B	C	D	E	
RCDE-4	400	100	57	70	0.6	2.5	420	400	550	400	400	300
RCDE-5	500	150	65	100	1	2.5	550	500	600	500	500	500
RCDE-6	650	200	65	150	1.6	2.5	730	710	600	710	710	750
RCDE-8	800	250	68	200	3	2.5	850	810	850	810	810	1140
RCDE-10	1000	300	68	250	4.5	2.5	1110	1100	910	1100	1100	1420
RCDE-12	1200	350	68	300	6	2.5	1310	1300	1010	1300	1300	2785
RCDE-14	1400	400	71	350	8.5	2.5	1500	1460	1150	1460	1460	4230
RCDE-16	1600	450	71	400	12.6	2.5	1720	1660	1300	1660	1660	5700
RCDE-18	1800	500	71	450	18	4.0	1950	1880	1600	1880	1880	7300
RCDE-20	2000	550	71	500	22	4.0	2100	2080	1920	2080	2080	8570
RCDE-22	2200	600	71	550	27	4.0	2500	2350	2230	2350	2350	10500

注：倾斜式安装订货时请注明倾斜角度。 Note: Please let us know the inclination angle when ordering an incline type.

RCDC系列风冷带式电磁除铁器
Fan Cooling Belt Type Electromagnetic Separator Series RCDC

RCDC系列风冷带式电磁除铁器，是在RCDA系列风冷式电磁除铁器的基础上增加了驱动电机、滚筒、台架、带刮板的卸铁胶带等组成的卸铁机构。在工作过程中卸铁机构自动将卸铁皮带上吸附的铁磁性物质抛到除铁器以外的集铁箱内，无需停电人工清理，实现了除铁自动化。

在钢铁厂、水泥厂多用于矿渣除铁和保护辊压机、立磨、破碎机等重要设备。

Series RCDC adds iron discharge unit which composes of driving motor, roll, stand and iron discharging belt with scraper on the basis of series RCDA (fan cooling type). During working, the iron discharge unit will auto throw away the iron materials which have been attracted onto the belt into the iron collecting box, you can remove them from the box manually with no need of cutting off the power.

This series is used for removing slag in steel and cement plant and protecting some important equipment like mill, muller, and rusher.

主要技术参数 Main Technical Data

型 号 model	适用带宽 applicable belt width E (mm)	悬挂高度 hanging height T (mm)	磁场强度 magnetic induction (≥ mT)	物料厚度 material thickness (≤ mm)	适应带速 applicable belt speed (≤ m/s)	励磁功率 excitation power (≤ kW)	风机功率 fan power (≤ kW)	驱动功率 driving power (kW)	外形尺寸 overall dimension (mm)			悬挂尺寸 hanging size (mm)		质量 mass (kg)
									A	B	H	C	D	
RCDC-4	400	100	65	70	4.5	0.6	0.15	1.5	1780	800	705	570	620	900
RCDC-5	500	150		100		1	0.15	1.5	1900	1008	730	646	704	1090
RCDC-6	650	200		150		2	0.37	2.2	2010	1145	730	770	874	1410

电磁除铁器
Electromagnetic Separator

RCDC-8	800	250	68	200	4.5	4	0.37	3.0	2750	1360	740	1100	1110	1790
RCDC-10	1000	300		250		6	0.45	3.0	2900	1600	815	1400	1380	2450
RCDC-12	1200	350		300		9	0.45	4.0	3200	1733	835	1500	1535	3550
RCDC-14	1400	400	71	350		12	0.8	4.0	3300	1890	900	1520	1675	4720
RCDC-16	1600	450		400		15	0.8	5.5	3350	2160	915	1980	1850	6700
RCDC-18	1800	500		450		18	1.3	7.5	3580	2450	1020	2150	2120	9150
RCDC-20	2000	550	72	500		23	1.3	7.5	3900	2700	1020	2180	2410	11700
RCDC-22	2200	600		550		28	1.5	11	4200	2810	1050	2410	2530	14500

RCDD系列自冷带式电磁除铁器
Natural Cooling Belt Type
Electromagnetic Separator Series RCDD



本系列除铁器为长期工作制的自冷带式电磁除铁器，设计了台架、滚筒、卸铁皮带等部件，悬挂在带式输送机上方，通过卸铁皮带运转，可不断地自动将电磁铁吸上来的铁磁性异物抛进集铁箱，达到自动卸铁目的。

该系列除铁器适合于从较厚料层和较大粒度矿石、煤炭、焦炭、石灰石等铁质较多的场合中除去铁磁性异物。

This series is of long work shift hanging over belt conveyer. Some parts like stand, roll, and iron discharging belt are available. They can throw away the iron materials continuously which have been attracted into iron collecting box.

They are suitable for removing iron magnetic foreign articles from materials of thicker bed and bigger granularity that are rich in iron like ores, coal, and hard coke.

主要技术参数 Main Technical Data

型号 model	适用 带宽 applicable belt width E (mm)	悬挂 高度 hanging height T (mm)	磁场 强度 magnetic induction (≥mT)	物料 厚度 material thickness (≤mm)	适应 带速 applicable belt speed (≤m/s)	励磁 功率 excitation power (kW)	驱动 功率 driving power (kW)	外形尺寸 overall dimension (mm)			悬挂尺寸 hanging size (mm)		质量 mass (kg)
								A	B	H	C	D	
RCDD-4	400	100	65	70	4.5	1.3	1.5	1780	800	705	570	620	810
RCDD-5	500	150		100		1.89	1.5	1900	1008	730	646	704	970
RCDD-6	650	200		150		2.84	2.2	2010	1145	730	770	874	1370
RCDD-8	800	250	68	200		3.9	3.0	2750	1360	740	1100	1110	1760
RCDD-10	1000	300		250		6.2	3.0	2900	1600	815	1400	1380	2380
RCDD-12	1200	350		300		8.2	4.0	3200	1733	835	1500	1535	3450

RCDD-14	1400	400	71	350	4.5	11.6	4.0	3300	1890	900	1520	1675	4560
RCDD-16	1600	450		400		14.5	5.5	3350	2160	915	1980	1850	6350
RCDD-18	1800	500		450		17.9	7.5	3580	2450	1020	2150	2120	8700
RCDD-20	2000	550	72	500		27	7.5	3900	2700	1020	2180	2410	11200
RCDD-22	2200	600		550		31	11	4200	2810	1050	2410	2530	14200

RCDD-□-10系列自冷带式节能型电磁除铁器
Natural Cooling Belt type
Energy-economized Elelctromagnet Series RCDD-□-10

本系列的除铁器与金属探测器并用。只有当金属探测器发出信号时，除铁器才工作，除去混入的铁件。所以大大节约了能源。电磁铁设计成短时间工作制，强励磁工作，磁势大，因此与连续工作制的相比较，除净能力大，适应于含铁较少且要求除净率较高的场合。

This series ask for a combination with metal detector. The separator won't work until the metal detector sends a signal. In that case, energy gets saved a lot. Designed as a short term shift, they have strong excitation and compared with those on continuous duty, their capacity of iron-removing is more powerful, which are thus suitable for high demand of removing iron while the iron-content is not much.

主要技术参数 Main Technical Data

型 号 model	适用 带宽 applicable belt width E (mm)	悬挂 高度 hanging height T (mm)	磁场 强度 magnetic induction (≥mT)	物料 厚度 material thickness (≤mm)	适应 带速 applicable belt speed (≤m/s)	励磁 功率 exctiation power (kW)	驱动 功率 driving power (kW)	外形尺寸 overall dimension (mm)			悬挂尺寸 hanging size (mm)		质量 mass (kg)
								A	B	H	C	D	
RCDD-4-10	400	100	1200	70	4.5	5.2	1.5	1780	800	705	570	620	680
RCDD-5-10	500	150		100		7.5	1.5	1900	1008	730	646	704	850
RCDD-6-10	650	200		150		11.5	2.2	2010	1145	730	770	874	1100
RCDD-8-10	800	250		200		15.5	3.0	2750	1360	740	1100	1110	1400
RCDD-10-10	1000	300		250		24.0	3.0	2900	1600	815	1400	1380	1880
RCDD-12-10	1200	350		300		27.5	4.0	3200	1733	835	1500	1535	2730
RCDD-14-10	1400	400		350		38.5	4.0	3300	1890	900	1520	1675	450
RCDD-16-10	1600	450		400		41.5	5.5	3350	2160	915	1980	1850	4860
RCDD-18-10	1800	500		450		51.0	7.5	3580	2450	1020	2150	2120	6700
RCDD-20-10	2000	550		500		67.5	7.5	3900	2700	1020	2180	2410	8150
RCDD-22-10	2200	600		550		78.5	11	4200	2810	1050	2410	2530	10700

电磁除铁器
Electromagnetic Separator

RCDF系列油冷自卸式电磁除铁器
Oil Cooling Type Auto Discharging
Electromagnetic Separator Series RCDF

RCDF系列油冷带式电磁除铁器是在RCDE系列油冷式电磁除铁器的基础上增加了驱动电机、滚筒、带刮板的卸铁胶带等组成的卸铁机构。具有磁力大、散热快、防尘、防雨、耐腐蚀、连续工作、维护费用低等优点。问世以来，以操作使用方便，故障率低、维护量小等特点赢得了广大用户的好评。



Series RCDF adds iron discharge unit which composes of driving motor, roll and iron discharging belt with scraper on the basis of series RCDE(oil cooling), featuring strong magnetic force, fast heat-dispersion, dust-proof, rain-proof, corrosion resistance, continuous duty, low maintenance cost, etc., They have won a lot of compliment for user-friendly operation, low failure, little maintenance .

注：倾斜式安装订货时应注明倾斜角度。
Note: Please let us know the inclination angle when ordering an incline type.

主要技术参数 Main Technical Data

型 号 model	适用 带宽 applicable belt width E (mm)	悬挂 高度 hanging height T (mm)	磁场 强度 magnetic induction (≥mT)	物料 厚度 material thickness (≤mm)	适应 带速 applicable belt speed (≤m/s)	励磁 功率 excitation power (kW)	驱动 功率 driving power (kW)	外形尺寸 overall dimension (mm)			悬挂尺寸 hanging size (mm)		质量 mass (kg)
								A	B	H	C	D	
RCDF-4	400	100	70	70	4.5	0.6	1.5	1780	800	705	570	620	890
RCDF-5	500	150		100		1	1.5	1900	1008	730	646	704	1050
RCDF-6	650	200		150		1.6	2.2	2010	1145	730	770	874	1400
RCDF-8	800	250	68	200		3	3.0	2750	1360	740	1100	1110	1780
RCDF-10	1000	300		250		4.5	3.0	2900	1600	815	1400	1380	2430
RCDF-12	1200	350		300		6	4.0	3200	1733	835	1500	1535	3510
RCDF-14	1400	400	71	350		8.5	4.0	3300	1890	900	1520	1675	4750
RCDF-16	1600	450		400		12.6	5.5	3350	2160	915	1980	1850	6750
RCDF-18	1800	500		450		18	7.5	3580	2450	1020	2150	2120	9180
RCDF-20	2000	550	72	500		22	7.5	3900	2700	1020	2180	2410	11700
RCDF-22	2200	600		550		27	11	4200	2810	1050	2410	2530	14500

RCDP系列矿石自动回收式电磁除铁器
Auto Ore-Recovery Type Electromagnetic
Separator Series RCDP



本系列除铁器是为专门除去含在磁性矿石中的有害铁件而设计的，其工作制为10%。使用时，悬挂在皮带输送机上方的中部，并配以电动小车、金属探测器，采用PC控制程控整流设备，经检测、吸料、分选、除铁、回收等程序，从输送的磁性矿石中除去有害的铁件，同时将被吸的磁性矿石又自动地返回输送皮带上得到回收。适用于除去各种磁铁矿、烧结矿、球团矿中的铁磁性异物。若矿石中还含有非磁性铁件（高锰钢），宜在除铁器后部再布置一台金属探测器经检测，报警、定位，停机后人工捡除。

This series is specially designed for removing harmful iron pieces from magnetic ores with 10% duty shift. Hanged over the conveyer belt and combined with motor trolley and metal detector, they can remove and later return iron which has been attracted to the belt for recovering after going through some steps like detecting, attracting, selecting, removing, recovering, etc., with the help of PC program control equipment. They are suitable for removing material from magnetite, sintered ores and ball ores. When non-magnetic iron pieces exist in the ores (like high manganese steel), Please set another metal detector at the tail of the separator, through detecting, warning, locating, thus the iron pieces will be removed manually after stopping the equipment.

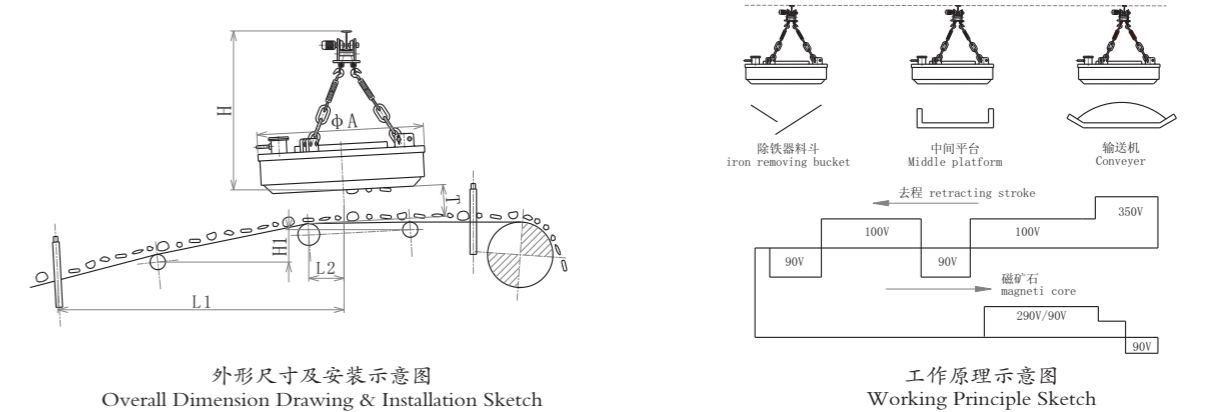

外形尺寸及安装示意图
Overall Dimension Drawing & Installation Sketch
注：L1、L2根据现场确定。H1参考值：50~120mm。
Note: L1, L2 will be decided according to the situation on the site. H1: 50-120mm (for reference)

主要技术参数（通电持续率10%）Main Technical Data (duty cycle 10%)

型 号 model	适用带宽 applicable belt width (mm)	悬挂高度 hanging height (mm)	物料厚度 material thickness (≤mm)	额定电压 rated voltage (V)	励磁功率 excitation power (≤kW)	适应带速 applicable belt speed (≤m/s)	外形尺寸 overall dimension (mm)		质量 mass (kg)
							A	H	
RCDP-5	500	150	100	DC- 350/290/100	7.4/5.1/0.6	2.5	600	850	420
RCDP-6	650	200	150		14/9.8/1.15		800	1000	521
RCDP-8	800	250	200		17.4/12/1.4		900	950	648
RCDP-10	1000	300	250		32/21/2.53		1200	1080	1193
RCDP-12	1200	350	300		43/29.8/3.54		1300	1190	2258
RCDP-14	1400	400	350		55/37.7/4.5	4.0	1500	1790	3122
RCDP-16	1600	450	400		64/44.5/5.3		1800	1630	3802
RCDP-18	1800	500	450		99/66/7.9		2100	1730	5813
RCDP-20	2000	550	500		118/81/9.7		2400	1850	6900

注：1、冷态励磁功率中的三个功率值，表示不同电压下的功耗。 2、行走装置及轨道相关参数参照除铁器附件中除铁器安装相关内容。 3、磁性物料中选铁有多种方案，建议选型前咨询我公司技术人员。
Note: 1. In cold state, excitation power has three values which stand for power-consumption at different voltage. 2. Please refer to Separator Accessories which contains data of railway and running gear 3. Please consult with our technicians to get the most suitable type.

电磁除铁器
Electromagnetic Separator

RCDPS系列矿石回收式带式电磁除铁器
Ore-Recovery Belt Type Electromagnetic Separator Series RCDPS



磁性矿带式电磁除铁器，采用复合磁场结构，以连续工作原理，将磁性矿中的铁件除掉。它实现了集吸铁、铁矿分离、矿石回收、弃铁于一体的功能。其工作原理如下：当输送带的金属探测仪

探测到铁件通过时，金属探测仪立即发出信号给程序控制柜，则此时程序控制柜对电磁除铁器进行强励磁，当铁件到达除铁器下方则被强大的磁力吸上来，同时此时磁场较强则将一些矿石不可避免地带来；同时带式除铁器卸料皮带连续工作，将吸取的物料搬运至弱磁场区域。在弱磁场区域由于磁性矿与铁件的磁性差异，磁性矿不被吸住而掉入输送皮带上而被回收，铁件继续被搬运至无磁区以一定的速度抛入卸铁箱中。与RCDP系列显著的区别在于此系列可连续工作，不会因除铁而引起系统生产的停止。由于除铁器与输料皮带采用水平面布置，无需RCDP的中间平台等，故占用空间少。

适用于除去各种磁铁矿、烧结矿、球团矿中的铁磁性异物。若矿石中还含有非磁性铁件（高锰钢），宜在除铁器后部再布置一台金属探测仪经检测，报警、定位，停机后人工捡除。

Series RCDPS which can work continuously removes iron pieces from magnetic ores by the structure of compounded magnetic field. Their functions include attracting, separating iron from ores, recovering and discharging with the principle as follows: when detecting passing iron pieces, the metal detector will send a signal at once to program control unit, which thus produce a strong excitation and then will attract the iron pieces which have reached the bottom of the separator, while at the same time some ores will be attracted inevitably as well. Both of them will be sent to the weak area where magnetic ores can not be attracted and will drop down onto the conveyer belt for the second recovery, while the iron pieces will go on moving to collecting box finally. Compared to series RCDP, this series can work continuously and we don't need to stop it when removing iron pieces. What's more, they don't need junction platform, as RCDP requires, so they occupy less space owing to the horizontal setting of separator and the belt.

They are suitable for removing iron magnetic materials from magnetite, sintered ores and ball ores. When non-magnetic iron pieces exist in the ores (like high manganese steel), Please set another metal detector at the tail of the separator, through detecting, warning, locating, thus the iron pieces can be removed manually after stopping the equipment.

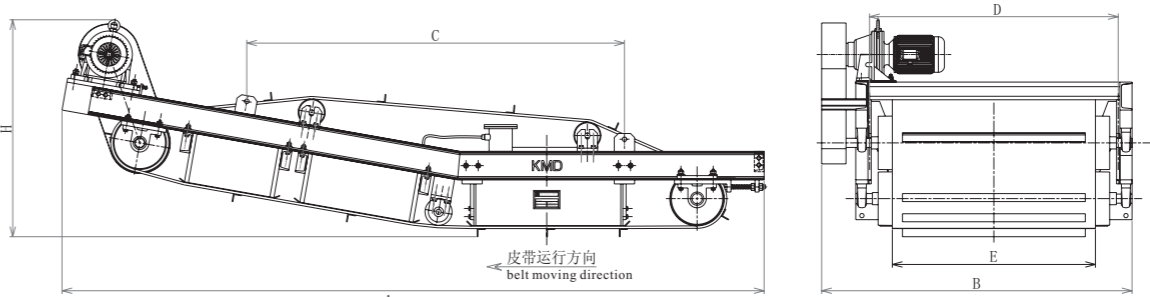

外形简图 Dimensional Sketch

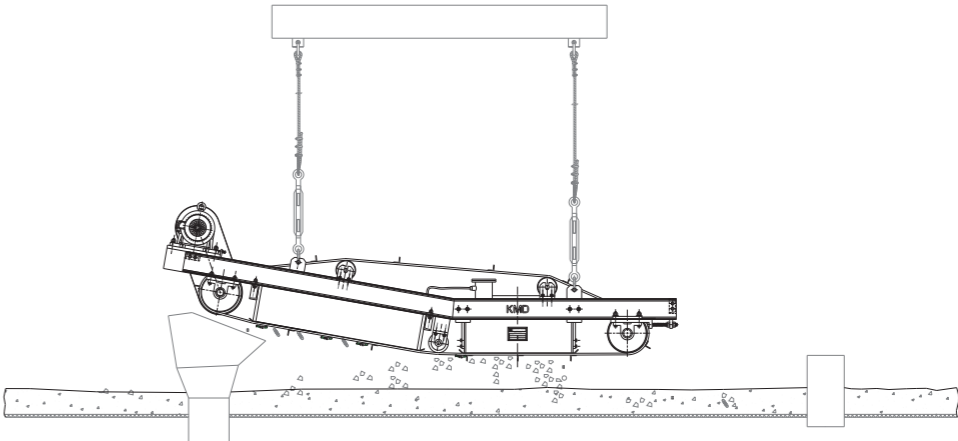

工作原理示意图 Working Principle Sketch

主要技术参数（通电持续率10%） Main Technical Data (duty cycle 10%)

型 号 model	适用带宽 applicable belt width E(mm)	悬挂高度 hanging height (mm)	物料厚度 material thickness (≤mm)	额定电压 rated voltage (V)	励磁功率 excitation power (kW)	适应带速 applicable belt speed (≤m/s)	外形尺寸 overall dimension (mm)					质量 mass (kg)
							A	B	C	D	H	
RCDPS-5	500	150	100	DC 0~220 / 0~290	0.8~12	2.5	3150	740	1570	550	950	1350
RCDPS-6	650	200	150		1.2~18.1		3400	1010	1650	630	980	2130
RCDPS-8	800	250	200		1.5~24.7		3960	1170	1740	890	1270	2780
RCDPS-10	1000	300	250		2~30.2		4200	1380	1860	1000	1320	3450
RCDPS-12	1200	350	300		2.3~40.8	4.0	4960	1560	2450	1260	1430	4870
RCDPS-14	1400	400	350		3.6~55		5250	1780	1940	1450	1560	5860
RCDPS-16	1600	450	400		5.1~77		5400	1850	2280	1560	1690	7100
RCDPS-18	1800	500	450		6.3~95		5650	2110	2600	1880	1780	7700
RCDPS-20	2000	550	500		7.9~120		5900	2360	2860	1970	1880	8500
RCDPS-22	2200	600	550		9.5~130		6150	2580	3050	2100	2300	12000

CF(L)系列电磁除铁器
Electromagnetic Separator Series CF(L)

CF、CFL系列电磁除铁器，是国内使用最早，亦是目前使用量较多的除铁设备之一，一直以操作方便、性能稳定可靠、价格合理、维修率低，深得用户的信赖，全封闭的多工作磁极磁路结构，是恶劣工作环境中除铁的常用设备。可与RCDB系列盘式电磁除铁器通用。该系列产品由于采用计算机辅助设计优化改进了原来的产品结构，其技术参数达到了国外同类产品的先进水平。



Series CF, CFL are currently one of the earliest and widest used separator in China for the good advantages of convenient operation, stable performance, reasonable price and low maintenance. This series adopts structure of multi magnetic pole & circuit and is usually used in harsh working conditions. They can be combined with series RCDY (disk type). Optimized by computer, their tech data have reached the advance level in the world.

主要技术参数 Main Technical Data

型 号 model	适用带宽 applicable belt width E (mm)	悬挂高度 hanging height (mm)	励磁功率 excitation power (≤kW)	适应带速 applicable belt speed (≤m/s)	外形尺寸 overall dimension (mm)				质量 mass (kg)
					A	B	C	H	
CF-60	650	150	1.29	2.5	930	710	380	1350	920
CFL-60	650	150	1.29		950	728	400	1380	715
CF-90	800	200	1.83		1025	780	420	1380	1625
CFL-90	800	200	1.83		1050	800	435	1400	1360
CF-130	1000	250	3.5		1250	800	480	1420	3550
CFL-130	1000	250	3.5		1280	825	500	1450	2838

注：CF表示铜芯绕组，CFL表示铝芯绕组
Note: CF stands for winding of copper; CFL stands for winding of aluminum.

ML1电磁轮（全磁）
ML1 Electromagnetic Wheel
(Full Magnetic Power)

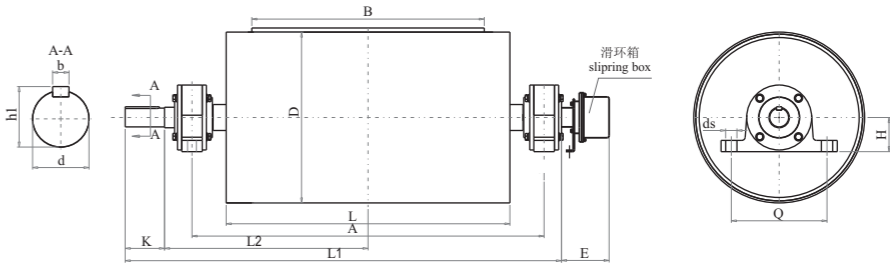
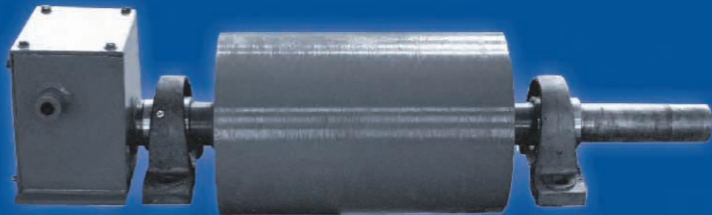

外形尺寸图 Overall Dimension Drawing

主要技术参数 Main Technical Data

型号 model	筒径 drum diameter D(mm)	适用带宽 applicable belt width B(mm)	处理量 handling capacity (≤t/h)	标准速度 standard speed(m/ min)	冷态功率 cold- state power (kW)	外形尺寸 overall dimension(mm)												质量 mass (kg)
						A	L	L1	L2	K	Q	H	h1	d	b	ds	E	
ML1-4550L	450	500	75	60	0.9	850	600	1114	425	140	350	120	74.5	70	20	M20	200	500
ML1-5050L	500	500	75	60	0.88	850	600	1114	495	140	350	120	74.5	70	20	M20	200	556
ML1-5065L	500	650	95	60	1.57	1000	750	1264	570	140	350	120	74.5	70	20	M20	200	630
ML1-6365L	630	650	100	80	1.57	1000	750	1264	570	140	350	120	74.5	70	20	M20	200	1000
ML1-5080L	500	800	120	60	1.8	1300	950	1624	740	170	380	135	95	90	25	M24	200	790
ML1-6380L	630	800	215	60	2.4	1300	950	1624	740	170	380	135	95	90	25	M24	200	1400
ML1-63100L	630	1000	280	80	3.6	1500	1150	1824	880	170	380	135	95	90	25	M24	200	2000
ML1-80100L	800	1000	450	100	3.6	1500	1150	1869	840	210	440	155	116	110	28	M24	200	3200
ML1-100100L	1000	1000	615	100	4.4	1500	1150	1869	840	210	440	155	116	110	28	M24	200	3250

MG2电磁轮（半磁）
MG2 Electromagnetic
Wheel (Half Magnetic Power)

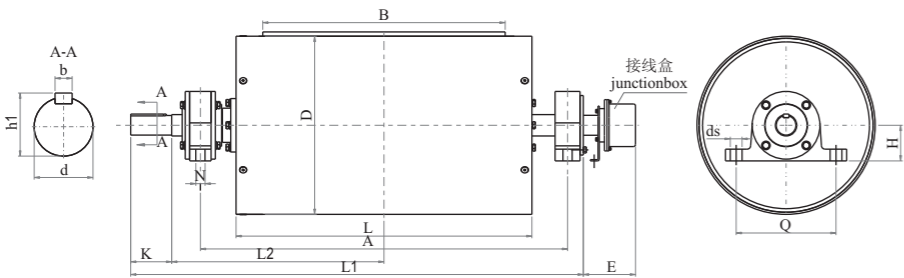

外形尺寸图
Overall Dimension Drawing

MG2系列半磁电磁辊多用于对粉状、颗粒状、小块状物料的净化处理及钢渣和矿石的磁选处理、或对铁质的回收利用，对防止破碎机、研磨机、压榨机的破坏和磨损起着可靠的保护作用。它安装方便、吸力强、无能耗、连续工作、操作简单。或根据TD-75型带式输送机标准设计，能满足广大用户对高场强、大深度除铁的使用要求。广泛应用于冶金、磁选、磨料磨具、金刚砂、非金属矿、耐火材料、矿山、食品、化工、玻璃、建材等行业。

Series MG2 which is usually suitable for purification treatment on powdery, grainy and small material, or iron recovery can protect crusher, miller and mill from damage or wear, featuring simple installation, strong attraction force, no energy consumption, continuous work and simple operation. This series which is designed as per the standard of series TD-75 can satisfy customer's need of high magnetic induction and deep removing and now are widely applied in metallurgy industry, abrasive industry, corundum industry, nonmetal ore industry, refractory industry, mine industry, food industry, building material industry and etc.

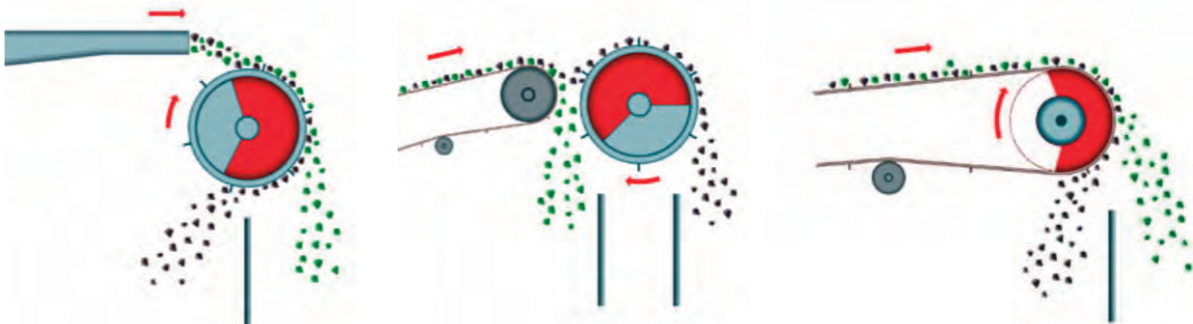

安装方式一
Installation Mode I

安装方式二
Installation Mode II

安装方式三
Installation Mode III

主要技术参数 Main Technical Data

型号 model	筒径 diameter D(mm)	适用 带宽 appla- ble belt width B(mm)	筒长 drum length L(mm)	筒体表面 磁场强度 surface magnetic induction (GS)	选别 粒度 separation granularity (≤mm)	处理量 handling capacity (≤t/h)	转速 rotate speed (r/min)	冷态 功率 cold- state power (kW)	外形尺寸 overall dimension(mm)												质量 mass (kg)
									A	L1	L2	K	N	Q	H	h1	d	b	ds	E	
MG2-3240	315	400	500	1200	40	10	20 ~ 30	0.6	720	960	390	100	-	236	80	48.5	45	14	M16	120	220
MG2-3250	315	500	600	1200	40	16		0.8	850	1114	425	140	-	350	120	74.5	70	20	M20	120	320
MG2-4050	400	500	600	1350	40	20		1.0	850	1114	425	140	-	350	120	74.5	70	20	M20	120	550
MG2-5050	500	500	600	1600	40	30		1.3	850	1114	495	140	-	350	120	74.5	70	20	M20	120	690
MG2-3265	315	650	750	1300	40	20		1.0	1000	1264	570	140	-	350	120	74.5	70	20	M20	120	440
MG2-4065	400	650	750	1550	50	30		1.2	1000	1264	570	140	-	350	120	74.5	70	20	M20	120	680
MG2-5065	500	650	750	1800	50	40		1.7	1000	1264	570	140	-	350	120	74.5	70	20	M20	120	850
MG2-6365	630	650	750	1800	60	45		2.4	1000	1264	570	140	-	350	120	74.5	70	20	M20	120	1300
MG2-4080	400	800	950	1550	50	55		1.5	1300	1624	740	170	-	380	135	95	90	25	M24	120	810
MG2-5080	500	800	950	1800	60	65		1.9	1300	1624	740	170	-	380	135	95	90	25	M24	120	980
MG2-6380	630	800	950	2000	80	80		2.7	1300	1624	740	170	-	380	135	95	90	25	M24	120	1500
MG2-8080	800	800	950	2000	80	100		3.1	1300	1624	740	170	-	380	135	95	90	25	M24	120	2000
MG2-63100	630	1000	1150	2000	80	120		3.3	1500	1824	880	170	-	380	135	95	90	25	M24	120	1850
MG2-80100	800	1000	1150	2000	80	140		3.7	1500	1869	840	210	-	440	155	116	110	28	M24	120	2400
MG2-63120	630	1200	1400	2000	80	140		3.9	1750	2192	1015	210	-	440	155	116	110	28	M24	120	2100
MG2-80120	800	1200	1400	2000	80	160		4.5	1750	2192	1015	210	-	440	155	116	110	28	M24	120	3100
MG2-100120	1000	1200	1400	2000	80	180		6.0	1750	2192	1015	210	-	440	155	116	110	28	M24	120	4750
MG2-80140	800	1400	1600	2000	80	190		5.2	2050	2475	1125	250	-	480	170	137	130	32	M30	120	3400
MG2-100140	1000	1400	1600	2000	80	220		7.0	2050	2475	1125	250	-	480	170	137	130	32	M30	120	5600
MG2-125140	1250	1400	1600	1800	80	250		8.9	2100	2489	1125	250	105	520	200	158	150	36	M30	120	8700

概述
General

随着我国经济的发展，各行各业对物料除杂的要求不断提高，对产品的物料品位也有了更高的要求，在一些特殊的场合，对物料中铁磁性物质的除净率要求很高，按国家标准生产的除铁器根本无法满足需要。鉴于此，我公司工程技术人员，精心研制了G1、G2、G3系列超强除铁器。超强除铁器按内部磁系的不同，分为电磁式和永磁式两种。

根据磁力学我们知道，对铁磁性物质的吸力不但与磁场强度有关，还与磁场的梯度有直接关系 $F=H \times \frac{aH}{aL}$ 。G1、G2、G3系列超强除铁器，具有磁场强、梯度高、透磁深、吸力大的特点。G1、G2、G3在额定吊高处的磁场强度分别为国标产品的1.6、2.4和3.2倍，达到900GS、1200GS和1500GS，额定吊高处的吸力分别为国标产品的2.3倍、4.4倍和7.6倍，对于超大铁件或细小铁件均具有良好的清除效果，特别适合于精煤的除铁、港口及码头输送物料的除铁、电厂中速磨、风扇磨前的除铁，以及除铁要求高的生产场所。

With the development of our national economy, the requirement for impurity removal is raised continuously in all trades, and higher material grade of product is needed. Therefore our engineers have developed super-strong separator series G1, G2 and G3 which have exceeded the national standard to meet the strict iron-removing demand applied in some special applications. Ranged from interior magnet, they are divided into 2 types: electromagnet and permanent magnet.

We know that attraction force has relationship with magnetic intensity and magnetic gradient. That is $F=H \times \frac{aH}{aL}$. Super-strong separator series G1, G2 and G3 have advantages of strong magnetic intensity, high gradient, deep penetration, strong attraction force, etc., At the set height, their magnetic intensity is 1.6, 2.4 and 3.2 times as strong as that of national standard products. That is 900GS, 1200GS and 1500GS respectively with attraction force 2.3, 4.4 and 7.6 times as big as that of the national standard products. They are superior in removing huge or tiny iron pieces, especially suitable for refined coal, port & dock, or before high speed grinding and fan grinding at electricity plants, or in other places where have strict demands of iron-removing.

RCYD-G系列带式强磁永磁除铁器
Belt Type Super-strong Permanent-magnetic
Separator Series RCYD-G



RCYD-G系列超强永磁带式除铁器，采用超强高牌号稀土永磁钕铁硼作为磁源，磁性能稳定，磁路设计独特，此除铁器磁力强、磁场梯度高，其主要性能指标均符合《JB/T 8711-1998》标准要求，大部分指标超过国家标准。该产品可除去混杂在非磁性物料中0.1—50Kg的铁磁性物质，吸力远大于国标除铁器；具有自动纠偏功能的腰鼓形滚筒，全密封铸钢轴承座，保证除铁器能在各种恶劣环境下长期无故障工作。其广泛应用于煤矿、码头、火力发电、水泥、建材等行业。拥有防爆型。

Series RCYD-G which uses rare earth Ne-Fe-B as magnetic source have met, some data are even beyond, the standard of JB/T 8711-1998 with the advantages of stable performance, unique circuit design, strong magnetic force and high gradient. This series can remove 0.1 to 50 kg iron material from non-magnetic ones with an attraction force much stronger than that of international separators. They have drum-shape rolls which are designed to rectify deviation automatically and full-sealed bear bases made by cast steel to ensure no fault occur when working in harsh working conditions for quite a long time. They are widely used in coal industry, port, power plant, cement industry, building industry and so on. We also have an anti-explosion type.

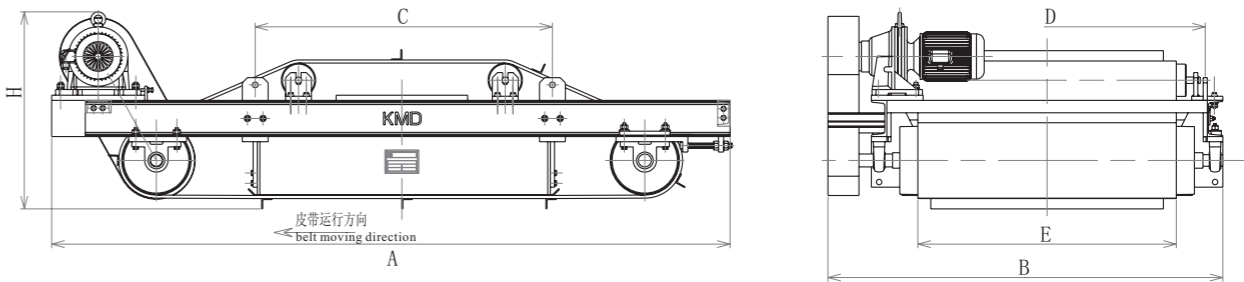

外形尺寸图
Overall Dimension Drawing

G系列强磁除铁器
Strong Magnetic Separator Series G

主要技术参数 Main Technical Data

型 号 model		适用带宽 applicable belt width E (mm)	额定悬 挂高度 rated hanging height(mm)	磁场强度 magnetic induction (mT)	外形尺寸 overall dimension (mm)			悬挂尺寸 hanging size (mm)		质量 mass (kg)	驱动电 机功率 motor power (kW)
					A	B	H	C	D		
RCYD-6	G1	650	200	90	2160	1075	795	920	890	1300	2.2
	G2			120	2160	1075	795	920	890	1420	2.2
	G3			150	2320	1075	795	920	890	1750	2.2
RCYD-8	G1	800	250	90	2350	1280	795	1110	1090	1920	2.2
	G2			120	2350	1280	795	1110	1090	2180	3.0
	G3			150	2550	1350	795	1110	1090	2820	3.0
RCYD-10	G1	1000	300	90	2680	1550	950	1350	1340	2350	3.0
	G2			120	2680	1550	950	1350	1340	2700	3.0
	G3			150	2760	1550	950	1350	1340	3680	4.0
RCYD-12	G1	1200	350	90	2900	1730	950	1500	1460	3250	4.0
	G2			120	2900	1730	970	1500	1460	4100	4.0
	G3			150	3100	1750	970	1500	1460	5150	5.5
RCYD-14	G1	1400	400	90	3200	1760	970	1780	1750	4800	4.0
	G2			120	3200	1760	970	1780	1750	5600	5.5
	G3			150	3350	1980	1180	1780	1750	7450	5.5
RCYD-16	G1	1600	450	90	3450	2210	1180	1950	1920	6200	5.5
	G2			120	3450	2210	1180	1950	1920	7750	5.5
	G3			150	3650	2210	1180	1950	1920	10380	7.5
RCYD-18	G1	1800	500	90	3820	2570	1180	2150	2180	8500	7.5
	G2			120	3820	2570	1180	2150	2180	10850	7.5
	G3			150	4050	2570	1250	2150	2180	14800	11.0
RCYD-20	G1	2000	550	90	4300	2670	1180	2450	2400	11500	7.5
	G2			120	4300	2670	1250	2450	2400	14270	11.0
	G3			150	4550	2670	1250	2450	2400	19260	11.0
RCYD-22	G1	2200	600	90	4820	2820	1250	2680	2650	13980	11.0
	G2			120	4820	2820	1250	2680	2650	18350	11.0
	G3			150	4820	2820	1350	2680	2650	25080	15.0
RCYD-24	G1	2400	650	90	5250	3180	1250	3100	2900	18760	15.0
	G2			120	5250	3180	1350	3100	2900	23870	15.0
	G3			150	5250	3180	1350	3100	2900	29960	15.0

RCDA-G系列风冷式强磁电磁除铁器
Fan cooling Type Super-strong Electromagnetic
Separator Series RCDA-G



Series RCDA uses air-conditioner inside the separator to cool down, featuring easy operation, and so on and are suitable for working in good working conditions. They remove iron from materials in the crusher or on the conveyer belt and can protect mechanical equipments like roll, crusher and muller.

RCDA-G系列风冷式电 磁除铁器内部采用空调
风机强迫风冷、具有操作简单、使用方便等特点，适
用环境条件较好的场合，用于破碎机前及输送机胶带
上的任何物料除铁，对辊压机、破碎机、立磨等机械
设备起着可靠的保护作用。

主要技术参数 Main Technical Data

型 号 model	适用 带宽 applicable belt width (Emm)	悬挂 高度 hanging height (< mm)	磁场 强度 magnetic induction (≥ mT)	物料 厚度 material thickness (≤ mm)	励磁 功率 excitation power (≤ kW)	风机 功率 fan power (≤ kW)	适应 带速 applicable belt speed (≤ m/s)	外形尺寸 overall dimension (mm)			悬挂尺寸 haning size (mm)		质量 mass (kg)
								A	B	C	D	E	
RCDA-5	G1	500	150	90	3.2	0.37	2.5	760	980	460	600	600	600
	G2			120	4.5	0.55		1050	1300	450	800	800	990
	G3			150	8.0	0.75		1250	1380	550	900	900	1850
RCDA-6	G1	650	200	90	4.5	0.55	2.5	1050	1300	450	800	800	1020
	G2			120	8.0	0.75		1250	1380	550	900	900	1850
	G3			150	10.5	0.75		1450	1480	600	1000	1000	2950
RCDA-8	G1	800	250	90	8.0	0.75	2.5	1250	1380	550	900	900	1800
	G2			120	11.0	0.75		1460	1480	600	1000	1000	2850
	G3			150	15	1.1		1600	1700	800	1200	1200	3620
RCDA-10	G1	1000	300	90	10.5	1.1	2.5	1450	1480	590	1000	1000	2870
	G2			120	15.5	1.1		1600	1700	800	1200	1200	3790
	G3			150	20	1.5		1800	1880	820	1350	1350	6100
RCDA-12	G1	1200	350	90	12.5	1.1	2.5	1600	1700	690	1200	1200	3880
	G2			120	19.5	1.5		1800	1880	790	1350	1350	6230
	G3			150	22	1.1×2		1850	1900	850	1450	1450	7780
RCDA-14	G1	1400	400	90	19.5	1.5	2.5	1820	1880	790	1350	1350	5790
	G2			120	22.5	0.75×2		1900	2120	750	1500	1500	6970
	G3			150	26	1.1×2		2200	2350	920	1700	1700	9790
RCDA-16	G1	1600	450	90	20	1.5	2.5	1900	2120	750	1500	1500	7100
	G2			120	29	1.1×2		2160	2250	830	1700	1700	9130
	G3			150	38	1.5×2		2400	2480	960	1700	1700	13100
RCDA-18	G1	1800	500	90	27	1.1×2	4.0	2170	2250	850	1700	1700	8670
	G2			120	33	1.5×2		2300	2400	950	1700	1700	11700
	G3			150	45	2.2×2		2680	2790	960	1800	1800	16500
RCDA-20	G1	2000	550	90	32	1.5×2	4.0	2300	2400	950	1700	1700	10300
	G2			120	39	2.2×2		2520	2650	960	1800	1800	16700
	G3			150	55	2.2×2		2800	2920	1020	1900	1900	22700
RCDA-22	G1	2200	600	90	38	1.5×2	4.0	2530	2670	950	1800	1800	14700
	G2			120	46	2.2×2		2700	2780	1020	1900	1900	21300
	G3			150	65	3.0×2		2990	3020	1100	2000	2000	26300

G系列强磁除铁器
Strong Magnetic Separator Series G

RCDE–G系列油冷式强磁电磁除铁器
Oil cooling Type Super-strong
Electromagnetic Separator Series RCDE-G

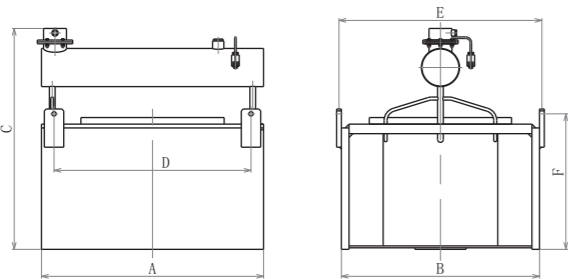

外形尺寸图 Overall Dimension Drawing



RCDE–G系列油冷式电磁除铁器，内部采用九十年代国际变压器先进技术，变压器油循环冷却，全密封结构，具有磁力大、防尘、防雨、耐腐蚀、连续工作使用寿命长等特点，对辊压机、破碎机等机械设备起着可靠的保护作用。

其主要性能指标均达到或高于JB/T7689–2004标准要求，该产品可除去混杂在非磁性物料中0.1–35kg的铁磁性物质。

Series RCDE-G adopts advanced international technology of 1990s on transformer, which adopts oil cooling and fully sealed structure, featuring strong magnetic force, dust-proof, rain-proof, corrosion resistance, long service life on continuous duty, etc.. It can protect mechanical equipments well like mill, crusher.

Each technical data has reached or exceeded the standard JB/T7689-2004.This series can remove 0.1~35 kg materials.

主要技术参数 Main Technical Data

型 号 model	适用 带宽 applicable belt width (mm)	悬挂 高度 hanging height (< mm)	磁场 强度 magnetic induction (≥ mT)	物料 厚度 material thickness (≤ mm)	励磁 功率 excitation power (≤ kW)	适应 带速 applicable belt speed (≤ m/s)	外形尺寸 overall dimension (mm)			悬挂尺寸 hanging size (mm)		质量 mass (kg)
							A	B	C	D	E	
RCDE-5	G1	500	150	90	2.5	2.5	760	740	860	760	740	630
	G2			120	4.0		1050	1030	880	1050	1030	1040
	G3			150	6.5		1250	1230	960	1250	1230	1940
RCDE-6	G1	650	200	90	4.0	2.5	1050	1030	880	1050	1030	1080
	G2			120	6.5		1250	1230	960	1250	1230	1960
	G3			150	9.0		1450	1400	1050	1450	1400	2120
RCDE-8	G1	800	250	90	6.5	2.5	1250	1230	1050	1250	1230	1890
	G2			120	9.0		1460	1420	1160	1460	1420	2000
	G3			150	13		1600	1550	1220	1600	1550	3810
RCDE-10	G1	1000	300	90	9	2.5	1450	1410	1100	1450	1410	3020
	G2			120	13		1600	1570	1180	1600	1570	3980
	G3			150	16.5		1800	1760	1280	1800	1760	6400

RCDE-12	G1	1200	350	90	300	11	2.5	1600	1580	1200	1600	1580	4020
	G2			120		16.0		1800	1770	1260	1800	1770	6520
	G3			150		20		1850	1820	1400	1850	1820	8130
RCDE-14	G1	1400	400	90	350	15.5	2.5	1820	1790	1300	1820	1790	6070
	G2			120		18		1900	1860	1390	1900	1860	7320
	G3			150		23		2200	2100	1520	2200	2100	10300
RCDE-16	G1	1600	450	90	400	17	2.5	1900	1860	1420	1900	1860	7450
	G2			120		23		2160	2100	1550	2160	2100	9580
	G3			150		32		2400	2350	1700	2400	2350	13700
RCDE-18	G1	1800	500	90	450	24.5	4.0	2170	2120	1600	2170	2120	9120
	G2			120		30		2300	2340	1750	2300	2340	12300
	G3			150		42		2680	2620	1920	2680	2620	17400

注：倾斜式安装订货时请注明倾斜角度。
Note: Please let us know the inclination angle when ordering an incline type.

RCDB–G系列自冷盘式强磁电磁除铁器
Nature cooling Disk Type Strong
Electromagnetic Separator Series RCDB-G



RCDB–G系列自冷悬挂式电磁除铁器(亦称PDC盘式电磁除铁器)是一种用于清除粉状或块状非磁性物料中杂质的除铁装置。

- 磁路采用计算机模拟设计，透磁深度大，磁力强，磁场梯度高保证在工作距离内有最大吸力。
- 外壳采用全密封钢板焊接，并严格进行气密性试验。同时线圈与外壳采用真空灌环氧树脂胶固定，在极其恶劣的环境中仍能可靠运行。
- 采用自然冷却方式，无其他额外传热、导热设备的控制，减少了故障点。
- 其主要性能指标均符合《JB/T7689–2004》标准要求，部分指标超过国家标准。该产品可除去混杂在非磁性物料中0.1—35kg的铁磁性物质，除铁率在95%以上。

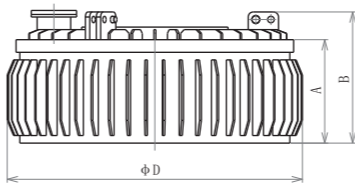
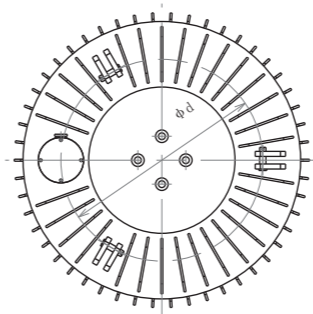

外形尺寸图
Overall Dimension Drawing

Series RCDB-G (also called PDC disk type electromangetic separator) is used for removing iron from powdery or lumpy nonmagnetic materials.

Magnetic circuit adopts computer simulation design, so it has a deep penetration strong magnetic force and high filed gradient and can provide the biggest attracting force.

The shell is welded by sealed steel plate and has gone through strict test of air-proof. Meanwhile, a vacuum filling epoxy resin has been added between coil and shell to enable the equipment work well even under harsh working conditions.

Natural cooling mode is adopted without the control of extra heat-transmission equipments, which causes a less risk of fault occur.

All tech data meet the standard JB/T7689-2004 and some are even beyond the national standard. The product can remove 0.1~35 kg materials from non-magnetic materials and the removing rate can up to 95% or more.

G系列强磁除铁器
Strong Magnetic Separator Series G

- 注：1. 可采用两台除铁器交替运行，断续励磁，基本上保持冷态工作，其吸力大而稳定。控制线路灵活，采用PLC编程控制，定时定点自动卸铁，并配有声光报警装置。
2. 可按用户要求，设置线圈测温装置；可选配称重装置，超过限定重量优先卸铁，并声光报警。

Note: 1. We advice you to use alternate separators and energize them intermittently, so they can remain a cold-state working situation and thus have a strong and stable attraction force. The control circuit that adopts PLC control is flexible and can not only discharge iron regularly but also has sound&light alarm.

2. Measuring equipment of coil temperature can be supplied to meet customers' requirement. So does weighing equipment, which can discharge over-weight iron first and give out alarm at the same time.

主要技术参数 Main Technical Data

型号 model	适用带宽 applicable belt width E (mm)	悬挂高度 hanging height (< mm)	磁场强度 magnetic induction (≥ mT)	物料厚度 material thickness (≤ mm)	励磁功率 excitation power (≤ kW)	适应带速 applicable belt speed (≤ m/s)	外形尺寸 overall dimension (mm)				质量 mass (kg)
							D	A	B	d	
RCDB-5	G1	500	150	100	2.9	2.5	760	380	460	500	620
	G2				4.0		950	350	450	600	970
	G3				7.0		1180	400	550	700	1790
RCDB-6	G1	650	200	150	4.0	2.5	960	350	450	600	980
	G2				7.0		1180	400	550	700	1750
	G3				9.2		1380	480	600	1250	2750
RCDB-8	G1	800	250	200	7.0	2.5	1180	400	550	950	1600
	G2				9.2		1390	480	600	1250	2680
	G3				14.0		1650	650	800	1450	3250
RCDB-10	G1	1000	300	250	9.0	2.5	1390	490	590	1050	2670
	G2				14.0		1600	650	800	1450	3650
	G3				18.5		1850	690	790	1650	5800
RCDB-12	G1	1200	350	300	11	2.5	1560	590	690	1400	3650
	G2				17.5		1860	690	780	1650	6080
	G3				20		1950	720	850	1800	7500
RCDB-14	G1	1400	400	350	17.5	2.5	1850	690	790	1650	5560
	G2				19.5		1900	690	750	1650	6600
	G3				24		2250	780	920	2000	9400
RCDB-16	G1	1600	450	400	18.5	2.5	1920	690	750	1650	6850
	G2				27		2150	720	830	1800	8840
	G3				36		2450	840	960	2100	12900
RCDB-18	G1	1800	500	450	26.5	4.0	2150	720	830	2100	8350
	G2				31		2300	820	950	2100	11000
	G3				44		2650	890	1020	2200	16500
RCDB-20	G1	2000	550	500	30	4.0	2300	820	950	2100	9500
	G2				37		2450	840	960	2100	15800
	G3				53		2750	890	1020	2300	21500
RCDB-22	G1	2200	600	550	34	4.0	2450	820	950	2100	13500
	G2				44		2650	890	1020	2200	19500
	G3				62		2950	930	1100	2400	24500

RCDC–G系列风冷带式强磁电磁除铁器

Fan Cooling Belt Type Strong Electromagnetic Separator Series RCDC-G

RCDC系列风冷带式电磁除铁器，是在RCDA系列风冷式电磁除铁器的基础上增加了驱动电机、滚筒、台架、带刮板的卸铁胶带等组成的卸铁机构。在工作过程中卸铁机构自动将卸铁皮带上吸附的铁磁性物质抛到除铁器以外的集铁箱内，无需停电人工清理，实现了除铁自动化。

在钢铁厂、水泥厂多用于矿渣除铁和保护辊压机、立磨、破碎机等重要设备。

Series RCDC adds iron discharge unit which composes of driving motor, roll, stand and belt with scraper on the basis of series RCDA (fan cooling type). During working, the iron discharge unit will auto throw away the iron materials which have been attracted to the belt into the iron collecting box, you can remove them from the box manually with no need of turning off the power.

This series is used for removing slag in steel and cement plant and protecting some important equipment like mill, muller, and rusher.

主要技术参数 Main Technical Data

型 号 model	适用带宽 applicable belt width E (mm)	悬挂高度 hanging height (< mm)	磁场强度 magnetic induction (≥ mT)	物料厚度 material thickness (≤ mm)	适应带速 applicable belt speed (≤ m/s)	励磁功率 excitation power (≤ kW)	风机功率 fan power (≤ kW)	驱动功率 driving power (kW)	外形尺寸 overall dimension (mm)			悬挂尺寸 hanging size (mm)		质量 mass (kg)
									A	B	H	C	D	
RCDC-5	G1	500	150	100	2.5	2.9	0.37	1.5	1900	1050	730	650	800	1050
	G2					4.0	0.55	1.5	2050	1380	730	950	1000	1590
	G3					7.0	0.75	2.2	2750	1550	740	1130	1280	2610
RCDC-6	G1	650	200	150	2.5	4.0	0.55	1.5	2050	1380	730	950	1000	1600
	G2					7.0	0.75	2.2	2750	1550	740	1130	1280	2580
	G3					9.2	0.75	2.2	2900	1720	820	1250	1450	3670
RCDC-8	G1	800	250	200	2.5	7.0	0.75	2.2	2750	1560	740	1130	1280	2390
	G2					9.2	0.75	2.2	2900	1760	820	1250	1450	3650
	G3					14.0	1.1	3.0	3200	1970	840	1580	1780	4230
RCDC-10	G1	1000	300	250	2.5	9.0	1.1	3.0	2900	1780	820	1250	1450	3570
	G2					14.0	1.1	3.0	3200	1990	840	1580	1780	4290
	G3					18.5	1.5	4	3500	2180	950	1700	1950	6620
RCDC-12	G1	1200	350	300	2.5	11	1.1	4	3200	1980	840	1580	1780	4550
	G2					17.5	1.5	4	3500	2190	950	1700	1950	7120
	G3					20	1.1×2	5.5	3700	2320	1050	1850	2050	8860
RCDC-14	G1	1400	400	350	2.5	17.5	1.5	4	3500	2200	950	1700	1950	7850
	G2					19.5	0.75×2	5.5	3700	2360	1050	1850	2050	7980
	G3					24	1.1×2	5.5	3900	2520	1100	2000	2200	10820
RCDC-16	G1	1600	450	400	2.5	18.5	1.5	5.5	3700	2370	1050	1850	2050	8020
	G2					27	1.1×2	5.5	3900	2550	1100	2000	2200	10990
	G3					36	1.5×2	7.5	4500	2730	1150	2150	2300	15700
RCDC-18	G1	1800	500	450	4.0	26.5	1.1×2	7.5	3900	2580	1100	2000	2200	10420
	G2					31	1.5×2	7.5	4500	2580	1150	2100	2300	14920
	G3					44	2.2×2	11	5200	2900	1200	2300	2450	19970
RCDC-20	G1	2000	550	500	4.0	30	1.5×2	7.5	4500	2700	1150	2100	2300	13920
	G2					37	2.2×2	11	5200	2780	1150	2150	2300	19920
	G3					53	2.2×2	11	5400	2970	1250	2250	2500	26200
RCDC-22	G1	2200	600	550	4.0	34	1.5×2	11	5200	2850	1150	2150	2300	18000
	G2					44	2.2×2	11	5400	2950	1250	2300	2450	23750
	G3					62	3.0×2	15	5800	3300	1350	2500	2800	29200

G系列强磁除铁器
Strong Magnetic Separator Series G

RCDF–G系列油冷带式强磁电磁除铁器

Oil Cooling Belt Type Strong
Electromagnetic Separator Series RCDF-G

RCDF系列油冷带式电磁除铁器是在RCDE系列油冷式电磁除铁器的基础上增加了驱动电机、滚筒、带刮板的卸铁胶带等组成的卸铁机构。具有磁力大、散热快、防尘、防雨、耐腐蚀、连续工作、维护费用低等优点。问世以来，以操作使用方便，故障率低、维护量小等特点赢得了广大用户的好评。

Series RCDF adds iron discharge unit which composes of driving motor, roll and discharge belt with scraper on the basis of series RCDE(oil cooling), featuring strong magnetic force, fast heat-dispersion, dust-proof, rain-proof, corrosion resistance, continuous duty, low maintenance cost, etc., They have won a lot of compliment for user-friendly operation, low failure and little maintenance .

注：倾斜式安装订货时应注明倾斜角度。
Note: Please let us know the inclination angle when ordering an incline type.

主要技术参数 Main Technical Data

型 号 model	适用 带宽 applicable belt width E (mm)	悬挂 高度 hanging height (< mm)	磁场 强度 magnetic induction (≥mT)	物料 厚度 material thickness (≤mm)	适应 带速 applicable belt speed (≤m/s)	励磁 功率 excitation power (≤kW)	驱动 功率 driving power (kW)	外形尺寸 overall dimension (mm)			悬挂尺寸 hanging size (mm)		质量 mass (kg)
								A	B	H	C	D	
RCDF-5	G1	500	90	100	2.5	2.5	1.5	1900	950	860	650	800	1090
	G2		120			4.0	1.5	2050	1250	880	950	1000	1640
	G3		150			6.5	2.2	2750	1400	960	1130	1280	2720
RCDF-6	G1	650	90	150	2.5	4.0	1.5	2050	1250	880	950	1000	1680
	G2		120			6.5	2.2	2750	1400	960	1130	1280	2690
	G3		150			9.0	2.2	2900	1550	1050	1250	1450	3850
RCDF-8	G1	800	90	200	2.5	6.5	2.2	2750	1400	1050	1130	1280	2490
	G2		120			9.0	2.2	2900	1550	1160	1250	1450	3800
	G3		150			13	3.0	3200	1750	1220	1580	1780	4420
RCDF-10	G1	1000	90	250	2.5	9	3.0	2900	1550	1100	1250	1450	3720
	G2		120			13	3.0	3200	1750	1180	1580	1780	4480
	G3		150			16.5	4	3500	1950	1280	1700	1950	7150
RCDF-12	G1	1200	90	300	2.5	11	4	3200	1750	1200	1580	1780	4750
	G2		120			16.0	4	3500	1950	1260	1700	1950	7450
	G3		150			20	5.5	3700	2100	1400	1850	2050	9120
RCDF-14	G1	1400	90	350	2.5	15.5	4	3500	1950	1300	1700	1950	8110
	G2		120			18	5.5	3700	2100	1390	1850	2050	8320
	G3		150			23	5.5	3900	2250	1520	2000	2200	11350
RCDF-16	G1	1600	90	400	2.5	17	5.5	3700	2100	1420	1850	2050	8450
	G2		120			23	5.5	3900	2250	1550	2000	2200	11480
	G3		150			32	7.5	4500	2450	1700	2150	2300	16480
RCDF-18	G1	1800	90	450	4.0	24.5	7.5	3900	2250	1600	2000	2200	11080
	G2		120			30	7.5	4500	2350	1750	2100	2300	15550
	G3		150			42	11	5200	2600	1920	2300	2450	20890



RCDD–G系列自冷带式强磁电磁除铁器

Natural Cooling Belt Type Strong Electromagnetic Separator
Series RCDD-G



本系列除铁器为长期工作制的自冷带式电磁除铁器，设计了台架、滚筒、卸铁皮带等部件，悬挂在带式输送机上方，通

过卸铁皮带运转，可不断地自动将电磁铁吸上来的铁磁性异物抛进集铁箱，达到自动卸铁目的。

该系列除铁器适合于从较厚料层和较大粒度矿石、煤炭、焦炭、石灰石等铁质较多的场合中除去铁磁性异物。

This series is of long work shift, suspended over the belt conveyer. Some parts like stand, roll, and iron discharge belt are available. They can continuously throw away the iron materials which are attracted by electromagnet into the iron collecting box.

They are suitable for removing iron magnetic foreign articles from materials of thicker bed and bigger granularity that are rich in iron like ores, coal, and hard coke.

主要技术参数 Main Technical Data

型 号 model	适用 带宽 applicable belt width E (mm)	悬挂 高度 hanging height (< mm)	磁场 强度 magnetic induction (≥mT)	物料 厚度 material thickness (≤mm)	适应 带速 applicable belt speed (≤m/s)	励磁 功率 excitation power (≤kW)	驱动 功率 driving power (kW)	外形尺寸 overall dimension (mm)			悬挂尺寸 hanging size (mm)		质量 mass (kg)
								A	B	H	C	D	
RCDD-5	G1	500	90	100	2.5	2.9	1.5	1900	950	730	650	800	1000
	G2		120			4.0	1.5	2050	1250	730	950	1000	1520
	G3		150			7.0	2.2	2750	1400	740	1130	1280	2550
RCDD-6	G1	650	90	150	2.5	4.0	1.5	2050	1250	730	950	1000	1550
	G2		120			7.0	2.2	2750	1400	740	1130	1280	2500
	G3		150			9.2	2.2	2900	1550	820	1250	1450	3550
RCDD-8	G1	800	90	200	2.5	7.0	2.2	2750	1400	740	1130	1280	2350
	G2		120			9.2	2.2	2900	1550	820	1250	1450	3580
	G3		150			14.0	3.0	3200	1750	840	1580	1780	4150
RCDD-10	G1	1000	90	250	2.5	9.0	3.0	2900	1550	820	1250	1450	3480
	G2		120			14.0	3.0	3200	1750	840	1580	1780	4250
	G3		150			18.5	4	3500	1950	950	1700	1950	6500
RCDD-12	G1	1200	90	300	2.5	11	4	3200	1750	840	1580	1780	4450
	G2		120			17.5	4	3500	1950	950	1700	1950	7000
	G3		150			20	5.5	3700	2100	1050	1850	2050	8700
RCDD-14	G1	1400	90	350	2.5	17.5	4	3500	1950	950	1700	1950	7700
	G2		120			19.5	5.5	3700	2100	1050	1850	2050	7900
	G3		150			24	5.5	3900	2250	1100	2000	2200	10600
RCDD-16	G1	1600	90	400	2.5	18.5	5.5	3700	2100	1050	1850	2050	7950
	G2		120			27	5.5	3900	2250	1100	2000	2200	10800
	G3		150			36	7.5	4500	2450	1150	2150	2300	14900
RCDD-18	G1	1800	90	450	4.0	26.5	7.5	3900	2250	1100	2000	2200	10200
	G2		120			31	7.5	4500	2350	1150	2100	2300	14000
	G3		150			44	11	5200	2600	1200	2300	2450	19800
RCDD-20	G1	2000	90	500	4.0	30	7.5	4500	2350	1150	2100	2300	13200
	G2		120			37	11	5200	2450	1150	2150	2300	19500
	G3		150			53	11	5400	2650	1250	2250	2500	25500
RCDD-22	G1	2200	90	550	4.0	34	11	5200	2450	1150	2150	2300	17200
	G2		120			44	11	5400	2600	1250	2300	2450	23200
	G3		150			62	15	5800	2900	1350	2500	2800	28500

SSTM(Q) 系列整流控制柜

Commutating Control Cabinet Series SSTM(Q)

本系列产品采用桥式整流方式，当容量小于等于6.2kW时采用单相供电；当容量大于6.2KW时采用三相供电。操作方式为柜门上按钮集中控制，可根据用户要求加配操作箱。

SSTM(Q) -□D-□系列电控柜与连续工作制的RCDB、RCDY、RCDE系列电磁除铁器（无电动小车）ML1系列电磁轮配套使用；SSTM(Q) -□D1-□系列电控柜与RCDD系列电磁除铁器配套使用；SSTM(Q) -□D2-□系列电控柜与配电动小车的RCDB、RCDY、RCDE系列电磁除铁器（手动左右行）配套使用；SSTM(Q) -□S-□系列电控柜与要求定时卸铁的RCDB、RCDY、RCDE系列电磁除铁器配套使用；SSTM(Q) -□T-□系列电控柜与配金属探测器的RCDB系列电磁除铁器配套使用，字母S、T所代表的功能可与D1所代表的功能组合使用。

This series uses bridge type commutating mode. When the capacity ≤ 6.2 KW, we supply power with single-phase; when > 6.2 KW, three-phase. You can control the operation by pushing the buttons on the cabinet gate. An operation box can also be supplied to meet your requirement.

Series SSTM(Q) -□D-□ shall be combined with series RCDB, RCDY, RCDE which is of continuous duty system without motor trolley and series ML1 (electromagnetic wheel); series SSTM(Q) -□D1-□ with series RCDD; series SSTM(Q) -□D2-□ with series RCDB, RCDY, RCDE which have motor trolley (left & right move manually); series SSTM(Q) -□S-□ with series RCDB, RCDY and RCDE which ask for timing iron-discharging; series SSTM(Q) -□T-□ with series RCDB which have metal detectors. The function S and T stand for can be combined with that D1 stands for.

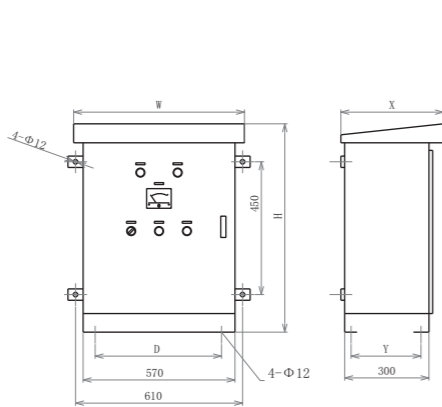

SSTM(Q) 外形尺寸图
Overall Dimension Drawing

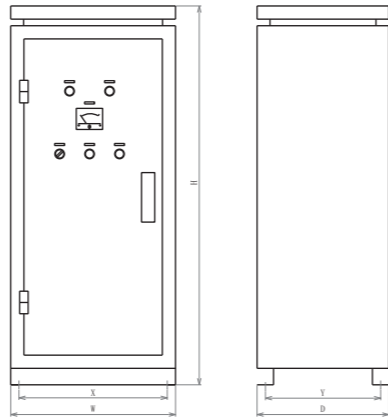

SSTM(Q)1 外形尺寸图
Overall Dimension Drawing

型号说明 Model Designation

SSTM(Q) 1-□□-□

- 安装位置: Installation position:
C为户内式、D为户外式 C for indoors; D for outdoors
- 控制方式: Control mode:
D为连续励磁(基本型); D for continuous excitation (basic type)
D1专为控制RCDD系列除铁器; D1 for series RCDD
D2控制配电动小车的RCDB系列除铁器; D2 for series RCDB which have motor trolley
D3控制配电动小车的RCDD系列除铁器; D3 for series RCDD which have motor trolley
S为连续励磁定时卸铁(定时卸铁型);
S for timing iron-discharging on continuous excitation (timing discharging type)
T为配金属探测器,自动循环(节能型)
T for autocycle (energy-saving type) which have metal detectors
- 额定输出功率(kW) Rated output power (kW)
- 带整流变压器方式 Combined with commutating transformer
- 整流电源相数,M为单相、Q为三相 Number of phase: M for single phase; Q for 3-phase
- 电磁除铁器电控柜 Electric control cabinet for electromagnetic separator

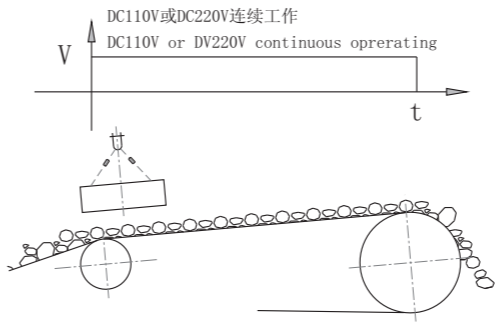

SSTM(Q)-□D-□ 工作方式及电压特性图 GA of Separator
Operation Mode & Voltage Characteristic Sketch

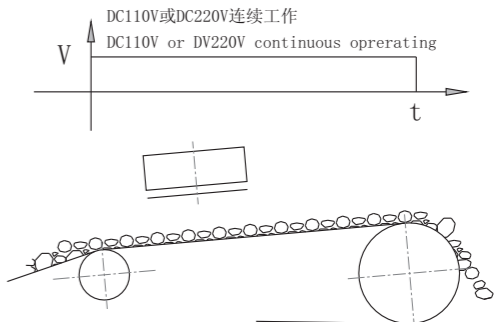

SSTM(Q)-□D1-□ 工作方式及电压特性图 GA of Separator
Operation Mode & Voltage Characteristic Sketch

主要技术参数 Main Technical Data

型 号 model	主要参数 main data	外形尺寸 overall dimension (mm)					额定输出功率 rated output power (kW)	输入交流电压 input AC voltage (V)	输出直流电压 output DC voltage (V)	质量 mass (kg)
		W	D	H	X	Y				
普通式 common type	SSTM-1.5D-C	650	350	800	520	250	1.5	380	110	50
	SSTM-3.1D-C	650	350	800	520	250	3.1	380	110	55
	SSTM-4.2D-C	650	350	800	520	250	4.2	380	110	60
	SSTM-6.2D-C	650	350	800	520	250	6.2	380	220	65
	SSTQ-9.3D-C	650	350	850	520	250	9.3	380	220	80
	SSTQ-12D-C	700	450	900	570	400	12	380	220	95

带整流 变压器 with commutating transformer	SSTM1-1.5D-C	500	400	1450	450	350	1.5	380	110	86
	SSTM1-3.1D-C	500	400	1450	450	350	3.1	380	110	103
	SSTM1-4.2D-C	500	400	1450	450	350	4.2	380	110	111
	SSTM1-6.2D-C	500	400	1450	450	350	6.2	380	220	135
	SSTQ1-9.3D-C	700	450	1550	650	400	9.3	380	220	180
	SSTQ1-12D-C	700	450	1550	650	400	12	380	220	205

注：普通式的户内防护式与户外防护式柜本安装参考尺寸相同；带整流变压器的户内防护式与户外防护式柜体安装参考尺寸相同，只是柜顶盖前后各突出50mm。

Note: Usually the dimensions of common indoors protective type are as the same as those of outdoors type; So is the indoors protective type with commutating transformer and that of outdoors type except extra 50 mm length front & back at the top of cabinet cover.

主要技术参数 Main Technical Data

型 号 model		主要参数 main data	外形尺寸 overall dimension (mm)					额定输出功率 rated output power (kW)	输入交流电压 input AC voltage (V)	输出直流电压 output DC voltage (V)	质量 mass (kg)
			W	D	H	X	Y				
普通式 common type	SSTM-1.5D1-C	650	350	800	520	250	1.5/1.5	380	110	50	
	SSTM-3.1D1-C	650	350	800	520	250	3.1/2.2	380	110	55	
	SSTM-4.2D1-C	650	350	800	520	250	4.2/2.2	380	110	60	
	SSTM-6.2D1-C	650	350	800	520	250	6.2/4	380	220	65	
	SSTQ-9.3D1-C	650	350	850	520	250	9.3/4	380	220	80	
	SSTQ-12D1-C	700	450	900	650	400	12/5.5	380	220	95	
	SSTQ-25D1-C	700	450	1100	650	400	25/5.5	380	220	115	
带整流 变压器 with commutating transformer	SSTM1-1.5D1-C	500	400	1450	450	350	1.5/1.5	380	110	86	
	SSTM1-3.1D1-C	500	400	1450	450	350	3.1/2.2	380	110	103	
	SSTM1-4.2D1-C	500	400	1450	450	350	4.2/2.2	380	110	111	
	SSTM1-6.2D1-C	500	400	1450	450	350	6.2/4	380	220	135	
	SSTQ1-9.3D1-C	700	400	1550	650	350	9.3/4	380	220	180	
	SSTQ1-12D1-C	700	400	1550	650	350	12/5.5	380	220	205	
	SSTQ1-25D1-C	700	450	1100	650	400	25/5.5	380	220	315	

注：1. 额定输出功率栏中为：电控柜额定输出功率/除铁器驱动电机功率。
2. SSTQ1-25D1-C整流变压器外附。

Note: 1. The values in the column of rated output power stand for: output power of electric control unit / driving motor power of separator.
2. Series SSTQ1-25D1- C (commutating transformer) shall be enclosed additionally.

SSTM(Q)2系列整流控制柜
Commutating Control Cabinet Series SSTM(Q)2



本系列产品是由一台电控柜控制安装于同一皮带上的两台RCDB型除铁器定时交替工作。当已励磁的除铁器设定时间到时，另一台除铁器进入运输皮带上励磁吸铁后，再自动退出后卸铁，两台除铁器周期性交替工作。该控制方式具有自动除铁、效果好等优点。尤其适用于连续作业的场所。如两台除铁器在交替工作的同时还需考虑同时工作，或需工作于邻近的另一皮带上时，请在订货时注明。

This series is designed to control two separators mounted over the same belt and work alternatively by one electric control unit. When a set time to one excitation separator is up, it will stop working, while the other will move in and take the place of ex-one to attract iron pieces, working alternatively with the advantages of auto iron-discharging, good removing rate, etc., especially suitable for the demand of continuous working. However if you need them to work simultaneously except for alternatively, or over a different belt, please let us know when placing an order.

型号说明 Model Designation

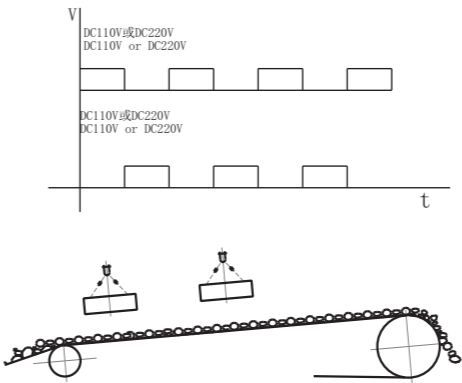
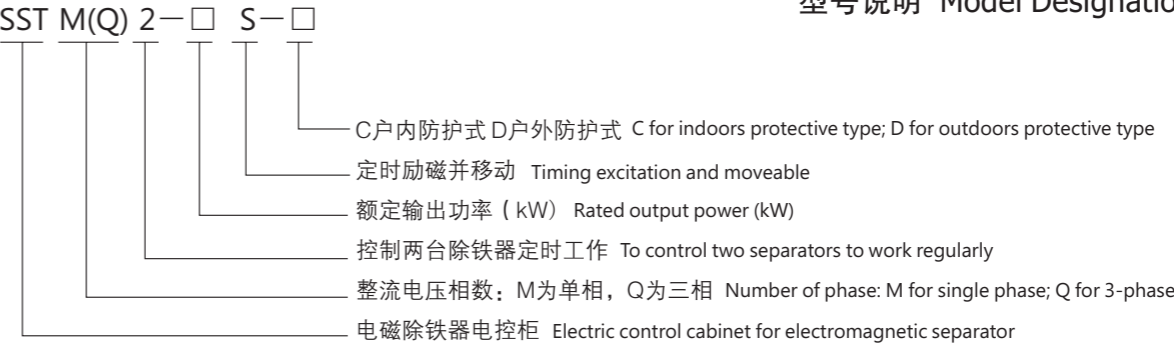

工作方式及电压特性图
Operation Mode & Voltage Characteristic Sketch

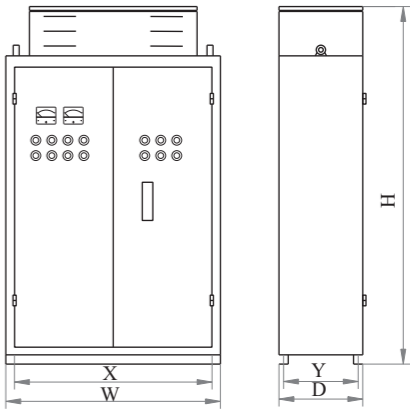

外形尺寸图
Overall Dimension Drawing

主要技术参数 Main Technical Data

型 号 model	主要参数 main data	外形尺寸 overall dimension (mm)					额定输出 功率 rated output power (kW)	输入交流 电压 input AC voltage (V)	输出直流 电压 output DC voltage (V)	定时 范围 timing range	小车功率 trolly power (kW)	质量 mass (kg)
		W	D	H	X	Y						
户内 防护式 indoors protective type	SSTM2-3.1S-C	700	450	1500	660	400	3.1	380	110	1小时 (hour)	0.4	340
	SSTM2-6.2S-C	700	450	1500	660	400	6.2	380	110		0.4	360
	SSTQ2-9.3S-C	900	450	1500	860	400	9.3	380	110		0.4	380
	SSTQ2-12S-C	900	450	1500	860	400	12	380	220		0.8	420
	SSTQ2-19S-C	900	450	1500	860	400	19	380	220		0.8	460
	SSTQ2-25S-C	900	450	1500	860	400	25	380	220		0.8	550
户外 防护式 outdoors protective type	SSTM2-3.1S-D	770	500	1500	730	450	3.1	380	110	1小时 (hour)	0.4	390
	SSTM2-6.2S-D	770	500	1500	730	450	6.2	380	110		0.4	410
	SSTQ2-9.3S-D	920	500	1570	880	450	9.3	380	110		0.4	430
	SSTQ2-12S-D	920	500	1570	880	450	12	380	220		0.8	470
	SSTQ2-19S-D	920	500	1570	880	450	19	380	220		0.8	580
	SSTQ2-25S-D	920	500	1570	880	450	25	380	220		0.8	610

注：1. 所配除铁器的额定电压应与电控柜的输出电压相符，两台除铁器的冷态功率消耗之和应小于或等于电控柜的额定输出功率。
2. 时间调节范围大于1小时应在订货时注明。
3. 柜体外形尺寸为常规产品尺寸，有特殊要求的请与公司联系确认。

Note: 1. The rated voltage for separator shall be matched with the output voltage of the electric control cabinet. The total power consumption of two separators in cold state shall be less than or equal to the rated output power of electric control cabinet.
2. If you need a time adjustment range more than 1 hour, please let us know when placing an order.
3. The overall dimension of cabinet is usually for general type. If you have some special requirement, please contact with us.

SSTQO系列整流控制柜
Commutating Control Cabinet Series SSTQO

本系列产品是与短时工作制的RCDD系列中节能型交叉皮带式除铁器配套用的整流控制柜。成套设备中必须配用金属探测器，只有当金属探测器发出信号时，才给除铁器馈电，将铁件捡除。

This series is designed for some separators of energy-saving crossover belt type in series RCDD which have short time duty. A full set must be combined with a metal detector and can only remove the iron after receiving a signal sent by the detector.



型号说明 Model Designation

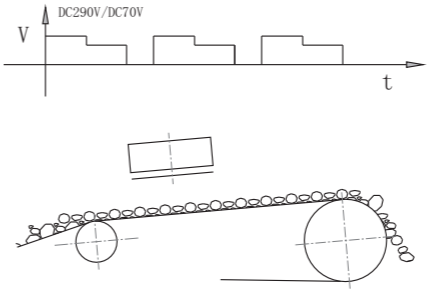

工作方式及电压特性图
Operation Mode &Voltage Characteristic Sketch

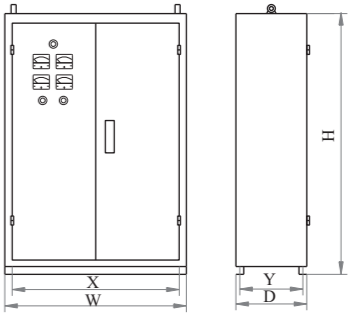

外形尺寸图
Overall Dimension Drawing

主要技术参数 Main Technical Data

参数data 型号 model	外形尺寸 overall dimension (mm)					额定输出功率 rated output power (kW)	输入交流电压 input AC voltage (V)	输出直流电压 output DC voltage (V)	质量 mass (kg)
	W	D	H	X	Y				
SSTQO-12D1-C/D	900	450	1550	850	400	12	380	290/70	120
SSTQO-19D1-C/D	900	450	1550	850	400	19	380	290/70	120
SSTQO-25D1-C/D	900	450	1550	850	400	25	380	290/70	120
SSTQO-32D1-C/D	900	450	1550	850	400	32	380	290/70	120
SSTQO-42D1-C/D	900	450	1550	850	400	42	380	290/70	120
SSTQO-58D1-C/D	900	450	1550	850	400	58	380	290/70	120
SSTQO-80D1-C/D	900	450	1550	850	400	80	380	290/70	120
SSTQO-100D1-C/D	900	450	1550	850	400	100	380	290/70	120
SSTQO-120D1-C/D	900	450	1550	850	400	120	380	290/70	120
SSTQO-130D1-C/D	900	450	1550	850	400	130	380	290/70	120

注：1. 除铁器的最大冷态消耗功率之和应小于或等于电控柜的额定输出功率。 2. 额定输出功率栏内的两个功率值为不同输出电压时的功率输出值。 3. SSTQO-110D1-D变压器外附。

Note: 1. The max of total power consumption of the separators shall be less than or equal to the rated output power of electric control cabinet.
2. The two power values in the column of rated output power stand for output power values at different output voltages.
3. The transformer of SSTQO-110D1-D is enclosed additionally.

SSTQT系列整流控制柜
Commutating Control Cabinet Series SSTQT

本系列产品是与短时工作制的RCDPS系列矿石回收式电磁除铁器配套用的整流控制柜。成套设备中必须配用金属探测器，只有当金属探测器发出信号时，才给除铁器馈电，将铁件检除。

This series is designed for some separators of ore recovery type in series RCDPS which is of short duty system. A full set must be combined with a metal detector and can only remove the iron after receiving a signal sent by the detector.



型号说明 Model Designation

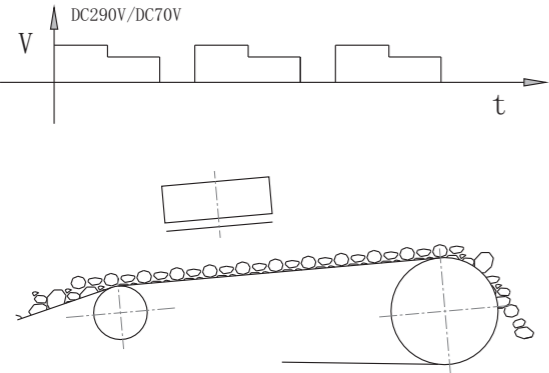

工作方式及电压特性图
Operation Mode & Voltage Characteristic Sketch

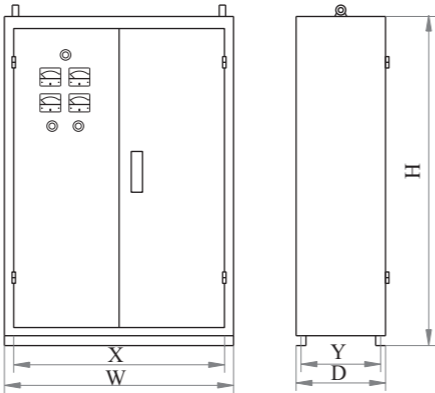

控制柜外形尺寸图
Overall Dimension Drawing

主要技术参数 Main Technical Data

参数data 型号 model	外形尺寸 overall dimension (mm)					额定输出功率 rated output power (kW)	输入交流电压 input AC voltage (V)	输出直流电压 output DC voltage (V)	质量 mass (kg)
	W	D	H	X	Y				
SSTQT-12D1-C/D	900	450	1550	850	400	12	380	0-220/0-290	120
SSTQT-19D1-C/D	900	450	1550	850	400	19	380	0-220/0-290	120
SSTQT-25D1-C/D	900	450	1550	850	400	25	380	0-220/0-290	120
SSTQT-32D1-C/D	900	450	1550	850	400	32	380	0-220/0-290	120
SSTQT-42D1-C/D	900	450	1550	850	400	42	380	0-220/0-290	120
SSTQT-58D1-C/D	900	450	1550	850	400	58	380	0-220/0-290	120
SSTQT-80D1-C/D	900	450	1550	850	400	80	380	0-220/0-290	120
SSTQT-100D1-C/D	900	450	1550	850	400	100	380	0-220/0-290	120
SSTQT-120D1-C/D	900	450	1550	850	400	120	380	0-220/0-290	120
SSTQT-130D1-C/D	900	450	1550	850	400	130	380	0-220/0-290	120

GJK磁性金属捡除装置（矿石自动回收式）程控柜
Program Control Cabinet for Auto
Ore Recovery Type Metal Detector Series GJK

本系列电控系统与RCDP型除铁器配套使用,可在磁性物料中金属，该系统包括整流控制柜、操作箱两件设备。程序控制和时间设定采用PC控制，整流电源采用可控硅连续调压，现场设定，安装调试方便，工作性能稳定、可靠。

This series which consist of rectifier control unit and operation box shall be combined with separator RCDP to detect and remove metals from magnetic materials. The program and time setting are controlled by PC; the rectifier power can be adjusted continuously by controllable silicon on the site. So it is convenient to mount and test them and their working performance is reliable and stable.



型号说明 Model Designation

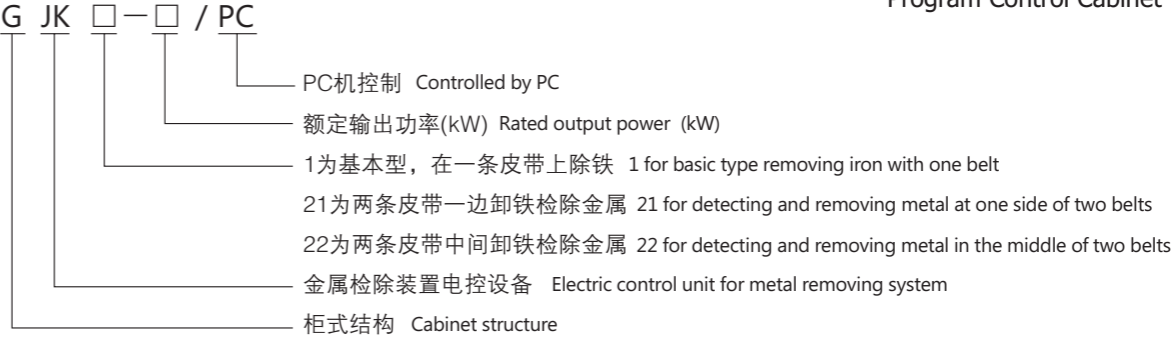

程控柜
Program Control Cabinet

永磁系列控制箱（柜）
Control Box (Cabinet) For Permanent-Magnetic Series

本系列产品与RCYD系列自卸式永磁除铁器、永磁辊及RCYX系列旋转式永磁除铁器配套使用。该控制箱体积小、操作方便，可就近安装于除铁器附近。我公司还根据用户要求提供防爆控制箱，以便于在易燃易爆环境中正常使用。该控制箱具有皮带联动与单机操作两种方式，并有皮带联动允许接点。当需要集控（短脉冲控制）及户外使用或行走装置采用电动小车时，订货时需注明。

This series shall be combined with series auto-discharging permanent separator, permanent magnetic roll and series RCYX rotary permanent separator to form a complete set. The small control box will be mounted near the separator. We can also supply anti-explosion type control box to meet the user's requirement of working in inflammable or explosive conditions. It includes belt-combination mode and single machine running mode with allowable contact for combined belt. Please let us know when you need a centralized control (short pulse control), or for outdoors use, or a motor trolley for running gear

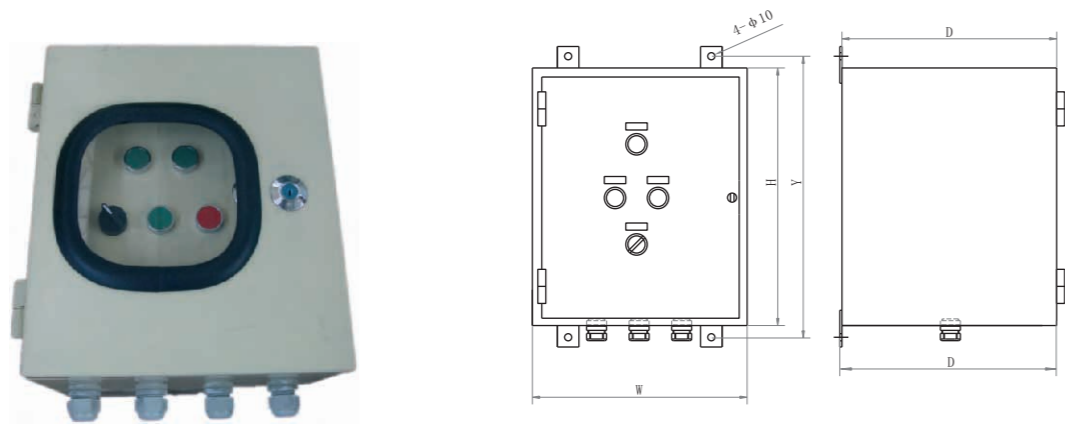

外形尺寸图 Overall Dimension Drawing

型号说明 Model Designation



主要技术参数 Main Technical Data

型 号 model	主要参数 main data	外形尺寸 overall dimension (mm)					额定输出功率 rated output power (kW)	输入交流电压 input AC voltage (V)	输出直流电压 output DC voltage (V)	质量 mass (kg)
		W	D	H	X	Y				
KYD-1.5		300	300	360	200	394	1.5	3相380	3相380	15
KYD-2.2		300	300	360	200	394	2.2	3相380	3相380	16
KYD-4		300	300	360	200	394	4	3相380	3相380	17
KYD-5.5		300	300	360	200	394	5.5	3相380	3相380	19
KYD-7.5		300	300	360	200	394	7.5	3相380	3相380	20
KYD-11		350	300	550	250	584	11	3相380	3相380	25
KYD-15		350	300	550	250	584	15	3相380	3相380	28

JTC2系列金属探测器
Metal Detector Series JTC2

该系列金属探测器是我公司吸收国外先进技术，并结合国内用户实际情况，开发研制的新产品。



This series are new products developed by Kemeida on the basis of advanced international technology.

用 途 Application

该产品广泛用于冶金、矿山、电力、选煤、水泥、化工等行业，能对非金属物料中混入的磁性金属异物进行连续探测，以非接触的方式检测出金属异物的存在，并将信号送给金属检除装置，将金属异物排除，以提高产品质量和确保设备的安全运行。

This series can detect the magnetic metal continuously from non-metal materials in non-contact way and then send signal to the device of detecting and removing to remove the metal and ensure a high quality of the product and a safer running. They are widely applied in metallurgy, mine, power supply, coal picking, cement and chemical industries.

特 点 Features

- 1、性能稳定，能长时间可靠工作。
- 2、能用于磁性和非磁性物料，对磁性物料的干扰有较强的抑制作用。
- 3、传感器可拆卸，不需断开皮带安装。
- 4、设有信号延时电路，可根据皮带速度和除铁位置任意整定。

1. Stable performance and reliable operation for long time
2. Can be used for both magnetic and non-magnetic materials with a strong suppression to the interference of magnetic materials.
3. Dismountable sensors and can be mounted with the belt connected
4. Provided with signal delay circuit which can be adjusted as per the belt speed and iron removing position.

主要技术参数 Main Technical Data

- 1、环境温度 Environment Temperature：- 10℃ ~ + 40℃
- 2、相对湿度 Relative Humidity：< 85%
- 3、电源电压 Voltage：~ 220V±10% (50Hz)
- 4、整机功耗 Total Power Consumption：< 30W
- 5、皮带速度 Belt Speed：0.8 ~ 2.5米/秒 (m/s)
- 6、探测灵敏度 Sensitivity：见下表 See the table below

型 号 model	JTC2-500A	JTC2-650A	JTC2-800A	JTC2-1000A	JTC2-1200A	JTC2-1400A	JTC2-1600A
皮带宽度 belt width	500	650	800	1000	1200	1400	1600
可感知磁性金属柱 sensible magnetic metal column (mm)	Φ20×20	Φ20×20	Φ25×25	Φ30×30	Φ40×40	Φ50×50	Φ60×60

传感器外形尺寸表 Sensor Overall Dimension Table

皮带宽度 belt width	A	A´	B	B´	C	D
500	880	680	640	500	780	130
650	1030	830	640	500	930	130
800	1180	980	640	500	1080	130
1000	1380	1180	640	500	1280	130
1200	1580	1380	640	500	1480	130
1400	1800	1600	640	500	1700	130
1600	2000	1800	640	500	1900	130

除铁器电缆选型

Cable Model Selection For Separator

1. 电磁除铁器、电磁轮(辊)

Electromagnetic Separator, Electromagnetic Wheel (Roll)

除铁器型号 separator model	励磁电缆YC或YCN excitation cable YC or YCN	冷却风机电缆 cable for cooling fan (0.25 ~ 2.2kW)	行走机电缆 cable for moving motor (0.2 ~ 0.8kW)	行程开关电缆 Travel Switch Cable
RCD(A,B,C,D) -4,-5,-6,-6.5,-8	2X6mm ²	YZ或YZW 4 x 1.0mm ²	YZ或YZW 4 x 1.0mm ²	YZ2 x 1.0mm ² 或4 x 1.0mm ² 或 KVV KYV4x1.0mm ² KXV
RCD(A,B,C,D) -10(12, 14)	2X10mm ²			
RCD(A,B,C,D) -16(8)	2X16mm ²			
RCD(A,B,C,D) -20	2X25mm ²			

2. 带式电磁、永磁除铁器Belt Type

Electromagnetic & Permanent-magnetic Separator

除铁器类别 separator model	皮带电机功率 belt motor power (kW)	皮带机电缆 cable for belt motor YZ (mm ²)
电 磁 electromagnetic	≤3.0	4×1.0
	4~5.5	3×2.5+1×1.5
	7.5	3×4+1×2.5
	11	3×6+1×4
	15	3×10+1×6
永 磁 permanent-magnetic	≤3.0	4×1.0
	4~5.5	3×2.5+1×1.5
	7.5	3×4+1×2.5
	11	3×6+1×4
	15	3×10+1×6

除铁器附件
Accessories for Separator

除铁器安装
How to Install the Separator

无论电磁除铁器还是永磁除铁器，有很多系列型号，是悬吊在输料皮带上方一定高度上进行除铁工作的，所以国标(GB)中，称这种形式的除铁器为悬挂式除铁器：如RCY类的B系列；D系列；P系列(手动)；RCD类的RCDA(B、C、D、E、F)系列。在悬挂式除铁器中分为自卸式(如RCYD、RCDC、RCDD、RCDF等)和非自卸式(如RCYB、RCYP、RCDA和RCDB、RCDE)两种。这里专门介绍悬挂式除铁器的安装。

We have many kinds of electromagnetic & permanent-magnetic separators which are all hanged over the conveyer belt, so they are called hanging type by GB like series B, D and P (manual) in RCY ; series RCDA (B, C, D, E, F) in RCD. We divide hanging series into auto discharging (such as series RCYD, RCDC, RCDD and RCDF)and non auto discharging(such as RCYB, RCYP, RCDA and RCDB, RCDE) two types and would be glad to explain how to mount hanging type.

悬挂方式 Hanging Mode

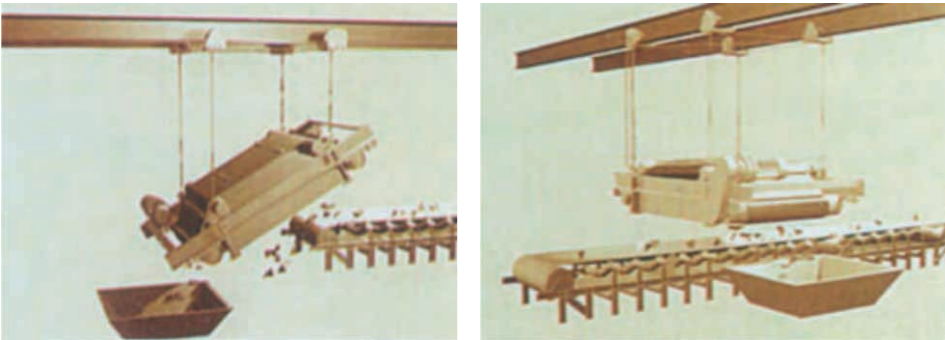

悬挂安装方式分倾斜、水平两种，它们与除铁器安装在输料皮带上的工作位置有关。
There are two modes: sloping and horizontal installation. Both of them have close relation with installation position of separator on the belt.

倾斜式安装 Sloping installation

1. 安装在输料皮带机头上方除铁时，带式除铁器须纵向倾斜安装。除铁器的主传动滚筒在低位。倾角 $\alpha = 15-30^\circ$ ， $S=R_{-200}^{+300}$
Belt type shall be mounted in a sloping way when hanged over an upper part of the belt. Make driving roll stay lower with inclination $\alpha = 15-30^\circ$ ， $S=R_{-200}^{+300}$
2. 安装在输料皮带上下坡段内除铁时，带式除铁器纵向必须与输料皮带方向成垂直吊挂，允许横向倾斜安装，倾角 α 与输料皮带的上下山倾角一致，但 $\alpha_{max} < 18^\circ$
The belt type shall be mounted vertically to the running direction of the belt, that is, a transverse slope when hanged over a lower part of the belt. Inclination shall be as the same as that of belt with $\alpha_{max} < 18^\circ$.

水平式安装 Horizontal installation

输料皮带除了上下坡之外，多为水平运行，在输料皮带任意水平段上方均可按水平方式吊装除铁器。
Most of time conveyer belt runs horizontally except up or down a slope. The separator can be hanged horizontally over the belt at different parts.

吊挂轨道选择 How to choose hanging railway

轨道数量：重型除铁器，可优先选取双轨吊挂。轻型除铁器或仅设三吊点的除铁器，一般采用单轨吊挂。

Railway No.: double railways are recommended for heavy separator, while light or only three lifting ears available, single railway.

轨道方向 Railway direction :

根据现场条件，除铁器在输料皮带机头上方吊挂，其轨道可与输料皮带方向垂直或同向。若除铁器在输料皮带上下坡段或水平段上方吊挂，其轨道方向必须与输料皮带方向垂直。

When the separator is hanged over the upper part of the conveyer belt, its railway shall keep vertical or the same to the conveyer belt; while when over the sloping part or upper horizontal part of the belt, its railway shall keep vertical to the belt.

行走装置选择 How to Select Walking Device :

(1)带式卸铁或手动卸铁除铁器：一般选择手动行走小车。重型除铁器优选双轨手动组合行走架；轻型除铁器一般选择单轨组合行走架或单轨单车吊挂。

For belt discharge or manual discharge separator, usually choose manual trolley; for heavy type separator, prior to choose double-railway manual combined moving frame; for light type separator, usually choose single-railway combined moving frame or single railway suspension.

(2)非带式电磁除铁器：一般优选电动行走小车。以便电控自动吸、弃铁、轻型特别是三吊点的除铁器，一般选择电动单轨单车吊挂。重型设四吊点的除铁器可以选择电动双轨或单轨组合行走架，重型设三个吊点的可以选择电动单轨组合行走架。

For non-belt electromagnet separator, prior to choose motor trolley in order to auto attract or release iron by electric control. For light type separator and those with three lifting ears, prior to choose electric single-railway suspension. For heavy type separator with four lifting ears, choose electric double-railway or single-railway combined moving frame, and for heavy type with three lifting ears, choose electric single-railway moving frame.

除铁器吊挂装置
Hanging Device of Separator

- 1. 螺旋扣 rigging screw
- 2. 钢丝绳 wire cable
- 3. 钢丝绳夹 wire cable grip
- 4. 套环 ring
- 5. 过渡环 step-up ring
- 6. 短环链 short link chain
- 7. 锻造卸扣 forging shackle
- 8. 钢拉杆 steel rod

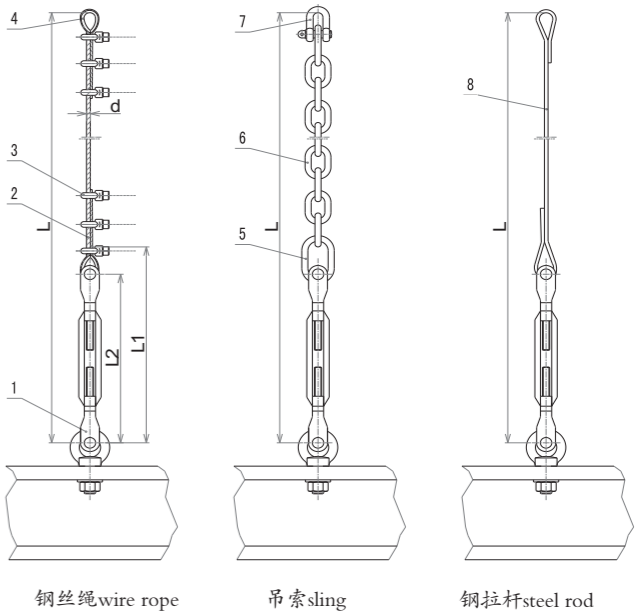

除铁器附件
Accessories for Separator

注意事项 Notes

1. 钢拉杆可供开口(用户自焊)和封口两种。
2. 用户有特殊要求，螺旋扣可不按表内选取，欲定何种型号，应特别标明。
3. 选用钢丝绳吊挂装置应注意：

(1) 绳夹不得在钢丝绳上一正一反设置

(2) 绳的U型螺栓必须从尾段一侧缺口扣入，然后夹座从工作段一侧扣入(见图示)

(3) 钢丝绳每端连接，使用一组绳夹的数量及间距见下表
1. Steel rod is provided with open type (welded by user) and sealed type
2. Rigging screw can be chosen beyond the following list. Please state the desired model.
3. Attention for choosing wire rope



(1) Cable grip on wire cable can't be set one obverse and the other reverse.

(2) U -shape bolt must enter from the gap at the tail, and snap from one side of live section.

(3) Connect each end of wire cable. The number and space of one group of cable grip is shown as following:

绳夹公称尺寸(钢丝绳公称直径d) nominal size fo cable grip nominal diameter of wire cable (mm)	每组绳夹的最少数量 Min. Quant. of each group of cable grips	绳夹间距 space between two cable grips (c)
≤19	3	(6-7)·d
>19-32	4	

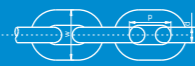
选型表 Model Selection Table

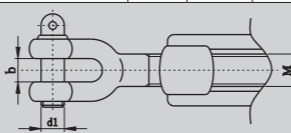
项目 吊挂 重量	钢丝绳 wire rope (GB8919-88)				短环链 short link chain (GB5802-86)				钢拉杆 steel rod	锻造卸扣 forging shackle (GB/G10603-89)				螺旋扣 rigging screw (GB561-65)			
	绳直 径	套环 ring (GB/T59 71-86)	钢丝绳夹 wire cable grip(GB 5976-86)	起吊 重量 hoisting weight										型 号 model	可调 距离 ajustable space	起吊 重量 hoisting weight	
					d	p	w	起吊 重量 hoisting weight (T)		直径 diame- ter (Φ)	M	W	S				起吊 重量 hoisting weight (T)
hanging weight (T)	d	公称尺寸 normal size	规 格 specifi- cation	T	d	p	w	起吊 重量 hoisting weight (T)	直径 diame- ter (Φ)	M	W	S	起吊 重量 hoisting weight (T)	A型 A type (B型 B type)	最短 (min.) L2	最长 (max.) L1	(T)
0.5	9	10	10	4	9	27	30	2	12	M12	12	25	0.63	A0.9M14 d1=14,b=18	294	434	0.9
										M14	14	28	0.8				
1	9	10	10	4	9	27	30	2	16	M14	14	28	0.8	A1.2M16 d1=16,b=22	356	524	1.25
										M16	16	31.5	1.0				
2	12	12	12	7.5	12.5	38	41	4	20	M20	20	40	1.6	A2.1M20 d1=20,b=27	418	603	2.1
										M22	22	45	2.0				
3	12	12	12	7.5	12.5	38	41	4	22	M24	24	50	2.5	A3.5M24 d1=26,b=32	507	719	3.5
										M30	30	56	3.2				
4	16	16	16	13	16	48	52	8	26	M30	30	56	3.2	A4.5M27 d1=30,b=36	545	757	4.5
										M33	33	63	4				
5	16	16	16	13	16	48	52	8	30	M36	36	71	5	B6M33 d1=32,b=40	633	881	6.0
										M39	39	80	6.3				
7	22	22	22	25	18	54	59	15	35	M39	39	80	6.3	B7.5M36 d1=36,b=44	652	900	7.5
										M45	45	90	8				
10	22	22	22	25	20	60	65	20	40	M52	52	100	10	B11M45 d1=45,b=52	762	1027	9.5
										M56	56	112	12.5				
15	24	24	24	30	20	60	65	20	45	M56	56	112	12.5	B14M48 d1=50,b=58	843	1133	14
										M64	64	125	16				
备注 remark	1.每台除铁器配4根，每根总长L由用户根据现场空间订购。 2.根据除铁器重量按吊挂装置的吊挂重量相应选取。 Note: 1. Each separator is provided with four pieces, and the length of each can be made to meet customer's demand. 2. The hanging weight is selected according to the separator's weight.																

除铁器行走装置
Walking Device of Separator

型号说明
Model Designation



手动双轨组合行走架主要技术参数
Main Tech Data of Manual Dual-rail Combined Travel Frame

项目 item	型号 model	SDX-2 · Z-2	SDX-2 · Z-4	SDX-2 · Z-6	SDX-2 · Z-10	SDX-2 · Z-16	SDX-2 · Z-20
许用负载 available load (T)		2	4	6	10	16	20
动力 drive		人工 manual					
运行速度 running speed (m/min)		人力控制 manual controll					
工字钢轨型号 mode of double T steel GB706-88		28b	20b-32c		25b-63c		63c

手动单轨组合（单车）行走架主要技术参数
Main Tech Data of Manual Single-rail Combined (Single Trolly) Travel Frame

项目 item	型号 model	SDX-1·Z-0.5 SDX-1·1-0.5	SDX-1·Z-1 SDX-1·1-1	SDX-1·Z-2 SDX-1·1-2	SDX-1·Z-3 SDX-1·1-3	SDX-1·Z-5 SDX-1·1-5	SDX-1·Z-8 SDX-1·1-8	SDX-1·Z-10 SDX-1·1-10	SDX-1·Z-16 SDX-1·1-16	SDX-1·Z-20 SDX-1·1-20
许用负载 load permitted (T)		0.5	1	2	3	5	8	10	16	20
动力 drive		人工 manual								
速度 speed		人力控制 manual control								
工字钢轨型号 mode of I steel (GB706-88)		16-28b		20a-32C		25a-63c		63c		

电动双轨组合行走架主要技术参数
Main Tech Data of Motorized Dual-rail Combined Travel Frame

型号 model 项目 item	DX-2 · Z-2	DX-2 · Z-4	DX-2 · Z-6	DX-2 · Z-10	DX-2 · Z-20
许用负数 available load (T)	2	4	6	10	20
电机功率 motor power (kW)	0.2X2	0.4X2	0.4X2	0.8X2	0.8X2
运行速度 running speed (m/min)	7; 11; 20	7; 11; 20	7; 11; 20	7; 11; 20	7; 11; 20
工字钢轨型号 model of I steel type steel (GB706-88)	28b	32c	32c	63c	63c

电动单轨组合(单车)行走架主要技术参数
Main Tech Data of Manual Single-rail Combined (Single Trolly) Travel Frame

型号 model 项目 item	DX-1·Z-0.5 DX-1·1-0.5	DX-1·Z-1 DX-1·1-1	DX-1·Z-2 DX-1·1-2	DX-1·Z-3 DX-1·1-3	DX-1·Z-5 DX-1·1-5	DX-1·Z-8 DX-1·1-8	DX-1·Z-10 DX-1·1-10
许用负载 available load (T)	0.5	1	2	3	5	8	10
电机功率 motor power (kW)	0.2	0.2	0.4	0.4	0.8	0.8	0.8
运行速度 running speed (m/min)	7; 11; 20	7; 11; 20	7; 11; 20	7; 11; 20	7; 11; 20	7; 11; 20	7; 11; 20
工字钢轨型号 mode of I steel (GB706-88)	16-28b		20a-32C		25a-63c		

注：电动行走装置的运行速度建议采用11m/min，如用户有特殊要求以用户要求为准。
Note: It is suggested that the running speed of motorized running gear be 11m/min. If there are any special requirements, be subjected to the user's requirement.

TWG系列非磁性平托辊
Non-magnetic Flat Roll Series TWG



TWG系列非磁性平托辊是一种不导磁的直线平行托辊。它采用优质不锈钢材料加工制作，安装于胶带输送机中悬挂式除铁器底部的皮带下面，其安装位置距除铁器磁系中心偏前1/6L左右（L为除铁器磁系长度），非磁性平托辊安装时高于皮带输送机底部平托辊50~150mm，与悬挂式除铁器配套使用，当物料经过非磁性平托辊上方时，物料处于疏松状态，夹杂在物料中部或底部的铁杂质从物料中裸露出来，帮助除铁器更有效地提高除铁率。

Series TWG is non-conductive linear flat roll, made by stainless steel of high quality and are installed under the conveyer belt, and the installation position is about 1/6L in front of the center of the separator's magnet system (L refers to length in separator's magnet system), about 50~150 mm higher than the flat supporting roll at the bottom of the belt conveyer. They are combined with hanging type separator. When the material passes through the non-magnetic flat supporting roll, it stays in a loose state and thus the iron among it appears, in this way the result of iron-removing got improved largely.

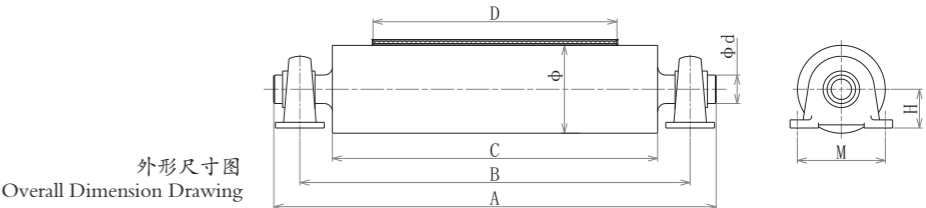

主要技术参数 Main Technical Data

型 号 model	适用带宽 applicable belt width D (mm)	外形尺寸 overall dimension (mm)							轴承座 bearing seat	质量 mass (kg)
		A	B	C	d	Φ	M	H		
TGW-50	500	780	720	640	35	108	126	47.6	UCP207	14.6
TGW-65	650	930	870	790	35	108	126	47.6	UCP207	16.5
TGW-80	800	1130	1070	990	35	108	126	47.6	UCP207	19
TGW-100	1000	1375	1300	1210	55	133	172	63.5	UCP211	33.8
TGW-120	1200	1625	1550	1460	55	133	172	63.5	UCP211	38.5
TGW-140	1400	1840	1750	1650	60	133	186	69.9	UCP212	42.5
TGW-160	1600	2080	1990	1890	60	133	186	69.9	UCP212	47.2
TGW-180	1800	2300	2210	2110	65	159	203	76.2	UCP213	72.4
TGW-200	2000	2490	2400	2300	65	159	203	76.2	UCP213	83.1

注：为了更好发挥除铁效率，我们建议用非磁性平托辊代替非磁性槽型托辊组。
Note: In order to improve the result of iron removing, you are advised to use non-magnetic flat supporting roll instead of non-magnetic groove type rolls

CTG干式永磁筒式磁选机
Drum-type Dry Permanent-magnetic
Separator Series CTG

概 述 Brief

CTG系列干粉式永磁除铁器，是一种从干性细粉中连续自动除铁的设备，内部采用稀土永磁材料提供磁场，在不锈钢筒外产生高梯度强磁场，吸铁能力很强。当物料落至转动的强磁滚筒时，物料中的铁磁性物质被筒体表面吸附，并随着滚筒转动。当铁磁性物质被带到无磁区域时，在自重作用下自行掉入弃铁箱内，达到除铁目的。该机可接入生产线连续运行，自动排铁，单级铁杂质除净率达到95%以上。内部磁滚采用独特立式结构避免了物料与铁杂质互相粘连，分选效果差的缺点，广泛应用于化工、陶瓷、电瓷、玻璃原料、耐火材料、碳黑、塑料、磨料磨具、非金属矿、铸造型砂等行业除去干粉或干性物料中的铁磁性物质，为进一步提高物料品位提供保证。

Series CTG is automatic equipment working continuously to remove iron from dry powder. They adopt rare earth permanent-magnetic material to produce high gradient strong magnetic field outside the stainless steel drum with a strong attract force. When the materials drop into the rotary drum, the iron particles will be attracted and rotated with the drum till drop into collecting box by gravity when is carried to non-magnetic area to fulfill the aim of iron removing. This series can be connected with production line, removing iron in an auto and continuous mode with up to 95% or more of iron-removing rate. Interior roll adopts unique vertical structure to avoid sticking between material and iron particles. They are widely used in chemical, ceramics, electrical porcelain, glass material, refractory, carbon black, plastic, abrasive & sharpener, non-metal ore and foundry sand industry, to further improve the material quality.

注：该机标定的物料处理能力是按石灰石计算的。
Note: The capacity of dealing with the given material is calculated by limestone.

单、双、三滚筒式永磁磁选机可广泛应用于磨料、冶炼、建材、化工、矿山、电磁、粮食等各行行业中干法去除各物料中的含铁性物质，是磁选工艺必备的关键设备，本机可单台使用，也可用于生产线中。

Single, double and three roll type are widely applied in abrasive industry, metallurgy industry, building material industry, chemical industry, mine industry, electromagnet industry, food industry to remove iron materials in dry way, which is the critical equipment for magnetic separation. It can be used singly and in the product line as well.

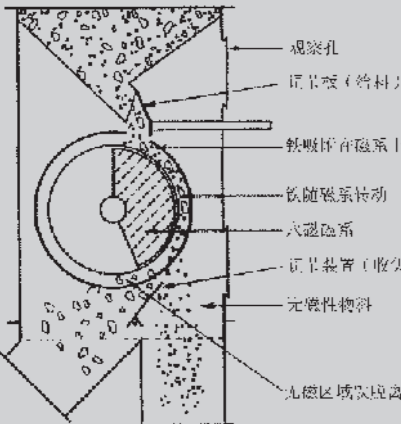

主要技术参数 Main Technical Data

型 号 model	筒径 drum diameter (mm)	筒长 drum length (mm)	筒表磁场 surface magnetic field (≥mT)	圆筒转速 drum rotate speed (r/min)	给料粒度 feeding granularity (≤mm)	处理能力 handling capacity (≤T/h)	传动功率 driving power (kW)	外型尺寸 overall dimension (mm)			质量 mass (kg)
								长 L	宽 W	高 H	
CTG-3230	320	300	3500	35	5	1	1.1	600	750	1250	170
CTG-3250	320	500	3800			2	1.1	600	870	1400	360
CTG-4565	450	650	4000			3	1.5	1100	1000	1550	670
CTG-5580	550	800	4200			4	1.5	1360	1420	1710	985
CTG-6590	650	900	4500			5	2.2	1600	1650	1860	1270



外形图 Outline Drawing



产品图片 Product Picture

主要技术参数 Main Technical Data

型 号 model	筒径 drum diameter (mm)	筒长 drum length (mm)	滚筒 个数 roll number	筒表磁场 surface magnetic field (≥mT)	圆筒转速 drum rotate speed (r/min)	给料粒度 feeding granularity (≤mm)	处理能力 handling capacity (≤T/h)	传动功率 driving power (kW)	外型尺寸 overall dimension (mm)			质量 mass (kg)
									长 L	宽 W	高 H	
CTG2-3260	320	600	2	上筒 upper drum≥1000 下筒 lower drum≥4000	17~82	≤5	≤2	1.5	950	1075	1250	920
CTG3-3260	320	600	3	上筒 upper drum≥1000 中筒 middle drum≥3000 下筒 lower drum≥4000		≤5	≤2.5	1.5	1100	1075	1250	1250
CTG2-4080	400	800	2	上筒 upper drum≥1000 下筒 lower drum≥4000		≤6	≤2.5	1.75	1250	1330	1580	1100
CTG3-4080	400	800	3	上筒 upper drum≥1000 中筒 middle drum≥3000 下筒 lower drum≥4000		≤8	≤3	1.75	1300	1330	1950	1460
CTG4-4080	400	800	4	上筒 upper drum≥1000 中筒 middle drum≥3000 中筒 middle drum≥4000 下筒 lower drum≥4500		≤8	≤3.5	1.75	1450	1330	2600	1850
CTG2-50100	500	1000	2	上筒 upper drum≥1000 下筒 lower drum≥4000		≤10	≤4	2.2	1450	1565	1820	1500
CTG3-50100	500	1000	3	上筒 upper drum≥1000 中筒 middle drum≥3000 下筒 lower drum≥4000		≤10	≤5.5	3	1465	1565	2459	2100

YCP系列永磁盘式磁选机
Disk Type Permanent-magnetic Separator Series YCP



概述 Brief

YCP系列产品主要对磁性铁尾矿含铁物料的回收，陶瓷浆料的除铁，以及四氧化三铁共生矿体的分选。该机直接安装在尾矿流槽上，作为粗选设备，它可将尾矿中的含铁品位降低6-8个百分点，它选出的产品再经过一次磨矿和低磁场磁选机的分选，精矿品位可达65%以上。

该系列盘片间磁场强度分布均匀，有利于捕捉大流量高流速，低浓度，低品位的含铁磁化物资的料浆。节能省电，结构简单，运行可靠，操作维修简便。

Series YCP is mainly used for recovering iron-containing materials from magnetic iron tailing, removing iron from ceramic slurry and separating iron oxide intergrown ore. The machine is directly installed on the tailing launder as the rough separation equipment, which can reduce the iron content in tailing by 6~8 percentage points. After the following ore grinding and the separating by low magnetic field, the ore concentrate condition can up to 65% or more

This series has well-distributed magnetic induction among the disk, which is helpful to catch and hold the slurry that features large flow, high speed, low concentration and low grading. This series has the property of energy & electricity economized, simple structure, reliable running and convenient in operation and maintenance.

工作原理 Working Principle

当电机带动浸入料浆的磁盘体转动后，料浆中的铁磁物质立即被吸附到磁盘的两侧，磁性物料随磁盘的转动被刮板和压力水将物料冲到卸料槽至精矿槽内，流入下道工序，以此反复形成磁选全过程。

After the disk that feeds the slurry is rotated by the motor, the iron magnetic material in the slurry will be immediately attracted onto the two side of the disk. With the rotating of the disk, the magnetic material will be flushed into the discharging trough and then the ore concentrate trough, and then step into the next working procedure, so repeatly to form the whole operation procedure.

规格与型号 Specification and Model

型号 model	磁感应强度 magnetic conduction intensity (mT)	磁盘直径 disk diameter (mm)	磁盘数量 disk number (个)	工作面积 working surface (m²)	转速 rotate speed (r/min)	电机功率 motor power (kW)	给矿浓度 ore concentration (%)	给矿流速 ore flow speed (m/s)	给矿流量 ore flow (/n · m)	回收品位 recovery grading (%)	生产能力 production capacity (t/h)
YCP90-6	130-150	900	6	6.79	2.84	1.1	5-20	0.6-1	300-600	26-27	2-3
YCP120-6		1200	6	12.72	2.84	1.1			500-900		3-5
YCP120-8		1200	8	16.96	2.84	2.2			700-1200		4-6
YCP150-8		1500	8	25.73	1.92	4			1000-1800		5-7
YCP200-8		2000	8	49.75	1.92	5.5			2000-3500		10-12
YCP200-10		2000	10	62.19	1.92	5.5			3000-4300		12-15

超强磁永磁轮式磁选机
Super-strong Permanent-magnetic Wheel Type Magnetic Separator

技术特点 Technical Features

分选磁场高（1.4T-2.1T），比磁力大
入选粒度范围宽（0.043-60mm），分选效率高
磁辊无磨损，磁性能稳定,可使用10年以上
运行费用低，每小时功耗不足1.5kW，节能效果显著
全密封设计，低噪音，无污染
操作简单，维修极少

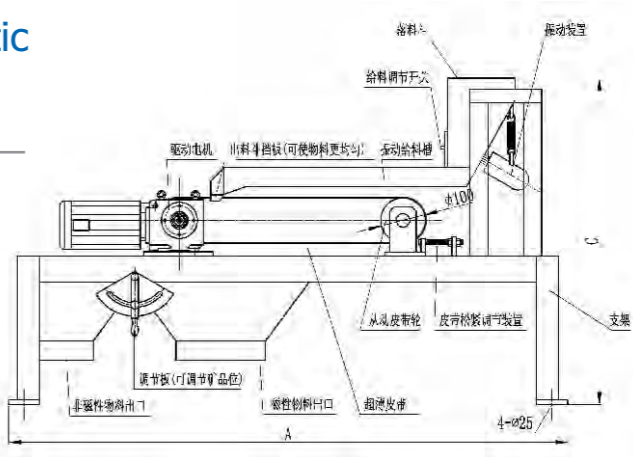

High Separation Magnetic induction, which is bigger than magnetic force
Wide separation granularity range and high separation efficiency
The magneic roll has stable magnetic performance and free from abrasion, which can serve more than ten years.
Low operating cost with not more than 1.5kW power consumption per hour, so the energy saving effect is obvious.
All sealed design, little noises and no pollution.
Simple operation and few maintenance.

主要技术参数 Main Technical Data

参数值 data 规格型号 model	场强 magnetic induction (T)	功率 power (kW)	处理量 handling capacity (t)	入选粒度 separation granularity (mm)	转速 rotate speed (r/min)	外形尺寸 overall dimension (m)	重量 mass (kg)
YG2-10100QC/1	1.2~2.0	0.5	0.5~5	0.043~3	0~400	1.8×1.4×1.1	350
YG2-10100QC/2		1.0		0.043~3		1.8×1.4×1.5	480
YG2-10100QC/3		1.5		0.043~3		1.8×1.4×1.9	630
YG2-10100QC/1	1.2~2.2	0.7	1~6	0.043~60	0~300	2.2×1.4×1.4	540
YG2-10100QC/2		1.5		0.043~60		2.2×1.4×1.9	730
YG2-10100QC/3		2.5		0.043~60		2.2×1.4×2.3	980

CTB（N、S）永磁湿式筒式磁选机
Drum type Wet Permanent-magnetic
Separator Series CTB(N, S)



概 述 Brief

CT系列永磁筒式磁选机适用于粒度3mm以下的磁铁矿、磁黄铁矿、焙烧矿、钛铁矿等物料的湿式磁选，也用于煤、非金属矿、建材等物料的除铁作业，以及选煤作业中的磁重介质回收。

Series CT is suitable for removing iron such as magnetic iron ore, magnetic iron pyrites, roasted ore and ilmenite smaller than 3 mm and can also be used in coal, non-metal ore, building industry and so on, and recovering magnetic medium in the coal washing job.

特 点 Features

- 1. 磁系采用优质铁氧体材料或与稀土磁钢复合而成
- 2. 筒表平均磁感应强度范围为100～600mT
- 3. 根据用户需要，可提供顺流、半逆流、逆流型及双筒磁选机
- 4. 结构简单, 处理量大, 操作方便, 易于维护

- 1. The magnetic system adopts quality ferrite material or a combination of ferrite and rare earth steel.
- 2. The average magnetic induction of the drum surface is about 100 ~ 600 mT.
- 3. Cocurrent tank, self-leveling counter rotation tank, counter-rotation tank or double-drum type can be available.
- 4. Simple structure, large handling capacity, convenient operation and easy maintenance.

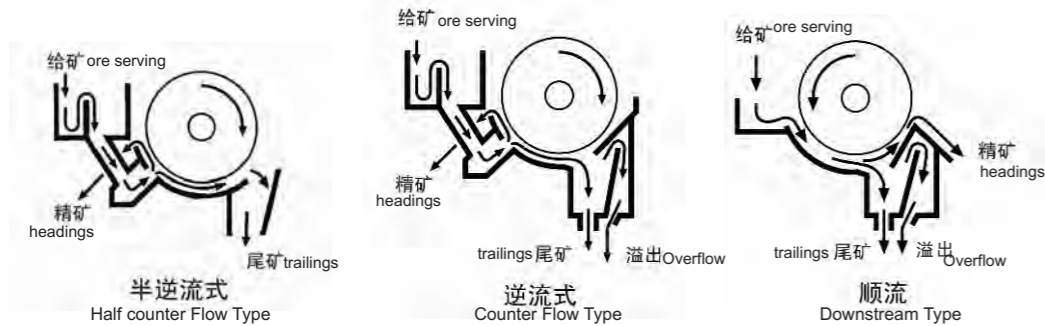

选型指南 Guide for Model Selection

- 1. 筒表磁感应强度不小于135mT的磁选机，通常用于精选段；不小于160mT的磁选机用于粗选段。
- 2. 下表处理能力的两组数值，前者为选矿厂选别磁铁矿（上限值）或焙烧赤铁矿（下限值）的能力（按给矿粒度小于1mm，浓度不大于35％）。处理其它矿石时，可在上、下限之间取。后者（以矿浆体积计）为洗煤厂处理磁铁矿悬浮液时的最大处理能力。

- 3. 槽体型式选择
 - 3.1 顺流型: 收得率较高，但品位较低。适宜于选别粒度不大于6mm；
 - 3.2 半逆流型：收得率、品位均适中。适宜于选别粒度不大于1mm；
 - 3.3 逆流型：收得率较低、品位较高。适宜于选别粒度不大于0.6mm；
- 4. 当采用双筒或多筒时，水平布置处理量大；垂直布置可在一台设备上连续完成矿物的粗选、精选或扫选两次选别，简化了流程。

- 1. The magnetic induction of the drum surface shall be more than 135mT, generally for fine-picking section; more than 160mT for rough-picking section.
- 2. See the two groups of values as follows: the former is the capacity for mineral processing plant to separate ore (max) or to hematite-roasting (min) (ore is less than 1mm with a concentration no more than 35%). When deal with other ores, choose a value between max and min; the latter is max capacity of coal separation plant to deal with ore suspension liquid (calculate by volume of the slurry).
- 3. Groove type selection
 - 3.1 Cocurrent tank: high yield but low grade, suitable for a material less than 6 mm;
 - 3.2 Self-leveling counter rotation tank: moderate yield and grade, suitable for a material less than 1mm;
 - 3.3 Counter-rotation tank: low yield but high grade, suitable for a material less than 0.6 mm;
- 4. When double-drum or multi-drum is put into operation, the dealing capacity is larger in horizontal arrangement. While in vertical arrangement, rough selection, fine or scavenging selection will be finished continuously at single equipment. So the processes get simplified.

主要技术参数 Main Technical Data

型 号 model	筒径 drum diameter (mm)	筒长 drum length (mm)	筒表磁场 surface magnetic field (mT)	选别粒度 separation granularity (mm)	处理能力 handling capacity		电机功率 motor power (kW)	质量 mass (t)
					T/h	m³/h		
CTB(S. N)-63	600	300	80~400	3~0	2~4	5	0.55	0.4
CTB(S. N)-66	600	600	80~400	3~0	4~8	10	2.2	0.95
CTB(S. N)-69	600	900	80~400	3~0	7~14	20	2.2	1.3
CTB(S. N)-612	600	1200	80~400	3~0	10~20	30	2.2	1.5
CTB(S. N)-618	600	1800	80~400	3~0	15~30	48	2.2	1.8
CTB(S. N)-712	750	1200	120~400	3~0	15~30	48	1.6	2.0
CTB(S. N)-715	750	1500	120~400	3~0	20~40	60	3.0	2.2
CTB(S. N)-718	750	1800	120~400	3~0	20~45	72	3.0	2.5
CTB(S. N)-724	750	2400	140~400	3~0	30~65	90	3.0	2.8
CTB(S. N)-1018	1050	1800	140~400	6~0	50~80	120	4.0	3.6
CTB(S. N)-1021	1050	2100	140~400	6~0	60~100	140	5.5	4.2
CTB(S. N)-1024	1050	2400	140~400	6~0	80~120	160	5.5	4.6
CTB(S. N)-1218	1200	1800	160~400	6~0	80~140	140	5.5	4.8
CTB(S. N)-1224	1200	2400	160~400	6~0	100~190	192	7.5	6.1
CTB(S. N)-1230	1200	3000	160~400	6~0	130~240	240	7.5	7.0
2CTB(S. N)-1030	2×1050	3000	150~400	6~0	130~200	190	2×7.5	11.2

多功能电磁分离器

Multi-function Electromagnetic Separator

本公司专利产品，又名为涡电流分选设备（有色金属分离机），广泛应用于从工厂的切削屑和城市垃圾中、电子废弃物回收处理生产线中高效地分离铁磁性物质和铝、铜等非铁磁性金属及合金。铝、铜等非铁磁金属的回收率在85%以上，大大提高了钢铁和有色金属等废料的利用率。

涡电流分选设备是一种回收有色金属的有效设备，可使一些有色金属从混合废物流中分离出来。在分离装置的皮带上下设置两个直线感应器，在此感应器中由三相交流电在其绕组中产生一交变的直线移动的磁场，此磁场的方向与输送机皮带的运动方向垂直，保证足够大的电磁力把废物中的有色金属推入带侧的集料斗。主要由：振动给料、偏心磁极系统、磁极强度和变化控制系统、下料分隔控制等组成。

This is our patent product, also called eddy current separator (separator for non-ferrous metal), which has been widely used for effectively removing iron material from non-magnetic metals (such as aluminum, copper) and alloy at production line in cutting chipps, garbage, and electronic waste with a recovery up to 85%, which greatly improved the utilization rate of steel and non-ferrous waste.

Eddy current separator is used for recovering non-ferrous metal, which can separate non-ferrous metal from mixed scraps. Two linear inductors have been set at upper and lower of the belt, which can produce a movable alternating magnetic field at windings made by 3-phase with the trend vertical to that of belt. And thus ensure a strong enough magnetic force to put the metal into collecting box. This separator composes of vibration feeder, partial magnetic pole system, magnetic pole intensity, change control system, feeding separation control and so on.

主要技术参数 Main Technical Data

振动给料带工作宽度 The width of vibration feeding belt: 800mm

振动给料带工作长度 The length of vibration feeding belt: 1500mm

振动给料功率 Vibration feeding power: 4kW

交变磁场最高频率 Max. frequency of alternating field: 50~460 Hz（可调 adjustable）

传送带功率 Power of Conveyer belt: 1.5 kW

转子功率 Rotor power: 4.0 kW

磁辊尺寸 Size of magnetic roll: Φ320 × 500 mm

偏心磁极转速 Rotary speed of eccentric magnetic pole: 800 r/min

磁极个数 Number of magnetic pole: 20

给料尺寸 Feeding size: ≤50 mm

处理量 Handling capacity: 2.5t/h

外型尺寸 Overall dimension: 3000 x 1660 x 1800 mm

总重量 Total weight: （约about）2500 kg



MCF系列振动式电磁分离器

Vibration Electromagnetic Separator Series MCF

工作原理：当励磁线圈通往直流电后，在筛网四周形成磁场区。当被处理原料通过筛网时，含混在原料中的铁磁性杂质则被吸附在网板上，原料在振动电机的作用下，顺利通过筛网而达到除铁目的。

该磁分离器适用于粉末状或粒度小于3mm的干性物料。

Working principle: when excitation coil gets DC, a magnetic field zone is produced around the sieve. When the processed material passes through it, iron magnet will be attracted and under the action of vibration motor to attain the aim of removing iron by passing through the sieve.

This separator is suitable for dry material less than 3 mm.

主要技术参数

Main Technical Data

型号 model	项目 item	工作口径 working iameter (mm)	物料运动速度 material running speed (m/s)	最大处理能力 Max. handling capacity (kg/h)	励磁功率 excitation power (kW)	工作制 duty cycle	物料粒度 material granularity	重量 mass (kg)
MCF-150		150	1.5	3000	0.67	连续 continuous	3mm以下	300
MCF-250		250	1.5	8000	1.4	连续 continuous	3mm以下	450
MCF-350		350	1.5	11000	1.7	连续 continuous	3mm以下	550

SBT系列脱磁器
Demagnetizer Series SBT

脱磁器是分段磁选流程中常用的辅助设备，在一段磁选之后设置脱磁器能有效地打破磁性矿物的团聚现象，提高二次分级效率。

脱磁器由五个不同外径，不同长度的同轴圆线圈串联而成，矿浆流经线圈中央的钢管而达到脱磁目的。矿浆在激磁线圈产生的沿轴向磁场强度逐渐减弱的交变磁场作用下，进行了正反向的反复磁化，强磁性矿粒的剩余磁化强度或剩余磁感应强度逐渐减弱，直至完全失去剩磁，矿粒完成脱磁过程。

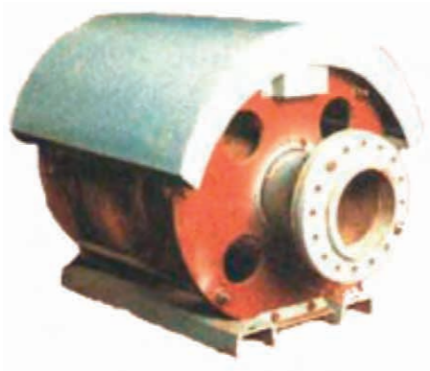

Demagnetizer is a common auxiliary equipment to avoid reunited phenomena and thus improve 2nd grade efficiency to be used after the first separation.

It is composed of five serial round-shaped coaxial coils but in different outer diameters and lengths and when the slurry passes through the central steel tube the aim of demagnetizing reaches. Under the action of wear-off alternating magnetic field along the trend of axial produced by excitation coils, the ore slurry gets magnetized obverse-to-reverse repeatedly, both of remain magnetization and induction are wearing off till no magnetism left, then a full course of demagnetization has finished.

主要技术参数 Main Technical Data

型号 model	项目 item	公称通径 nominal diameter (mm)	轴向最大场强 max.magnetic induction in axial (mT)	工作电压 working voltage (V)	额定电流 rated current (A)	交流功率 AC power (kVA)	处理量 handling capacity (m3/h)	重量 mass (kg)	备注 remark
SBT-50		50	80	220	9	2	25	80	普通型 general type
SBT-75		75	50	220	10	2.2	45	100	普通型 general type
SBT-100		100	50	220	12	2.7	60	150	普通型 general type
SBT-150		150	50	380	14~16	5.5	130	220	普通型 general type
SBT-200		200	50	380	14~16	<6.1	230	320	节能型 energy-economized type
SBT-250		250	50	380	15~18	<6.5	350	440	节能型 energy-economized type
SBT-300		300	50	380	15~20	<7.5	400	560	节能型 energy-economized type